



Barrier Point

© WCEC ARCHITECTS - DISCLAIMER
This drawing is copyright and shall not be reproduced or used for any other purpose without the written permission of the Architects.
It is the contractors responsibility to ensure full compliance with the Building Regulations.
Do not scale from this drawing, use figured dimensions only.
It is the contractors responsibility to check and verify all dimensions on site.
Any discrepancies to be reported immediately.
IF IN DOUBT ASK.
Materials not in conformity with relevant British or European Standards/Codes of practice or materials known to be deleterious to health & safety must not be used or specified on this project.
Materials known to contain asbestos contaminated materials (ACM's) in the manufacture or installation process have not been specified and must not be used on this project



- Balconies / External Amenity Space
- Balcony/External Terrace Space
- Front garden replacing stairwell

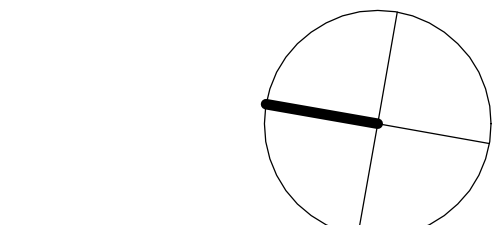

P2	08/04/14	Bin stores and cycle storage provisions amended to LHDG, apartments amended, risers and stairs rationalised, secure by design requirements implemented, external amenity spaced amended to LHDG	
Rev	Date	Description	By



PROJECT
Royal Wharf,
Development Phase 1

TITLE
Plot 06 Ground Floor Plan

DRAWING STATUS			
PLANNING APPROVAL			
DRAWN	MB	CHECKED	MB
SCALE	1-250 @ A1 / 1-500 @ A3		
DATE	08/04/14		

wcecarchitects

4th Floor, South Building, Staple Inn Buildings,
High Holborn, London, WC1V 7PZ
Carnwood Court, Carnwood Road,
Sheepbridge, Chesterfield, S41 9QB

t: 020 3388 0019, e: email@wcec.co.uk, www.wcec.co.uk

JOB NO.	DRAWING NO.	REV
13-500	DPA-06-100	P2

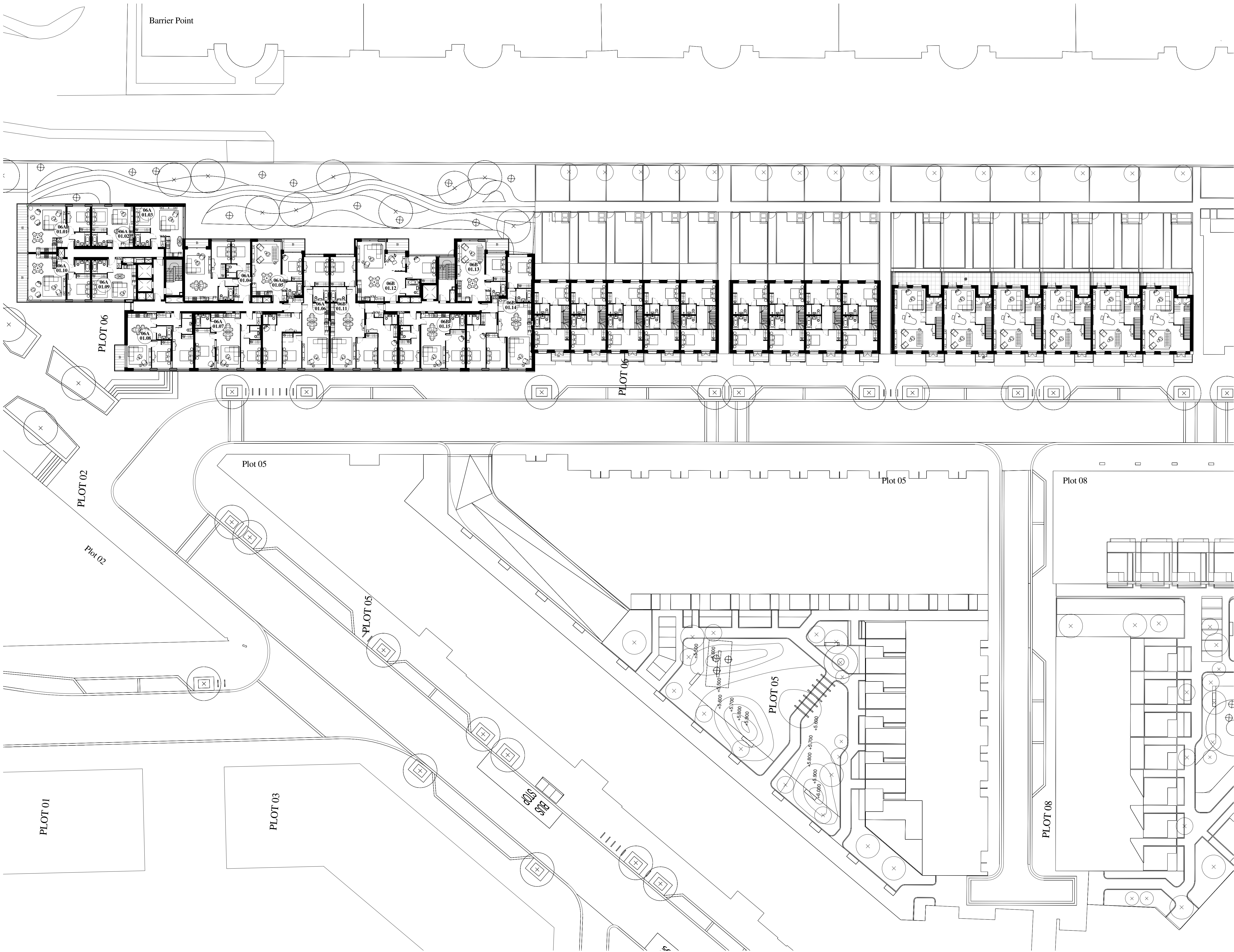

© WCEC ARCHITECTS - DISCLAIMER

This drawing is copyright and shall not be reproduced or used for any other purpose without the written permission of the Architects.

This drawing must be read in conjunction with all other related drawings and documentation.

It is the contractors responsibility to ensure full compliance with the Building Regulations.

Do not scale from this drawing, use figured dimensions only.

It is the contractors responsibility to check and verify all dimensions on site.

Any discrepancies to be reported immediately.

IF IN DOUBT ASK.

Materials not in conformity with relevant British or European Standards/Codes of practice or materials known to be deleterious to health & safety must not be used or specified on this project.

Materials known to contain asbestos contaminated materials (ACM's) in the manufacture or installation process have not been specified and must not be used on this project



Balconies / External Amenity Space

Balcony/External Terrace Space

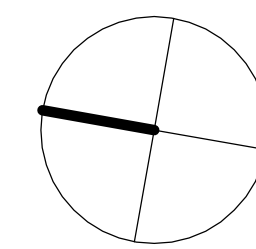

P2	08/04/14	Bin stores and cycle storage provisions amended to LHDG, apartments amended, risers and stairs rationalised, secure by design requirements implemented, external amenity spaced amended to LHDG	
Rev	Date	Description	By



PROJECT
Royal Wharf,
Development Phase 1

TITLE
Plot 06 First floor Plan

DRAWING STATUS
PLANNING APPROVAL

DRAWN	MB	CHECKED	MB
-------	----	---------	----

SCALE 1-250 @ A1 / 1-500 @ A3

DATE 08/04/14

wcecarchitects

4th Floor, South Building, Staple Inn Buildings,
High Holborn, London, WC1V 7PZ

Carnwood Court, Carnwood Road,
Sheepbridge, Chesterfield, S41 9QB

t: 020 3388 0019, e: email@wcec.co.uk, www.wcec.co.uk

JOB NO. 13-500	DRAWING NO. DPA-06-101	REV P2
-------------------	---------------------------	-----------

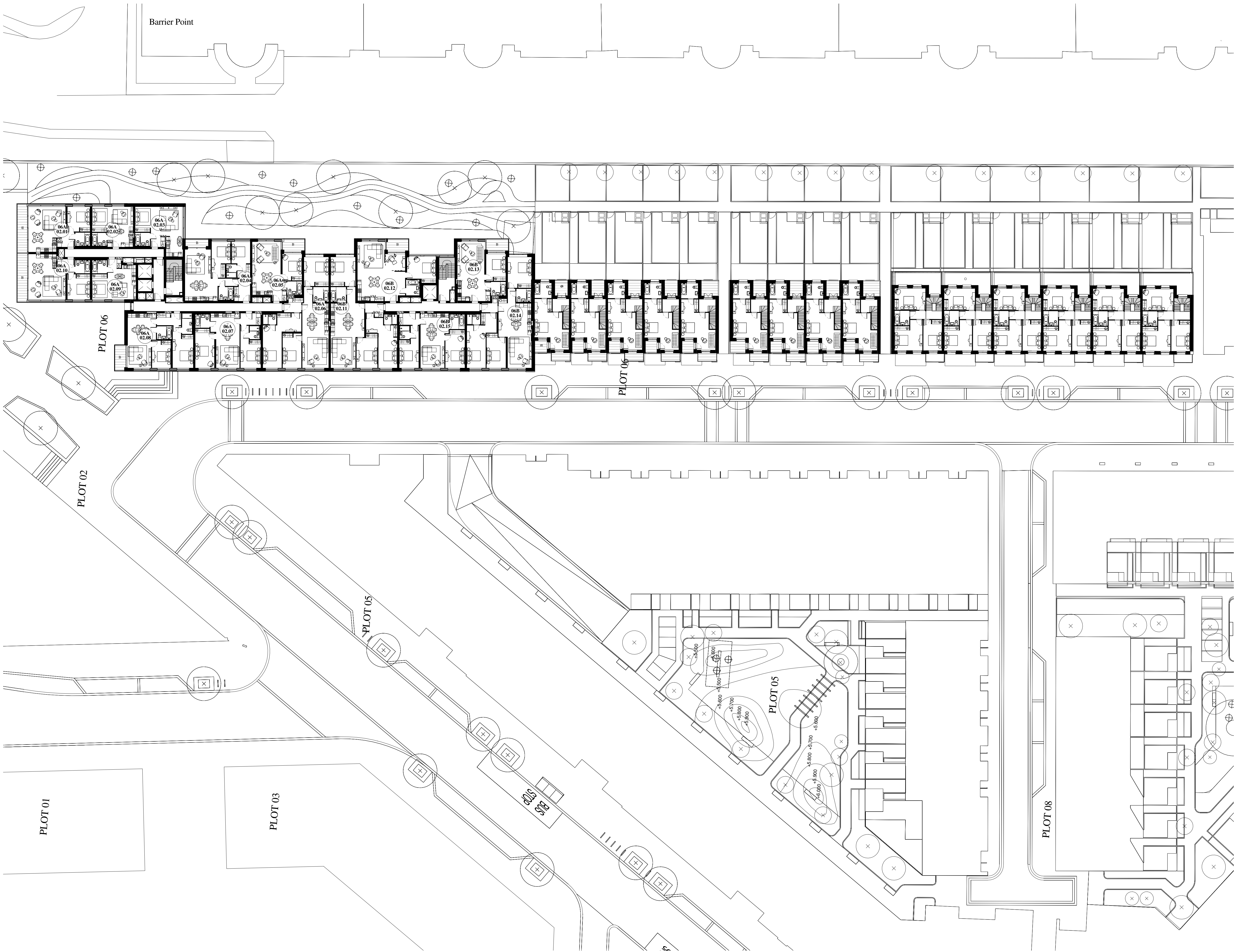

© WCEC ARCHITECTS - DISCLAIMER

This drawing is copyright and shall not be reproduced or used for any other purpose without the written permission of the Architects.

This drawing must be read in conjunction with all other related drawings and documentation.

It is the contractors responsibility to ensure full compliance with the Building Regulations.

Do not scale from this drawing, use figured dimensions only.

It is the contractors responsibility to check and verify all dimensions on site.

Any discrepancies to be reported immediately.

IF IN DOUBT ASK.

Materials not in conformity with relevant British or European Standards/Codes of practice or materials known to be deleterious to health & safety must not be used or specified on this project.

Materials known to contain asbestos contaminated materials (ACM's) in the manufacture or installation process have not been specified and must not be used on this project



Balconies / External Amenity Space

Balcony/External Terrace Space

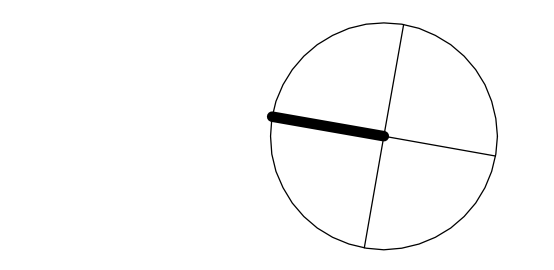

P2	08/04/14	Bin stores and cycle storage provisions amended to LHDG, apartments amended, risers and stairs rationalised, secure by design requirements implemented, external amenity spaced amended to LHDG	
Rev	Date	Description	By



PROJECT
Royal Wharf,
Development Phase 1

TITLE
Plot 06 Second floor plan

DRAWING STATUS
PLANNING APPROVAL

DRAWN	MB	CHECKED	MB
-------	----	---------	----

SCALE 1-250 @ A1 / 1-500 @ A3

DATE 08/04/14

wcecarchitects

4th Floor, South Building, Staple Inn Buildings,
High Holborn, London, WC1V 7PZ

Canwood Court, Canwood Road,
Sheepbridge, Chesterfield, S41 9QB

t: 020 3388 0019, e: email@wcec.co.uk, www.wcec.co.uk

JOB NO.	DRAWING NO.	REV
13-500	DPA-06-102	P2

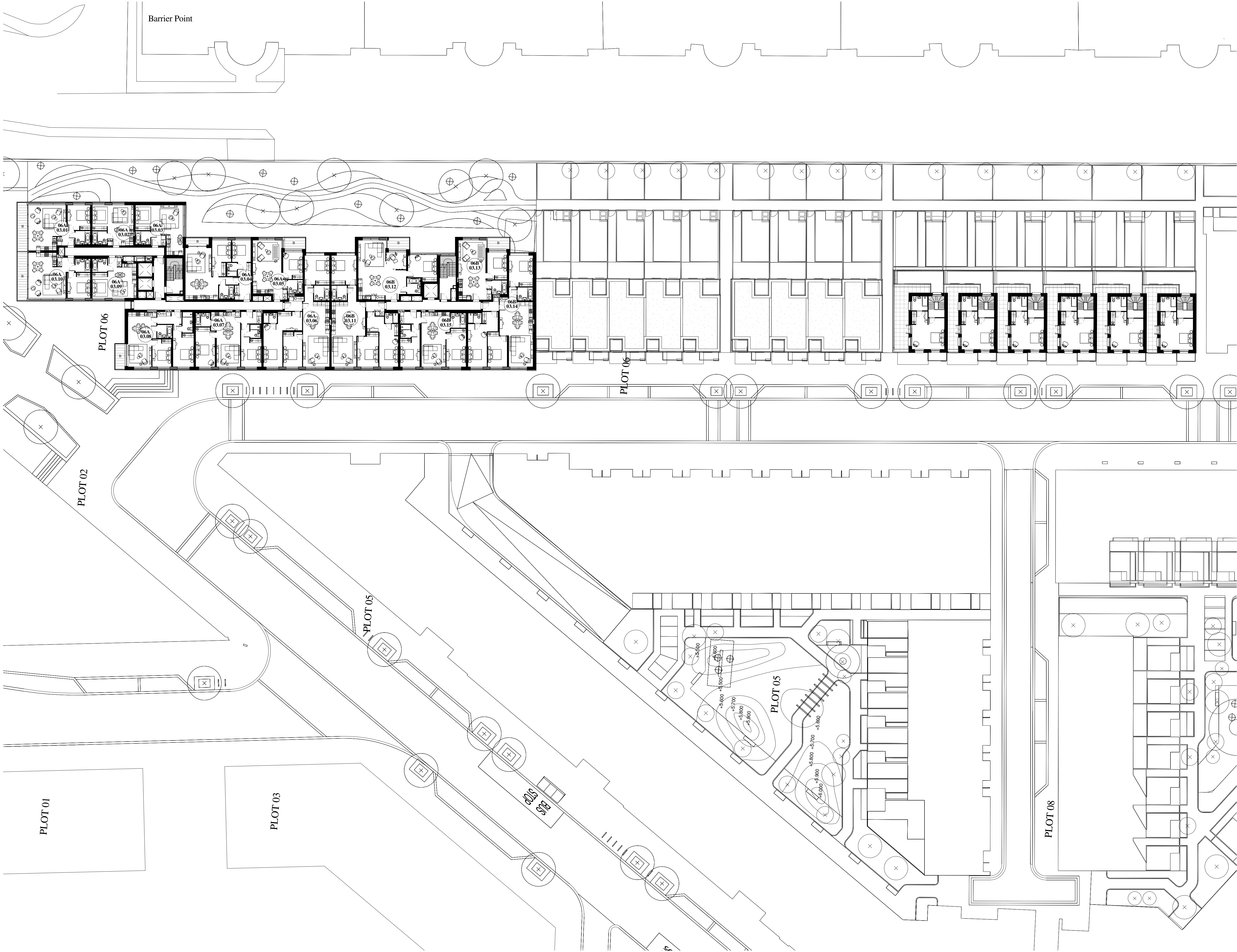

Barrier Point

© WCEC ARCHITECTS - DISCLAIMER
This drawing is copyright and shall not be reproduced or used for any other purpose without the written permission of the Architects.
This drawing must be read in conjunction with all other related drawings and documentation.
It is the contractors responsibility to ensure full compliance with the Building Regulations.
Do not scale from this drawing, use figured dimensions only.
It is the contractors responsibility to check and verify all dimensions on site.
Any discrepancies to be reported immediately.
IF IN DOUBT ASK.
Materials not in conformity with relevant British or European Standards/Codes of practice or materials known to be deleterious to health & safety must not be used or specified on this project.
Materials known to contain asbestos contaminated materials (ACM's) in the manufacture or installation process have not been specified and must not be used on this project



Balconies /
External Amenity
Space

Balcony/External
Terrace Space

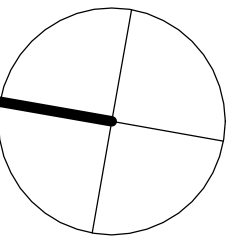

P2	08/04/14	Bin stores and cycle storage provisions amended to LHDG, apartments amended, risers and stairs rationalised, secure by design requirements implemented, external amenity spaced amended to LHDG	
Rev	Date	Description	By



PROJECT
Royal Wharf,
Development Phase 1

TITLE
Plot 06 Third Floor Plan

DRAWING STATUS
PLANNING APPROVAL

DRAWN	MB	CHECKED	MB
SCALE	1-250 @ A1 / 1-500 @ A3		
DATE	08/04/14		

wcecarchitects

4th Floor, South Building, Staple Inn Buildings,
High Holborn, London, WC1V 7PZ

Carnwood Court, Carnwood Road,
Sheepbridge, Chesterfield, S41 9QB

t: 020 3388 0019, e: email@wcec.co.uk, www.wcec.co.uk

JOB NO.	DRAWING NO.	REV
13-500	DPA-06-103	P2

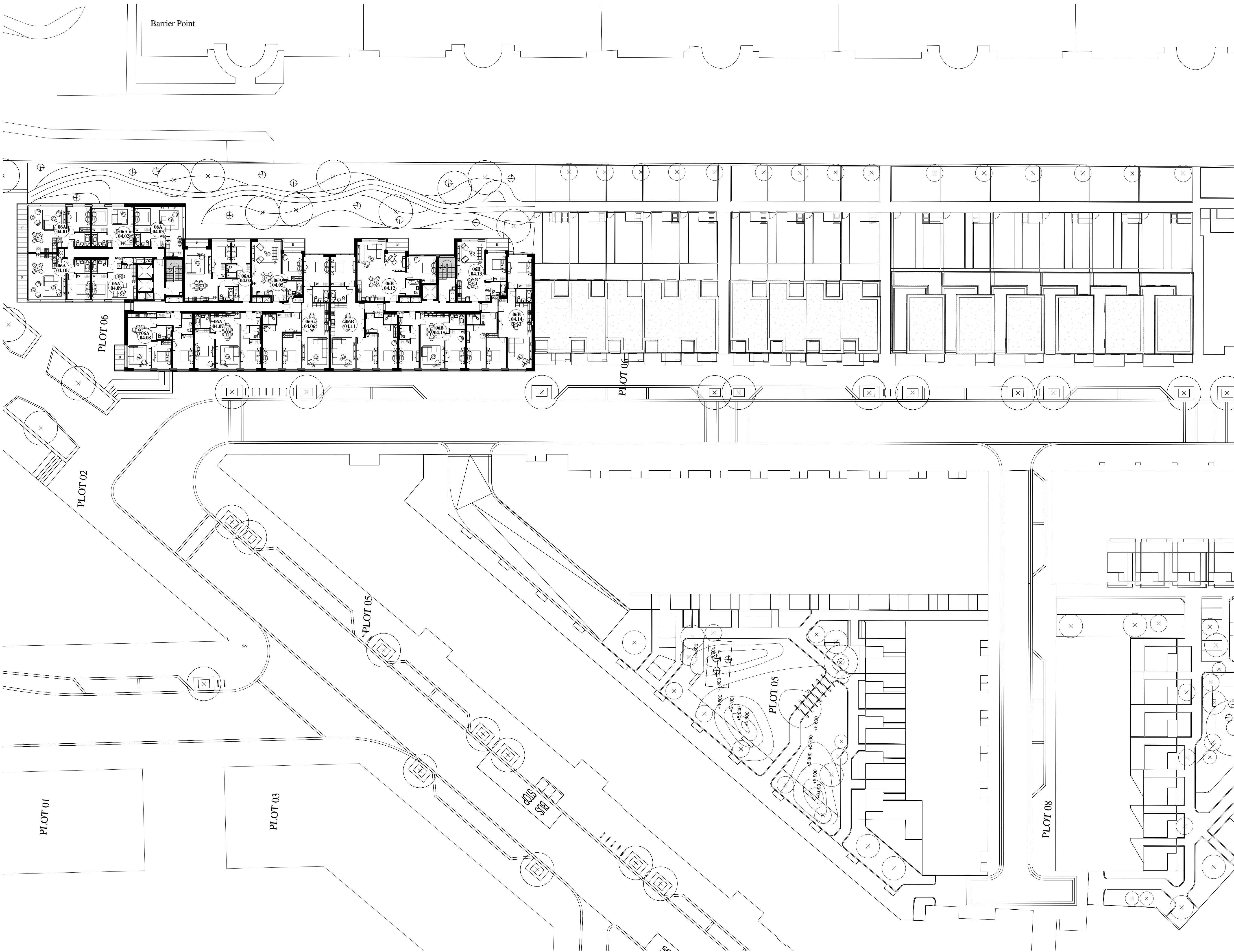

© WCEC ARCHITECTS - DISCLAIMER

This drawing is copyright and shall not be reproduced or used for any other purpose without the written permission of the Architects. This drawing must be read in conjunction with all other related drawings and documentation. It is the contractors responsibility to ensure full compliance with the Building Regulations. Do not scale from this drawing, use figured dimensions only. It is the contractors responsibility to check and verify all dimensions on site. Any discrepancies to be reported immediately. IF IN DOUBT ASK. Materials not in conformity with relevant British or European Standards/Codes of practice or materials known to be deleterious to health & safety must not be used or specified on this project. Materials known to contain asbestos contaminated materials (ACM's) in the manufacture or installation process have not been specified and must not be used on this project

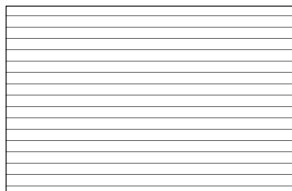

**Balconies / External Amenity Space**

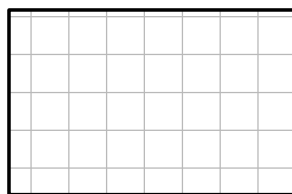
**Balcony/External Terrace Space**

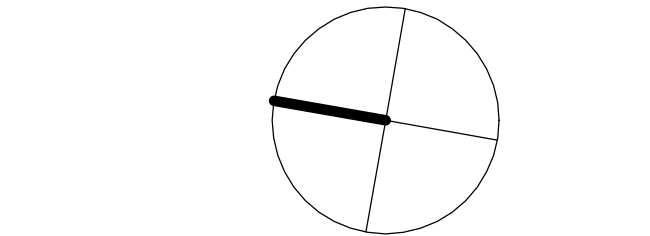

P2	08/04/14	Bin stores and cycle storage provisions amended to LHDG, apartments amended, risers and stairs rationalised, secure by design requirements implemented, external amenity spaced amended to LHDG	
Rev	Date	Description	By



PROJECT
Royal Wharf,
Development Phase 1

TITLE
Plot 06 Fourth Floor Plan

DRAWING STATUS			
PLANNING APPROVAL			
DRAWN	MB	CHECKED	MB
SCALE	1-250 @ A1 / 1-500 @ A3		
DATE	08/04/14		

wcecarchitects

4th Floor, South Building, Staple Inn Buildings,
High Holborn, London, WC1V 7PZ

Canwood Court, Canwood Road,
Sheepbridge, Chesterfield, S41 9QB

JOB NO.	DRAWING NO.	REV
13-500	DPA-06-104	P2



Balcony/External Terrace Space

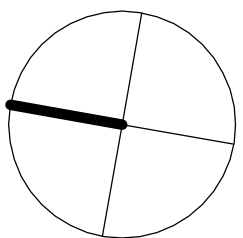

ROYAL WHARF
LONDON

TITLE
Plot 06 Fifth Floor Plan

DRAWING STATUS

PLANNING APPROVAL

DRAWN	MB	CHECKED	MB
-------	----	---------	----

SCALE 1-250 @ A1 / 1-500 @ A3

DATE 08/04/14

wcec architects

4th Floor, South Building, Staple Inn Buildings
High Holborn, London, WC1V 7PZ

Carrwood Court, Carrwood Road,
Sheepbridge, Chesterfield, S41 9QB

t: 020 3388 0019, e: email@wcec.co.uk, www.wcec.co.uk

JOB NO.	DRAWING NO.	REV
13-500	DPA-06-105	P2

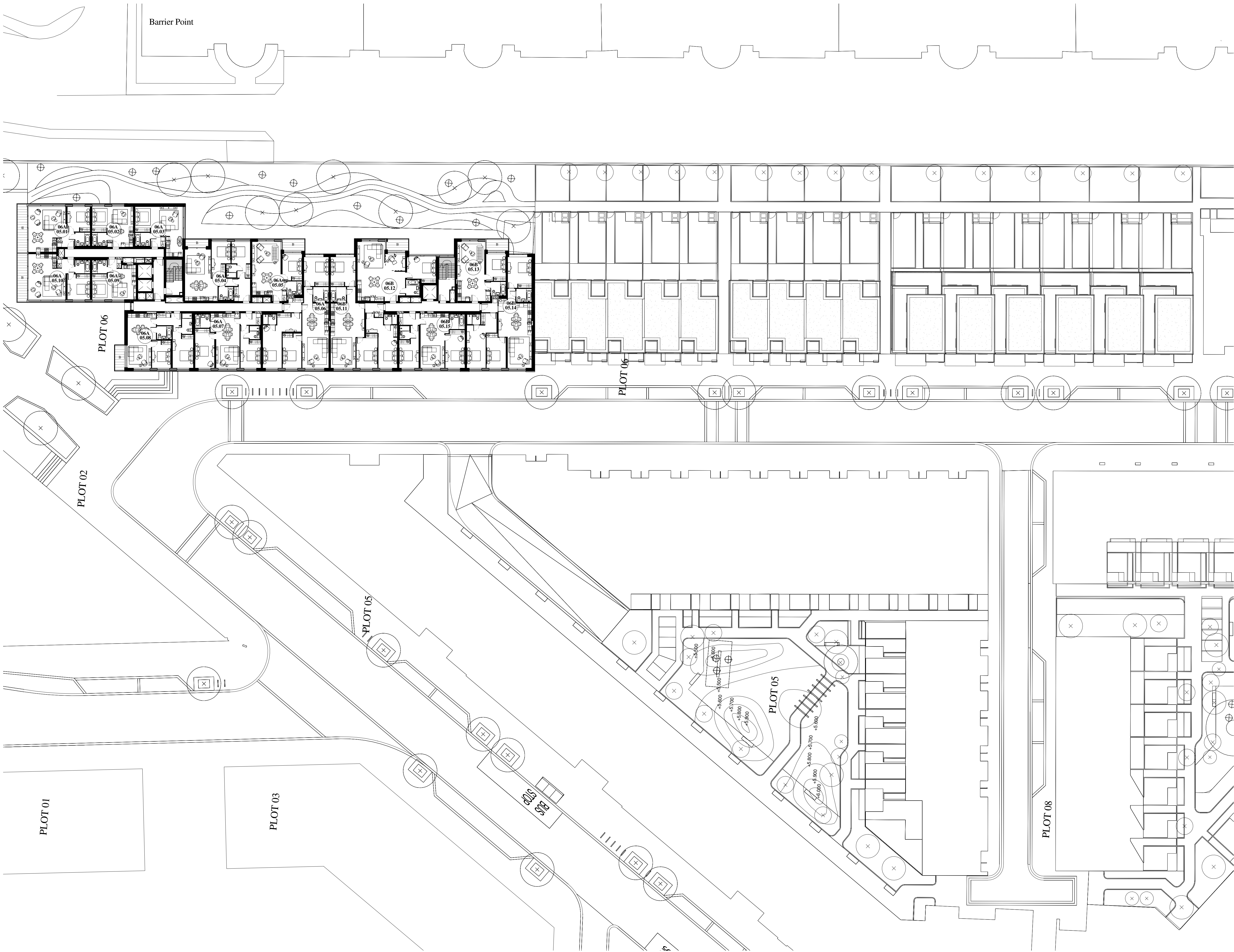

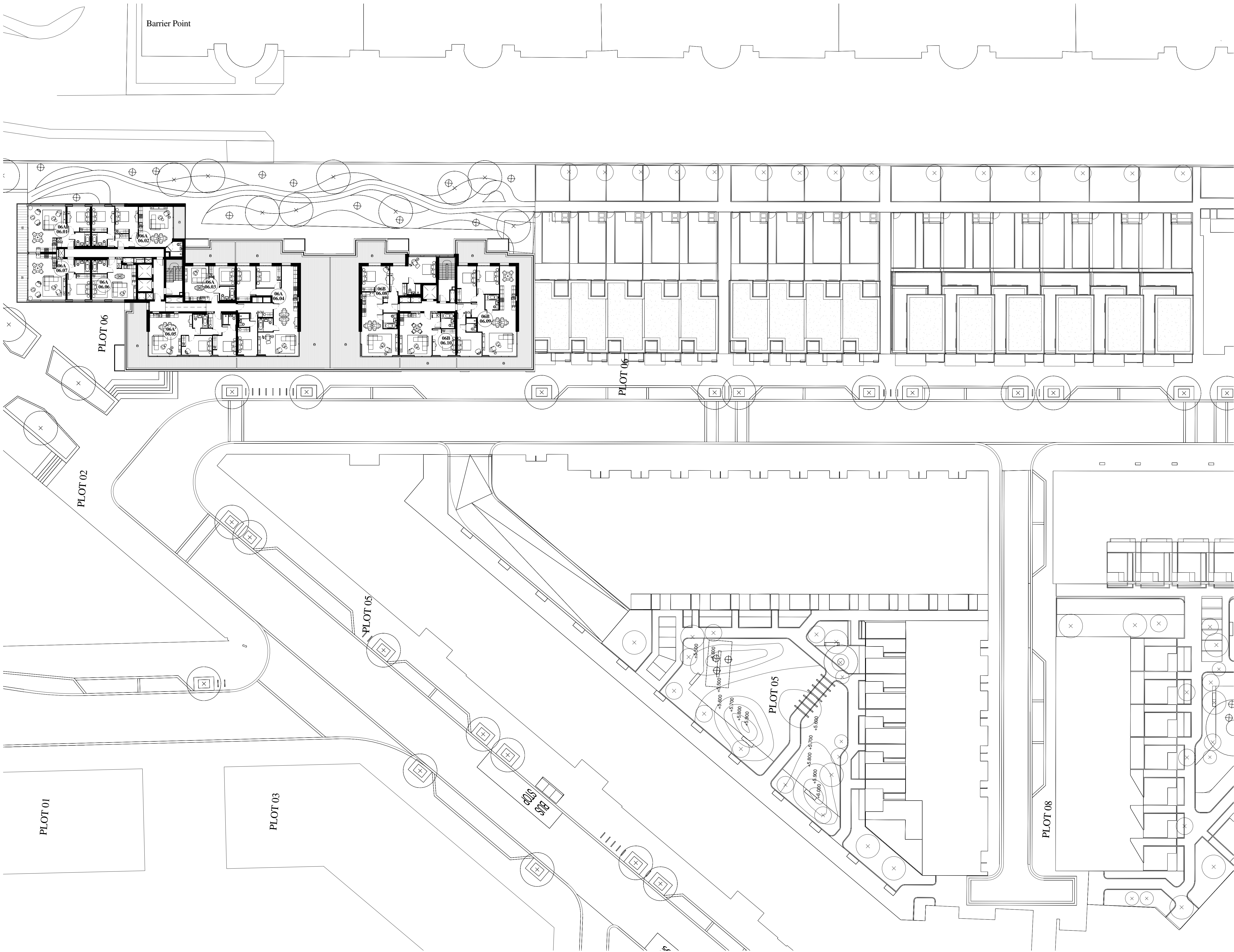

© WCEC ARCHITECTS - DISCLAIMER

This drawing is copyright and shall not be reproduced or used for any other purpose without the written permission of the Architects. This drawing must be read in conjunction with all other related drawings and documentation. It is the contractors responsibility to ensure full compliance with the Building Regulations. Do not scale from this drawing, use figured dimensions only. It is the contractors responsibility to check and verify all dimensions on site. Any discrepancies to be reported immediately. IF IN DOUBT ASK.

Materials not in conformity with relevant British or European Standards/Codes of practice or materials known to be deleterious to health & safety must not be used or specified on this project. Materials known to contain asbestos contaminated materials (ACM's) in the manufacture or installation process have not been specified and must not be used on this project.

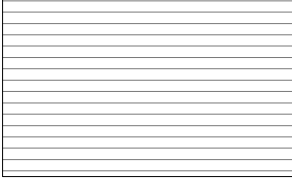
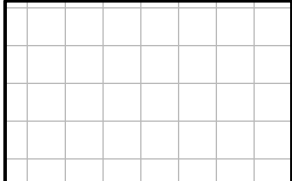

-  Balconies / External Amenity Space
-  Balcony/External Terrace Space

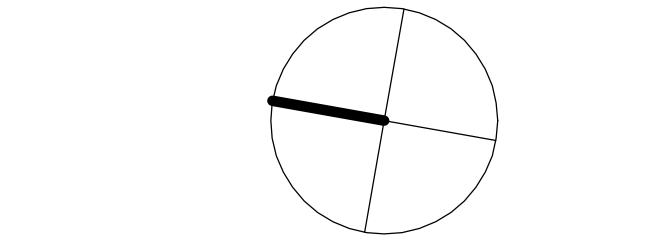

P2	08/04/14	Bin stores and cycle storage provisions amended to LHDG, apartments amended, risers and stairs rationalised, secure by design requirements implemented, external amenity spaced amended to LHDG	
Rev	Date	Description	By



PROJECT
Royal Wharf,
Development Phase 1

TITLE
Plot 06 Sixth Floor Plan

DRAWING STATUS
PLANNING APPROVAL

DRAWN	MB	CHECKED	MB
-------	----	---------	----

SCALE 1-250 @ A1 / 1-500 @ A3

DATE 08/04/14

wcecarchitects

4th Floor, South Building, Staple Inn Buildings,
High Holborn, London, WC1V 7PZ

Camwood Court, Camwood Road,
Sheepbridge, Chesterfield, S41 9QB

t: 020 3388 0019, e: email@wcec.co.uk, www.wcec.co.uk

JOB NO.	DRAWING NO.	REV
13-500	DPA-06-106	P2

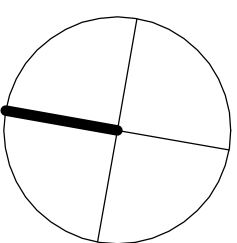

P2	08/04/14	Bin stores and cycle storage provisions amended to LHDG, apartments amended, risers and stairs rationalised, secure by design requirements implemented, external amenity spaced amended to LHDG	
Rev	Date	Description	By



ROYAL WHARF
LONDON

PROJECT
Royal Wharf,
Development Phase 1

TITLE
Plot 06 Seventh Floor Plan

DRAWING STATUS

PLANNING APPROVAL

DRAWN	MB	CHECKED	MB
-------	----	---------	----

SCALE 1-250 @ A1 / 1-500 @ A3

DATE 08/04/14

wcec architects

4th Floor, South Building, Staple Inn Buildings
High Holborn, London, WC1V 7PZ

Carrwood Court, Carrwood Road,
Sheepbridge, Chesterfield, S41 9QJ

t: 020 3388 0019, e: email@wcec.co.uk, www.wcec.co.uk

JOB NO.	DRAWING NO.	REV
13-500	DPA-06-107	P2

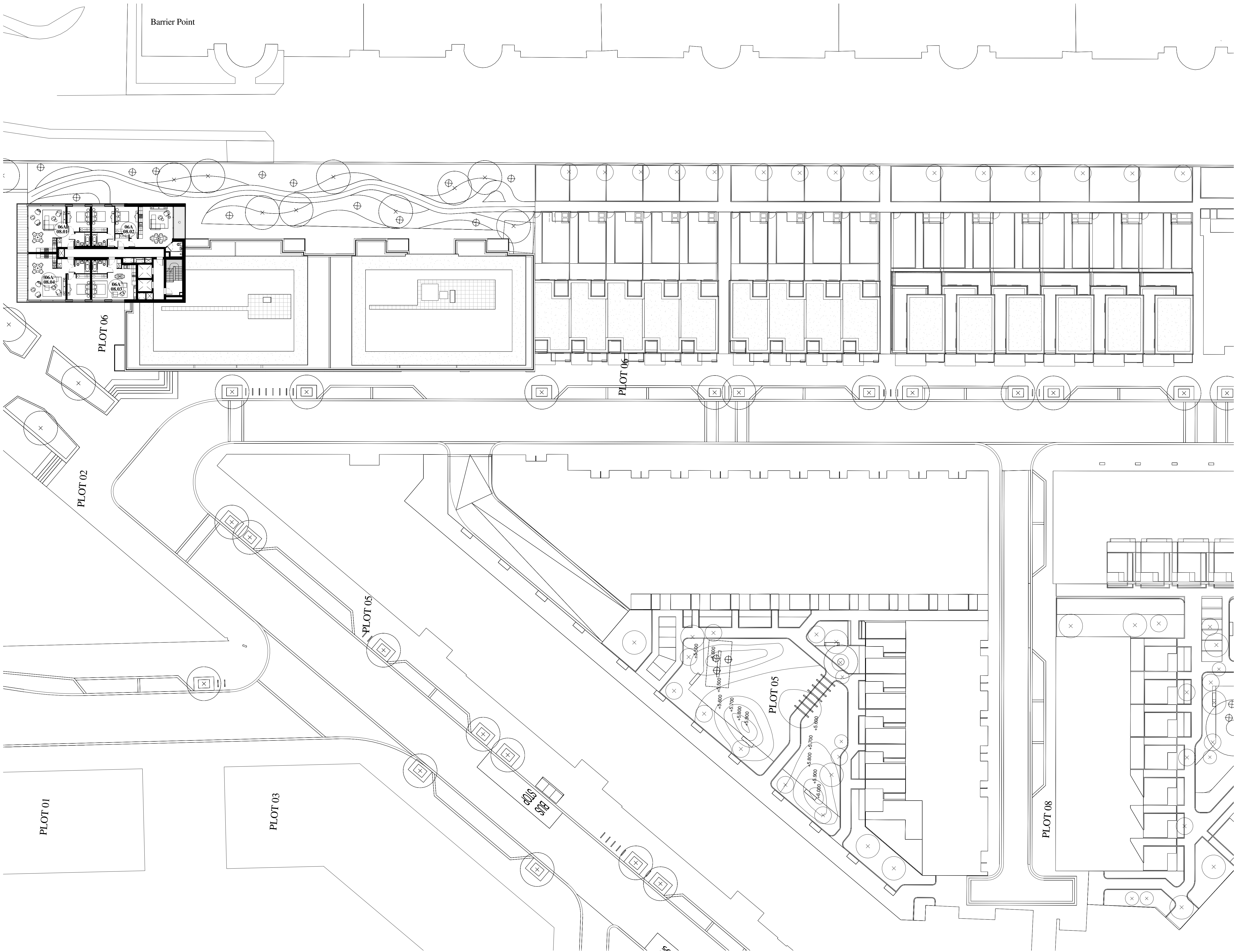

© WCEC ARCHITECTS - DISCLAIMER

This drawing is copyright and shall not be reproduced or used for any other purpose without the written permission of the Architects.

This drawing must be read in conjunction with all other related drawings and documentation.

It is the contractors responsibility to ensure full compliance with the Building Regulations.

Do not scale from this drawing, use figured dimensions only.

It is the contractors responsibility to check and verify all dimensions on site.

Any discrepancies to be reported immediately.

IF IN DOUBT ASK.

Materials not in conformity with relevant British or European Standards/Codes of practice or materials known to be deleterious to health & safety must not be used or specified on this project.

Materials known to contain asbestos contaminated materials (ACM's) in the manufacture or installation process have not been specified and must not be used on this project



- Balconies / External Amenity Space
- Balcony/External Terrace Space

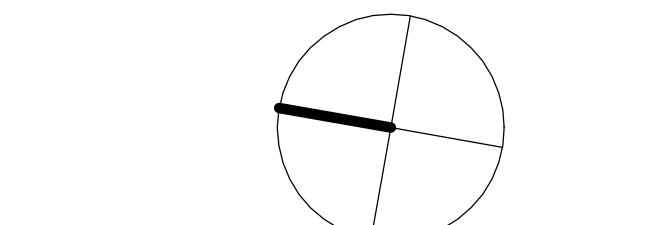

P2	08/04/14	Bin stores and cycle storage provisions amended to LHDG, apartments amended, risers and stairs rationalised, secure by design requirements implemented, external amenity spaced amended to LHDG	
Rev	Date	Description	By



PROJECT
Royal Wharf,
Development Phase 1

TITLE
Plot 06 Eighth Floor Plan

DRAWING STATUS
PLANNING APPROVAL

DRAWN	MB	CHECKED	MB
SCALE	1-250 @ A1 / 1-500 @ A3		
DATE	09/04/14		

wcecarchitects

4th Floor, South Building, Staple Inn Buildings,
High Holborn, London, WC1V 7PZ

Canwood Court, Canwood Road,
Sheepbridge, Chesterfield, S41 9QB

t: 020 3388 0019, e: email@wcec.co.uk, www.wcec.co.uk

JOB NO.	DRAWING NO.	REV
13-500	DPA-06-108	P2

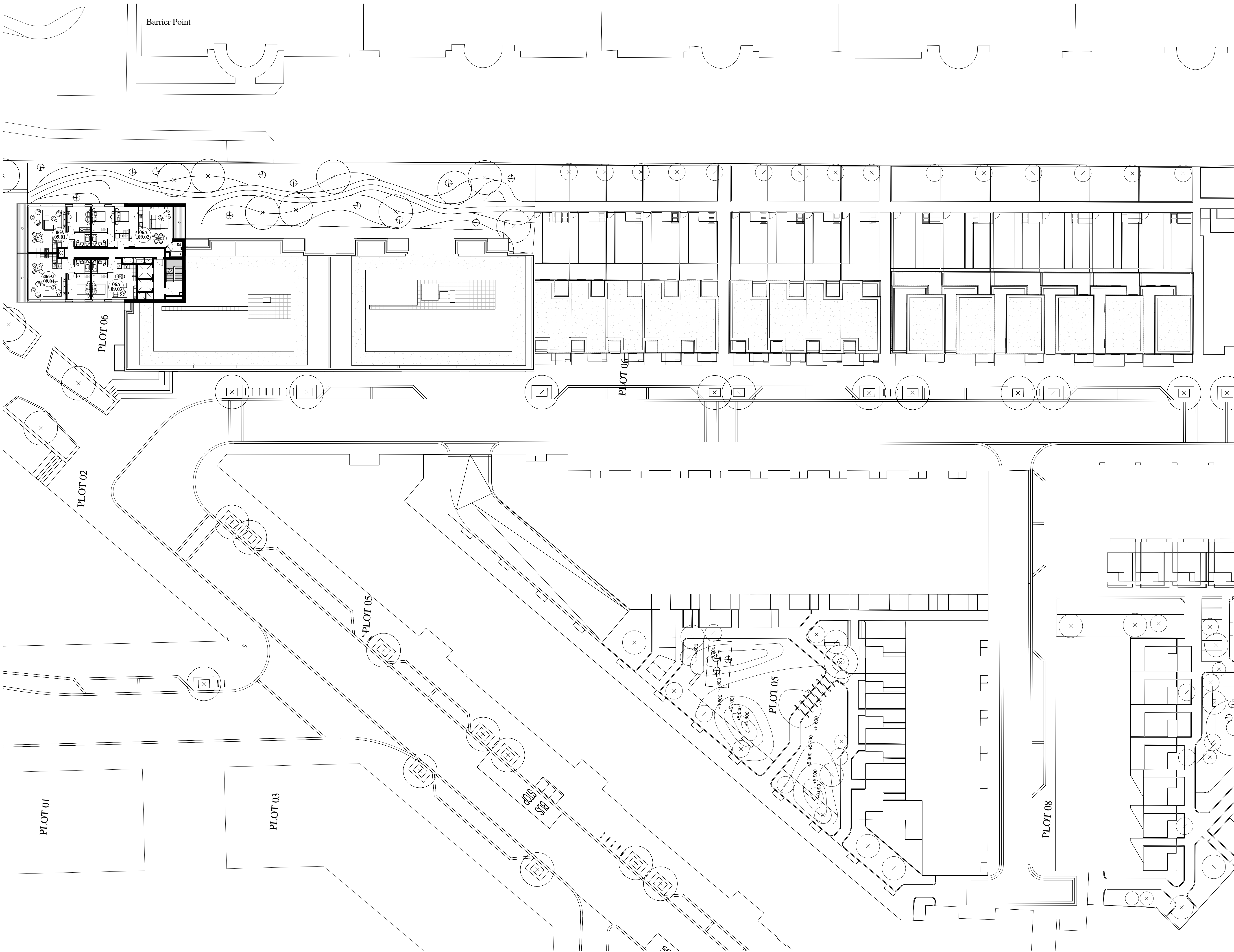

© WCEC ARCHITECTS - DISCLAIMER

This drawing is copyright and shall not be reproduced or used for any other purpose without the written permission of the Architects.

This drawing must be read in conjunction with all other related drawings and documentation.

It is the contractors responsibility to ensure full compliance with the Building Regulations.

Do not scale from this drawing, use figured dimensions only.

It is the contractors responsibility to check and verify all dimensions on site.

Any discrepancies to be reported immediately.

IF IN DOUBT ASK.

Materials not in conformity with relevant British or European Standards/Codes of practice or materials known to be deleterious to health & safety must not be used or specified on this project.

Materials known to contain asbestos contaminated materials (ACM's) in the manufacture or installation process have not been specified and must not be used on this project

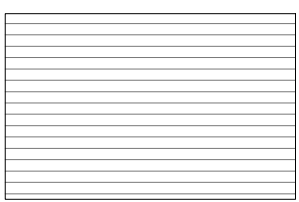
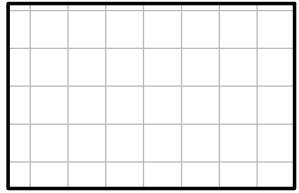

- **Balconies / External Amenity Space**
- **Balcony/External Terrace Space**

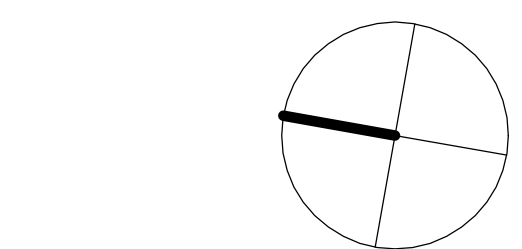

P2	08/04/14	Bin stores and cycle storage provisions amended to LHDG, apartments amended, risers and stairs rationalised, secure by design requirements implemented, external amenity spaced amended to LHDG		
Rev	Date	Description		By



PROJECT
Royal Wharf,
Development Phase 1

TITLE
Plot 06 Ninth Floor Plan

DRAWING STATUS
PLANNING APPROVAL

DRAWN	MB	CHECKED	MB
-------	----	---------	----

SCALE 1-250 @ A1 / 1-500 @ A3

DATE 09/04/14

wcecarchitects

4th Floor, South Building, Staple Inn Buildings,
High Holborn, London, WC1V 7PZ

Carnwood Court, Carnwood Road,
Sheepbridge, Chesterfield, S41 9QB

t: 020 3388 0019, e: email@wcec.co.uk, www.wcec.co.uk

JOB NO. 13-500	DRAWING NO. DPA-06-109	REV P2
-------------------	---------------------------	-----------

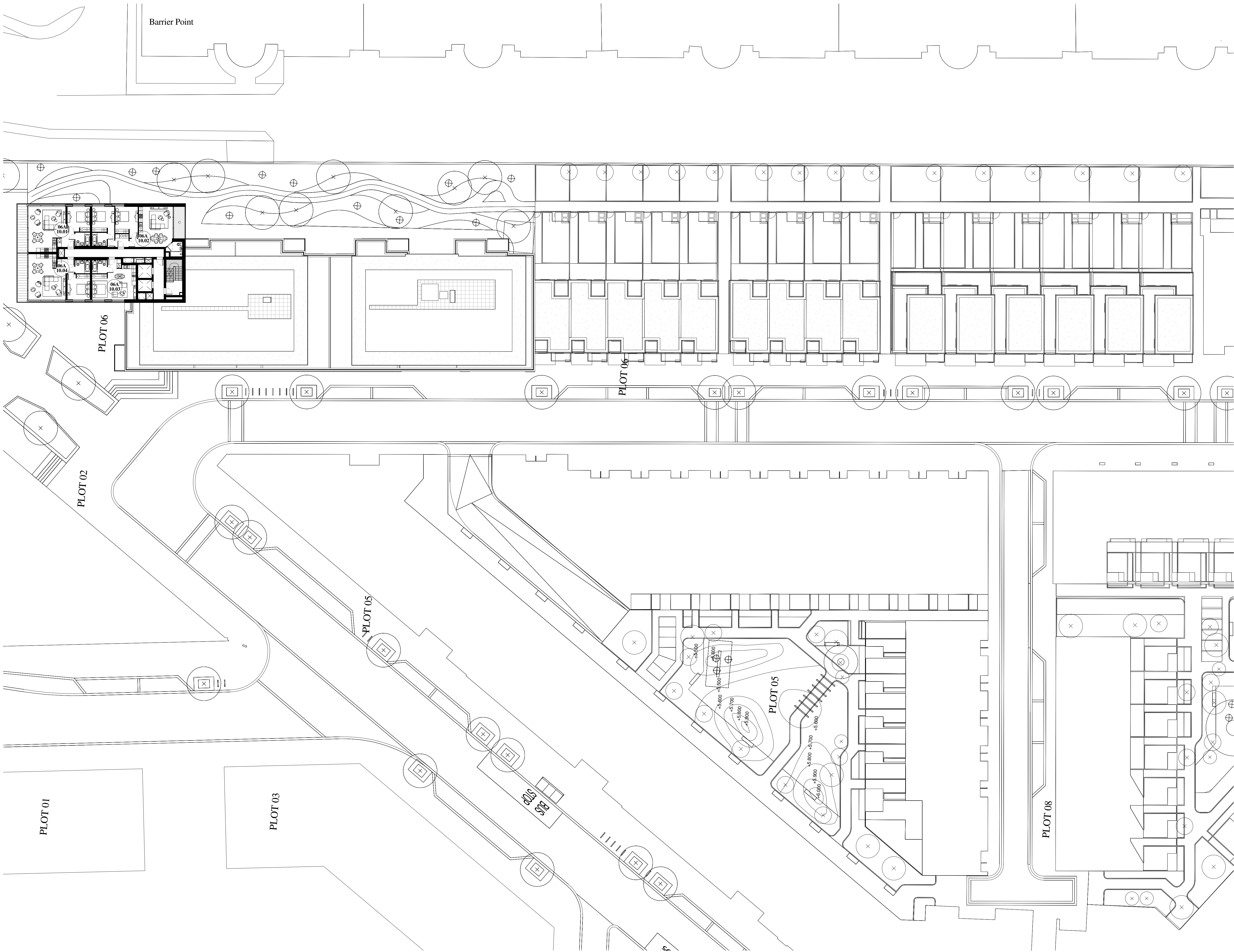

© WCEC ARCHITECTS - DISCLAIMER

This drawing is copyright and shall not be reproduced or used for any other purpose without the written permission of the Architects.

This drawing must be read in conjunction with all other related drawings and documentation.

It is the contractors responsibility to ensure full compliance with the Building Regulations.

Do not scale from this drawing, use figured dimensions only.

It is the contractors responsibility to check and verify all dimensions on site.

Any discrepancies to be reported immediately.

IF IN DOUBT ASK.

Materials not in conformity with relevant British or European Standards/Codes of practice or materials known to be deleterious to health & safety must not be used or specified on this project.

Materials known to contain asbestos contaminated materials (ACM's) in the manufacture or installation process have not been specified and must not be used on this project

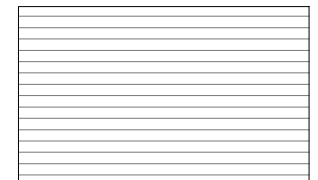

**Balconies / External Amenity Space**

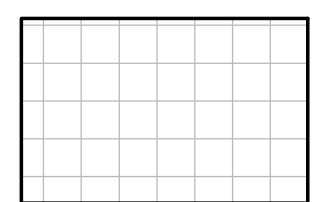
**Balcony/External Terrace Space**

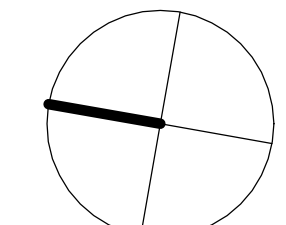

P2	08/04/14	Bin stores and cycle storage provisions amended to LHDG, apartments amended, risers and stairs rationalised, secure by design requirements implemented, external amenity spaced amended to LHDG	
Rev	Date	Description	By



PROJECT
Royal Wharf,
Development Phase 1

TITLE
Plot 06 Tenth Floor Plan

DRAWING STATUS
PLANNING APPROVAL

DRAWN	MB	CHECKED	MB
-------	----	---------	----

SCALE 1-250 @ A1 / 1-500 @ A3

DATE 09/04/14

wcecarchitects

4th Floor, South Building, Staple Inn Buildings,
High Holborn, London, WC1V 7PZ

Canwood Court, Canwood Road,
Sheepbridge, Chesterfield, S41 9QB

t: 020 3388 0019, e: email@wcec.co.uk, www.wcec.co.uk

JOB NO.	DRAWING NO.	REV
13-500	DPA-06-110	P2

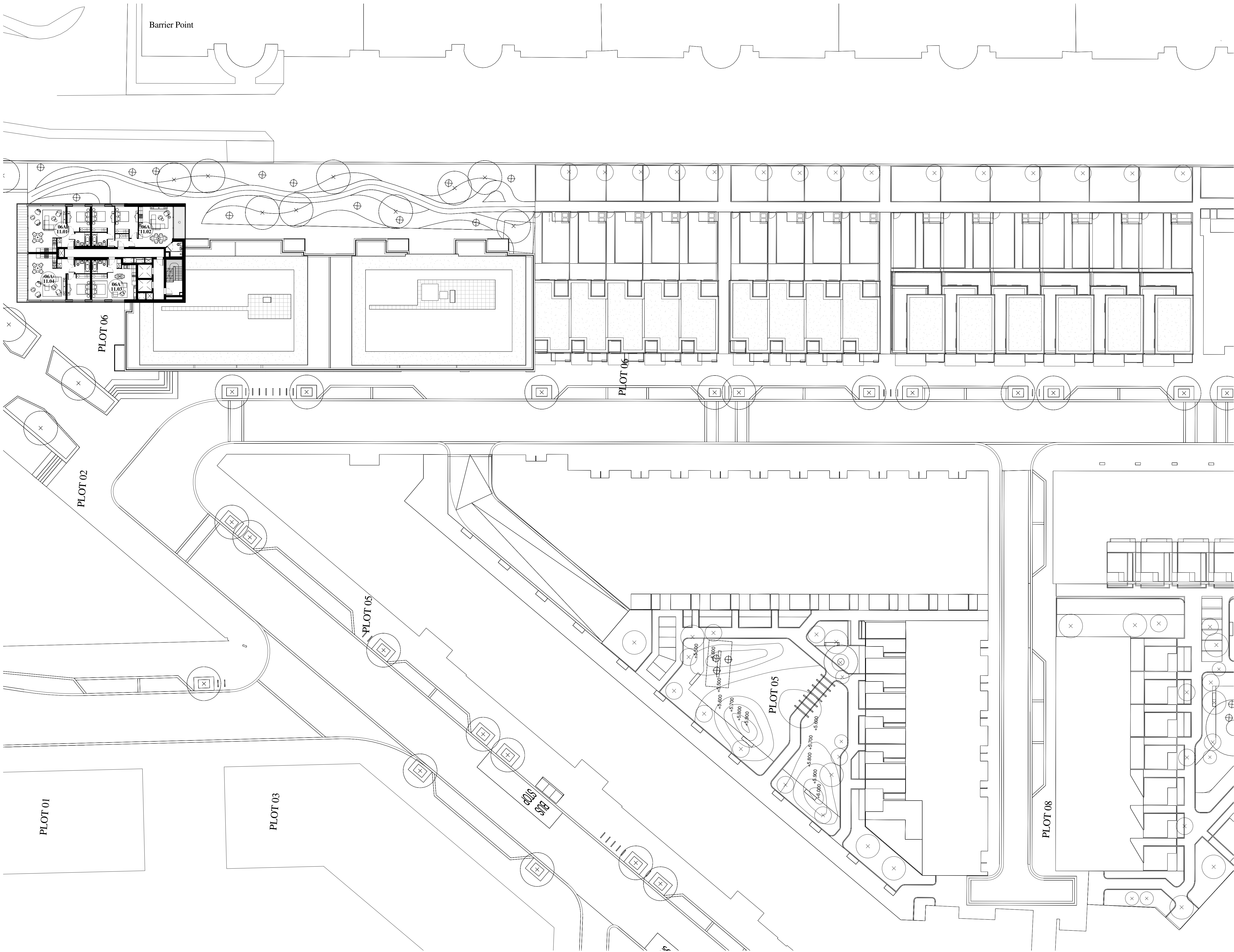

© WCEC ARCHITECTS - DISCLAIMER

This drawing is copyright and shall not be reproduced or used for any other purpose without the written permission of the Architects.

This drawing must be read in conjunction with all other related drawings and documentation.

It is the contractors responsibility to ensure full compliance with the Building Regulations.

Do not scale from this drawing, use figured dimensions only.

It is the contractors responsibility to check and verify all dimensions on site.

Any discrepancies to be reported immediately.

IF IN DOUBT ASK.

Materials not in conformity with relevant British or European Standards/Codes of practice or materials known to be deleterious to health & safety must not be used or specified on this project.

Materials known to contain asbestos contaminated materials (ACM's) in the manufacture or installation process have not been specified and must not be used on this project



Balconies /
External Amenity
Space

Balcony/External
Terrace Space

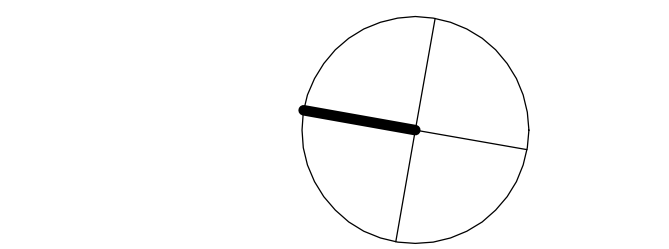

P2	08/04/14	Bin stores and cycle storage provisions amended to LHDG, apartments amended, risers and stairs rationalised, secure by design requirements implemented, external amenity spaced amended to LHDG		
Rev	Date	Description		By



PROJECT
Royal Wharf,
Development Phase 1

TITLE
Plot 06 Eleventh Floor Plan

DRAWING STATUS
PLANNING APPROVAL

DRAWN	MB	CHECKED	MB
-------	----	---------	----

SCALE 1-250 @ A1 / 1-500 @ A3

DATE 09/04/14

wcecarchitects

4th Floor, South Building, Staple Inn Buildings,
High Holborn, London, WC1V 7PZ

Carnwood Court, Carnwood Road,
Sheepbridge, Chesterfield, S41 9QB

t: 020 3388 0019, e: email@wcec.co.uk, www.wcec.co.uk

JOB NO. 13-500	DRAWING NO. DPA-06-111	REV P2
-------------------	---------------------------	-----------

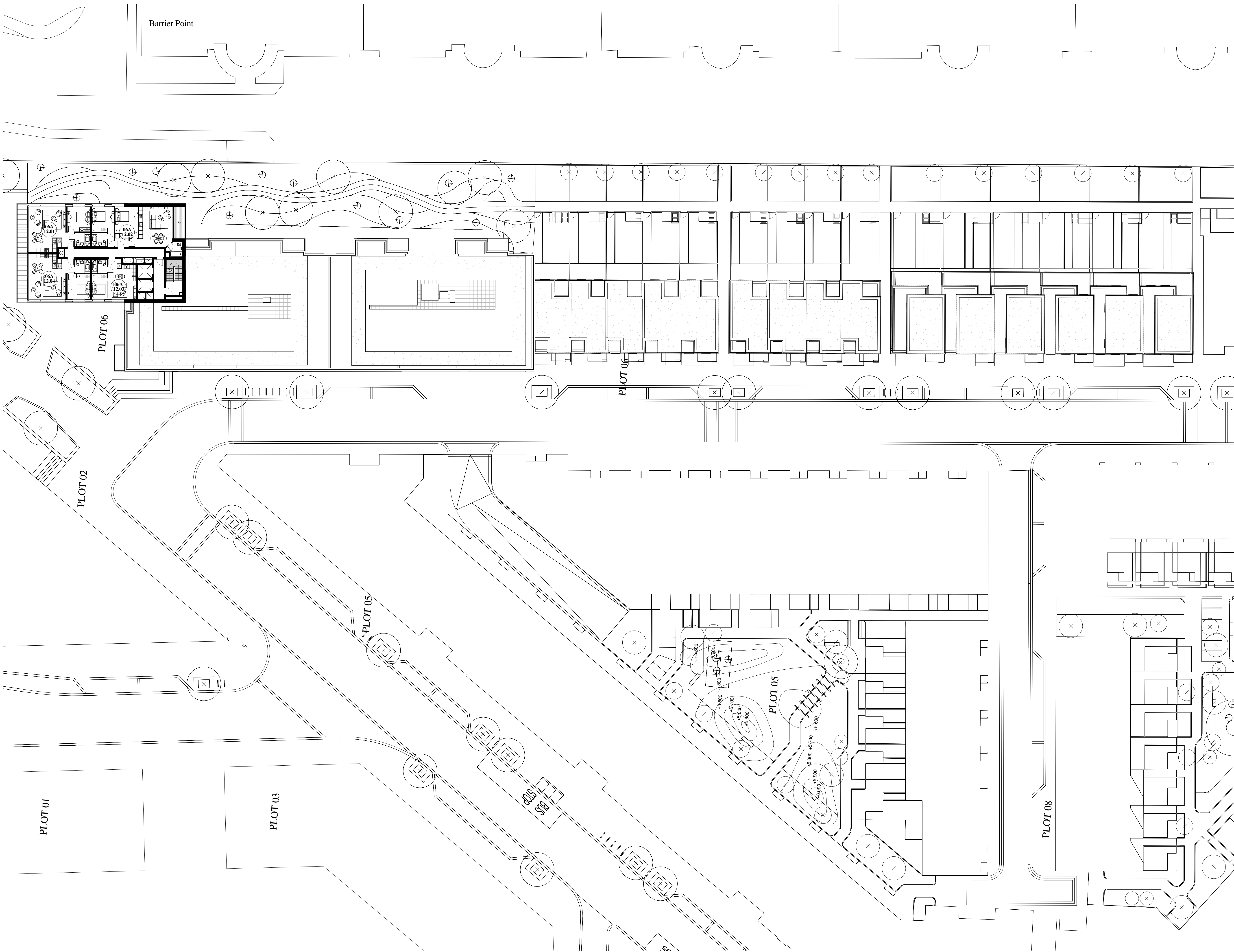

© WCEC ARCHITECTS - DISCLAIMER

This drawing is copyright and shall not be reproduced or used for any other purpose without the written permission of the Architects.

This drawing must be read in conjunction with all other related drawings and documentation.

It is the contractors responsibility to ensure full compliance with the Building Regulations.

Do not scale from this drawing, use figured dimensions only.

It is the contractors responsibility to check and verify all dimensions on site.

Any discrepancies to be reported immediately.

IF IN DOUBT ASK.

Materials not in conformity with relevant British or European Standards/Codes of practice or materials known to be deleterious to health & safety must not be used or specified on this project.

Materials known to contain asbestos contaminated materials (ACM's) in the manufacture or installation process have not been specified and must not be used on this project

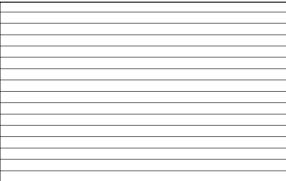

**Balconies /
External Amenity
Space**

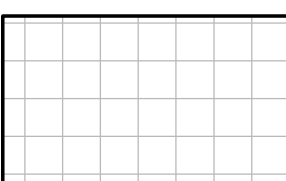
**Balcony/External
Terrace Space**

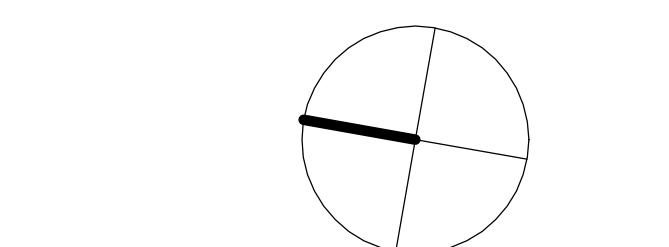

P2	08/04/14	Bin stores and cycle storage provisions amended to LHDG, apartments amended, risers and stairs rationalised, secure by design requirements implemented, external amenity spaced amended to LHDG	
Rev	Date	Description	By



PROJECT
Royal Wharf,
Development Phase 1

TITLE
Plot 06 Twelfth Floor Plan

DRAWING STATUS			
PLANNING APPROVAL			
DRAWN	MB	CHECKED	MB
SCALE	1-250 @ A1 / 1-500 @ A3		
DATE	09/04/14		

wcecarchitects

4th Floor, South Building, Staple Inn Buildings,
High Holborn, London, WC1V 7PZ

Carnwood Court, Carnwood Road,
Sheepbridge, Chesterfield, S41 9QB

t: 020 3388 0019, e: email@wcec.co.uk, www.wcec.co.uk

JOB NO.	DRAWING NO.	REV
13-500	DPA-06-112	P2

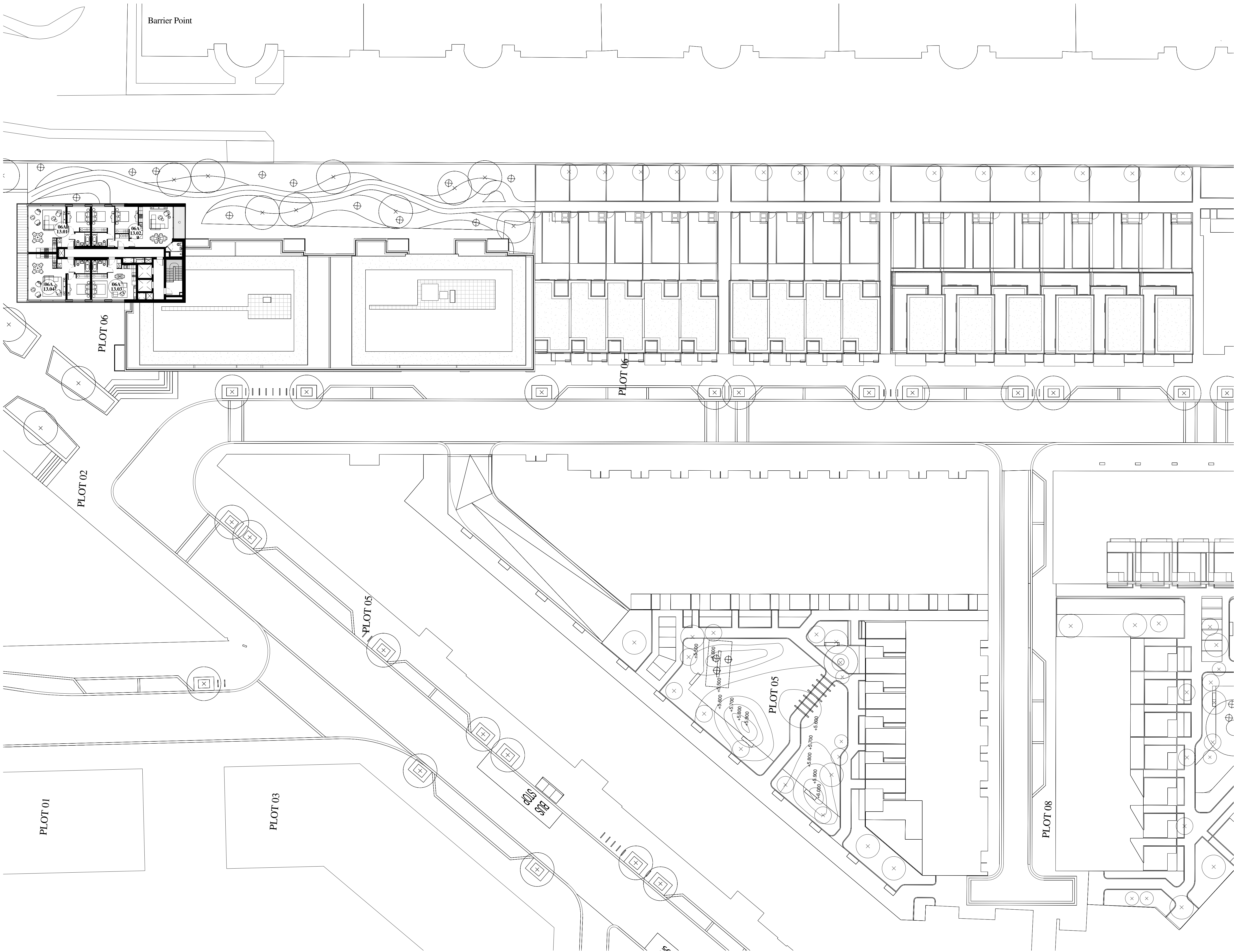

© WCEC ARCHITECTS - DISCLAIMER

This drawing is copyright and shall not be reproduced or used for any other purpose without the written permission of the Architects.

This drawing must be read in conjunction with all other related drawings and documentation.

It is the contractors responsibility to ensure full compliance with the Building Regulations.

Do not scale from this drawing, use figured dimensions only.

It is the contractors responsibility to check and verify all dimensions on site.

Any discrepancies to be reported immediately.

IF IN DOUBT ASK.

Materials not in conformity with relevant British or European Standards/Codes of practice or materials known to be deleterious to health & safety must not be used or specified on this project.

Materials known to contain asbestos contaminated materials (ACM's) in the manufacture or installation process have not been specified and must not be used on this project.

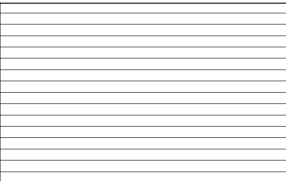

**Balconies /
External Amenity
Space**

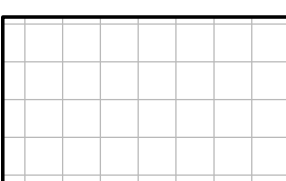
**Balcony/External
Terrace Space**

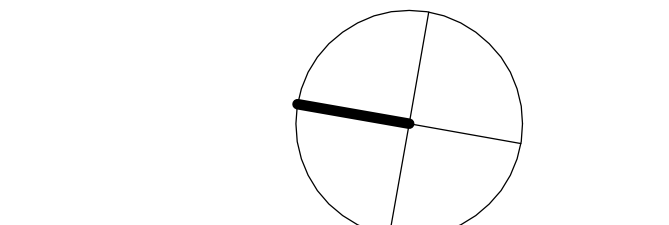

P2	08/04/14	Bin stores and cycle storage provisions amended to LHDG, apartments amended, risers and stairs rationalised, secure by design requirements implemented, external amenity spaced amended to LHDG		
Rev	Date	Description	By	



PROJECT
Royal Wharf,
Development Phase 1

TITLE
Plot 06 Thirteenth Floor

DRAWING STATUS
PLANNING APPROVAL

DRAWN	MB	CHECKED	MB
-------	----	---------	----

SCALE 1-250 @ A1 / 1-500 @ A3

DATE 09/04/14

wcecarchitects

4th Floor, South Building, Staple Inn Buildings,
High Holborn, London, WC1V 7PZ

Canwood Court, Canwood Road,
Sheepbridge, Chesterfield, S41 9QB

t: 020 3388 0019, e: email@wcec.co.uk, www.wcec.co.uk

JOB NO. 13-500	DRAWING NO. DPA-06-113	REV P2
-------------------	---------------------------	-----------

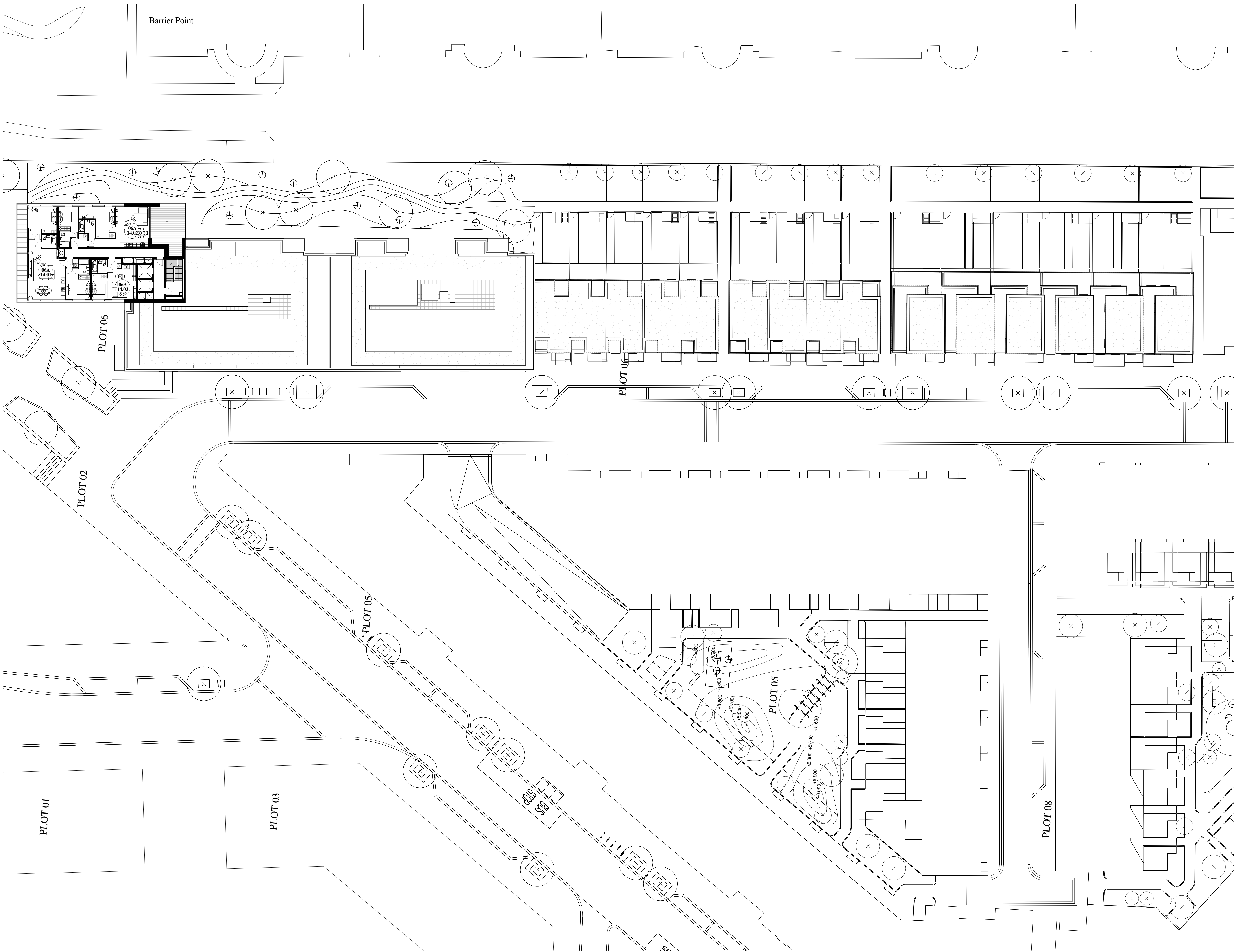

© WCEC ARCHITECTS - DISCLAIMER

This drawing is copyright and shall not be reproduced or used for any other purpose without the written permission of the Architects.

This drawing must be read in conjunction with all other related drawings and documentation.

It is the contractors responsibility to ensure full compliance with the Building Regulations.

Do not scale from this drawing, use figured dimensions only.

It is the contractors responsibility to check and verify all dimensions on site.

Any discrepancies to be reported immediately.

IF IN DOUBT ASK.

Materials not in conformity with relevant British or European Standards/Codes of practice or materials known to be deleterious to health & safety must not be used or specified on this project.

Materials known to contain asbestos contaminated materials (ACM's) in the manufacture or installation process have not been specified and must not be used on this project

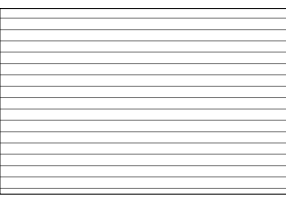
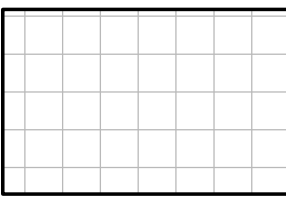

- **Balconies /
External Amenity
Space**
- **Balcony/External
Terrace Space**

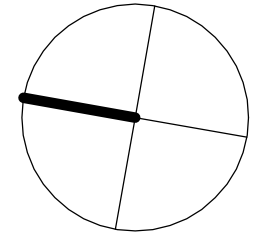

P2	08/04/14	Bin stores and cycle storage provisions amended to LHDG, apartments amended, risers and stairs rationalised, secure by design requirements implemented, external amenity spaced amended to LHDG	
Rev	Date	Description	By



PROJECT
Royal Wharf,
Development Phase 1

TITLE
Plot 06 Fourteenth Floor

DRAWING STATUS
PLANNING APPROVAL

DRAWN	MB	CHECKED	MB
-------	----	---------	----

SCALE 1-250 @ A1 / 1-500 @ A3

DATE 09/04/14

wcecarchitects

4th Floor, South Building, Staple Inn Buildings,
High Holborn, London, WC1V 7PZ

Carnwood Court, Carnwood Road,
Sheepbridge, Chesterfield, S41 9QB

t: 020 3388 0019, e: email@wcec.co.uk, www.wcec.co.uk

JOB NO. 13-500	DRAWING NO. DPA-06-114	REV P2
-------------------	---------------------------	-----------

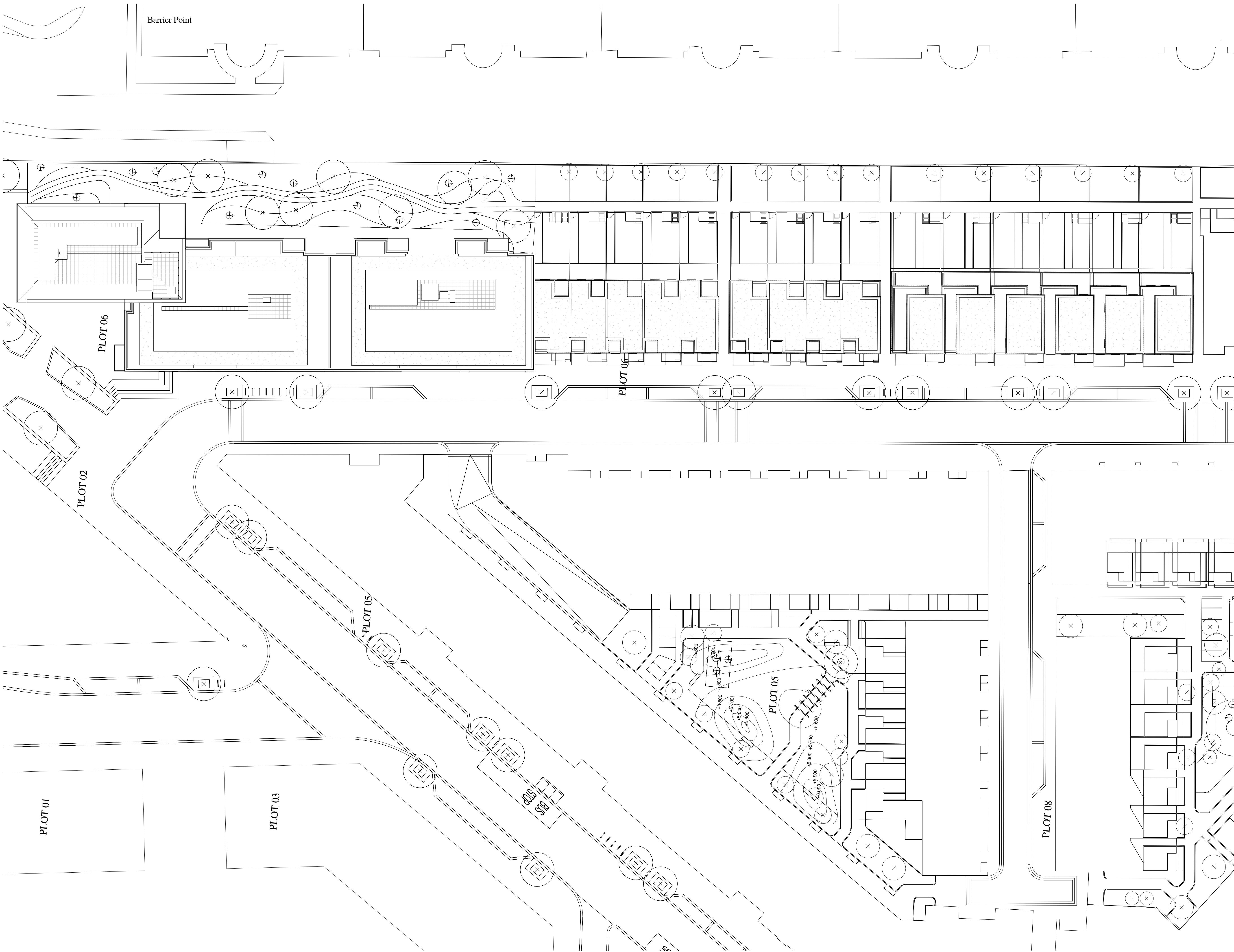

© WCEC ARCHITECTS - DISCLAIMER

This drawing is copyright and shall not be reproduced or used for any other purpose without the written permission of the Architects.

This drawing must be read in conjunction with all other related drawings and documentation.

It is the contractors responsibility to ensure full compliance with the Building Regulations.

Do not scale from this drawing, use figured dimensions only.

It is the contractors responsibility to check and verify all dimensions on site.

Any discrepancies to be reported immediately.

IF IN DOUBT ASK.

Materials not in conformity with relevant British or European Standards/Codes of practice or materials known to be deleterious to health & safety must not be used or specified on this project.

Materials known to contain asbestos contaminated materials (ACM's) in the manufacture or installation process have not been specified and must not be used on this project

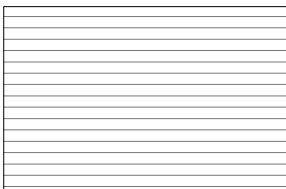

 Balconies / External Amenity Space

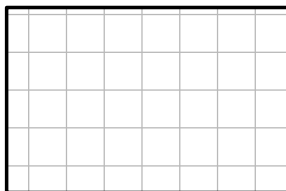
 Balcony/External Terrace Space

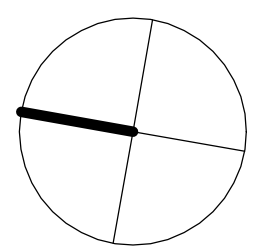

P2	08/04/14	Bin stores and cycle storage provisions amended to LHDG, apartments amended, risers and stairs rationalised, secure by design requirements implemented, external amenity spaced amended to LHDG		
Rev	Date	Description		By



PROJECT
Royal Wharf,
Development Phase 1

TITLE
Plot 06 Roof Plan

DRAWING STATUS
PLANNING APPROVAL

DRAWN	MB	CHECKED	MB
-------	----	---------	----

SCALE 1-250 @ A1 / 1-500 @ A3

DATE 09/04/14

wcecarchitects

4th Floor, South Building, Staple Inn Buildings,
High Holborn, London, WC1V 7PZ

Carnwood Court, Carnwood Road,
Sheepbridge, Chesterfield, S41 9QB

t: 020 3388 0019, e: email@wcec.co.uk, www.wcec.co.uk

JOB NO. 13-500	DRAWING NO. DPA-06-115	REV P2
-------------------	---------------------------	-----------



- KEY**
- BROWN ROOF - TO SPECIFICATION
3846m²
 - GREEN ROOF - TO SPECIFICATION
1302m²
 - PAVING TYPE 1 600mm x 600mm x 50mm
ANDOVER CONCRETE PAVING
 - GRAVEL STRIP 600mm WIDTH - TO
ARCHITECTS DETAIL
 - PRIVATE ROOF TERRACE - TO
ARCHITECTS DETAIL
 - PRIVATE ROOF TERRACE - TO
ARCHITECTS DETAIL
 - DEMOUNTABLE KEY CLAMP
BALUSTRADE SYSTEM

NOTE
1. DEMOUNTABLE KEY CLAMP BALUSTRADE
REQUIRES A PC PAVING SLAB EVERY 1.2M
TO HOLD IT IN PLACE.

- GENERAL NOTES**
- Do not scale drawing.
 - All setting out, levels and dimensions to be agreed on site.
 - The dimensions of all materials must be checked on site before being laid out.
 - This drawing must be read with the relevant specification clauses and detail drawings.
 - Order of construction and setting out to be agreed on site.

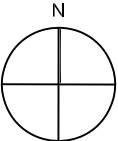
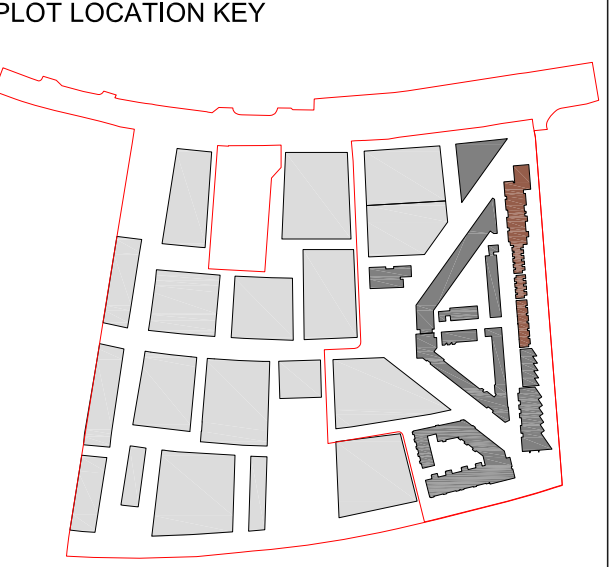

Project ROYAL WHARF DEVELOPMENT PHASE 1	Drawing Title PLOT 6 LANDSCAPE ROOF PLAN	Revision	Date	Client: Ballymore Group Address: Pointe North 3 Greenwich View Place London E14 9NN	Consultant TOWNSHEND Landscape Architects Unit 3A Zetland House London EC2A 4EJ Telephone: 020 7729 9333 Fax: 020 7729 3300 E-Mail: info@townshenda.com	Project No. 465.1	Scale 1:250 1:500 @ A3	Approved By RA	Drawing No. DPA-06-901	Revision P04
		P01 - Minor Amendments	150911			Date MAY 14	Drawing Size A1	Drawn By MK		



EAST ELEVATION



WEST ELEVATION

© WCEC ARCHITECTS - DISCLAIMER
This drawing is copyright and shall not be reproduced or used for any other purpose without the written permission of the Architects.
It is the contractors responsibility to ensure full compliance with the Building Regulations.
Do not scale from this drawing, use figured dimensions only.
It is the contractors responsibility to check and verify all dimensions on site.
Any discrepancies to be reported immediately.
IF IN DOUBT ASK.
Materials not in conformity with relevant British or European Standards/Codes of practice or materials known to be deleterious to health & safety must not be used or specified on this project.
Materials known to contain asbestos contaminated materials (ACM's) in the manufacture or installation process have not been specified and must not be used on this project

P2	08/04/14	Bin stores and cycle storage provisions amended to LHDG, apartments amended, risers and stairs rationalised, secure by design requirements implemented, external amenity spaced amended to LHDG	
Rev	Date	Description	By



PROJECT
Royal Wharf,
Development Phase 1

TITLE
Plot 06 East and West Elevation

DRAWING STATUS			
PLANNING APPROVAL			
DRAWN	SA	CHECKED	MB
SCALE 1:250 @ A1 / 1:500 @ A3			
DATE 25/04/14			

WCECarchitects

4th Floor, South Building, Staple Inn Buildings,
High Holborn, London, WC1V 7PZ

Canwood Court, Canwood Road,
Sheepbridge, Chesterfield, S41 9QB

t: 020 3388 0019, e: email@wcec.co.uk, www.wcec.co.uk

JOB NO. 13-500	DRAWING NO. DPA-06-201	REV P2
-------------------	---------------------------	-----------



NORTH ELEVATION
1 : 250

© WCEC ARCHITECTS - DISCLAIMER

This drawing is copyright and shall not be reproduced or used for any other purpose without the written permission of the Architects. This drawing must be read in conjunction with all other related drawings and documentation. It is the contractors responsibility to ensure full compliance with the Building Regulations. Do not scale from this drawing, use figured dimensions only. It is the contractors responsibility to check and verify all dimensions on site. Any discrepancies to be reported immediately. IF IN DOUBT ASK. Materials not in conformity with relevant British or European Standards/Codes of practice or materials known to be deleterious to health & safety must not be used or specified on this project. Materials known to contain asbestos contaminated materials (ACM's) in the manufacture or installation process have not been specified and must not be used on this project

1 Facing Brickwork (Type TBC)

2 Concrete Cladding

3a Aluminium Window System (colour/Finish TBC)

3b Aluminium Window System with Louvre (colour/Finish TBC)

4 Aluminium Curtain Wall System (Colour/Finish TBC)

5 Timber Weatherboarding

6 Aluminium Rainscreen Panel

7 Zinc Standing Seam Cladding

8 Aluminium Brese Solei

9 Glazed Balustrade

10 Metal Balustrade

11 Aluminium Panel

12 Aluminium Louvre

RIVER THAMES



SOUTH ELEVATION
1 : 250

P2	08/04/14	Bin stores and cycle storage provisions amended to LHDG, apartments amended, risers and stairs rationalised, secure by design requirements implemented, external amenity spaced amended to LHDG	
Rev	Date	Description	By



PROJECT
Royal Wharf,
Development Phase 1

TITLE
Plot 06 North and South Elevations

DRAWING STATUS			
PLANNING APPROVAL			
DRAWN	SA	CHECKED	MB
SCALE	1-250 @ A1 / 1-500 @ A3		
DATE	25/04/14		

wcecarchitects

4th Floor, South Building, Staple Inn Buildings,
High Holborn, London, WC1V 7PZ

Carnwood Court, Carnwood Road,
Sheepbridge, Chesterfield, S41 9QB

JOB NO. 13-500	DRAWING NO. DPA-06-200	REV P2
-------------------	---------------------------	-----------

© WCEC ARCHITECTS - DISCLAIMER

This drawing is copyright and shall not be reproduced or used for any other purpose without the written permission of the Architects.

This drawing must be read in conjunction with all other related drawings and documentation.

It is the contractors responsibility to ensure full compliance with the Building Regulations.

Do not scale from this drawing, use figured dimensions only.

It is the contractors responsibility to check and verify all dimensions on site.

Any discrepancies to be reported immediately.

IF IN DOUBT ASK.

Materials not in conformity with relevant British or European Standards/Codes of practice or materials known to be deleterious to health & safety must not be used or specified on this project.

Materials known to contain asbestos contaminated materials (ACM's) in the manufacture or installation process have not been specified and must not be used on this project

SECTION AA

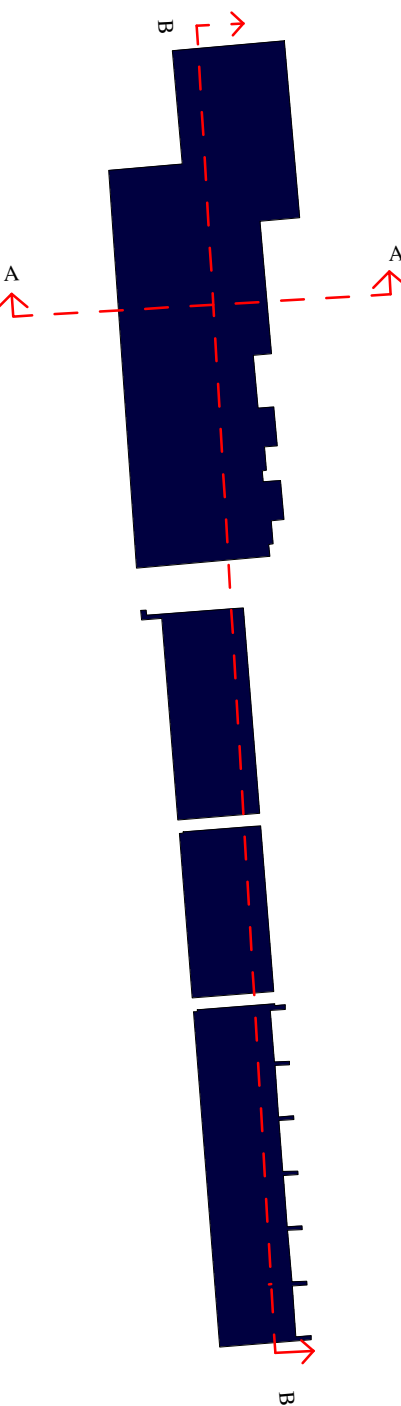

SECTION BB



P2	08/04/14	Bin stores and cycle storage provisions amended to LHDG, apartments amended, risers and stairs rationalised, secure by design requirements implemented, external amenity spaced amended to LHDG	
Rev	Date	Description	By



ROYAL WHARF
LONDON

PROJECT
Royal Wharf,
Development Phase 1

TITLE
Plot 06 Section AA and Section BB

DRAWING STATUS
PLANNING APPROVAL

DRAWN	SA	CHECKED	MB
-------	----	---------	----

SCALE 1-250 @ A1 / 1-500 @ A3

DATE 25/04/14

wcecarchitects

4th Floor, South Building, Staple Inn Buildings,
High Holborn, London, WC1V 7PZ

Canwood Court, Canwood Road,
Sheepbridge, Chesterfield, S41 9QB

t: 020 3388 0019, e: email@wcec.co.uk, www.wcec.co.uk

JOB NO. 13-500	DRAWING NO. DPA-06-300	REV P2
-------------------	---------------------------	-----------



KEY

- PAVING TYPE 5
ANDOVER CONCRETE PAVING
- PAVING TYPE 7
ANDOVER CONCRETE PAVING
- CEDEC SELF BINDING GRAVEL
- CHILDRENS PLAY ELEMENT
- LAWN
- SHRUB AND HERBACEOUS
PLANTING
- KITCHEN GARDEN
- PROPOSED TREE
PLANTING
- DETAILED AREA
- OUTLINE AREA
- PROPOSED LEVEL
+5.295
- EXISTING LEVEL
+1.660

- GENERAL NOTES
1. Do not scale drawing.
 2. All setting out, levels and dimensions to be agreed on site.
 3. The dimensions of all materials must be checked on site before being laid out.
 4. This drawing must be read with the relevant specification clauses and detail drawings.
 5. Order of construction and setting out to be agreed on site.

PLOT LOCATION KEY

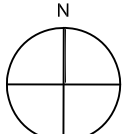
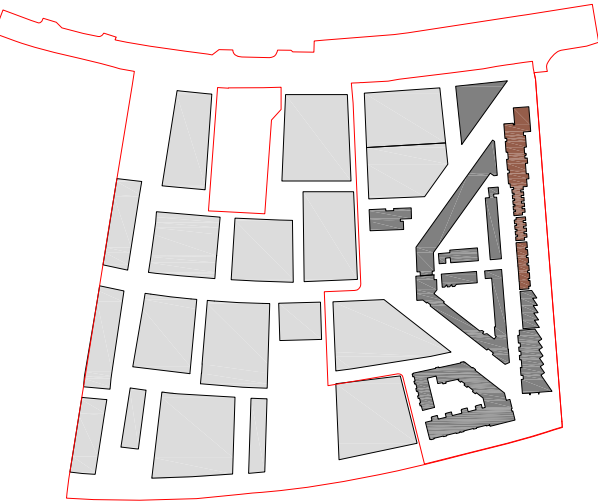

Project ROYAL WHARF DEVELOPMENT PHASE 1	Drawing Title PLOT 6 LANDSCAPE FINISHES PLAN	Revision	Date		Client: Ballymore Group Address: Pointe North 3 Greenwich View Place London E14 9NN	Consultant TOWNSHEND Landscape Architects Unit 3A Zetland House London EC2A 4HJ Telephone: 020 7729 9333 Fax: 020 7729 3300 E-Mail: info@townshenda.com	Project No.	Scale	Approved By	Drawing No.	Revision
		P01 - Minor Amendments	150911				465.1	1:250 1:500 @ A3	MA	DPA-06-900	P03
		P02 - Surface Finishes Amendments	240214	Dimensions to be verified on site. Figured dimensions to take preference to those scaled. Any areas indicated on this drawing are for guidance only. No responsibility is taken for their accuracy.			Date	Drawing Size	Drawn By		
		P03 - Minor Amendments	070414				SEP 2011	A1	MIC		