



P1 - PLANNING ISSUE **SEPTEMBER 2011**
 Amendment Date

MINOCO PLOT DESIGN Job/Drawing No **DPA-05-099** Amendment **P1**
 Plot 05 Basement Plan

Client **Clearstorm Limited and Heracles Limited** Scale **1:250 (1:500 @ A3)**
 both wholly owned subsidiaries of **Ballymore Group** Date **September 2011**
 Drawn **TM / ME**

Do not scale Original printed at A1
 All dimensions to be checked on site

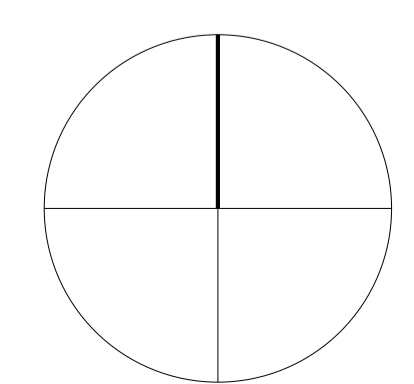
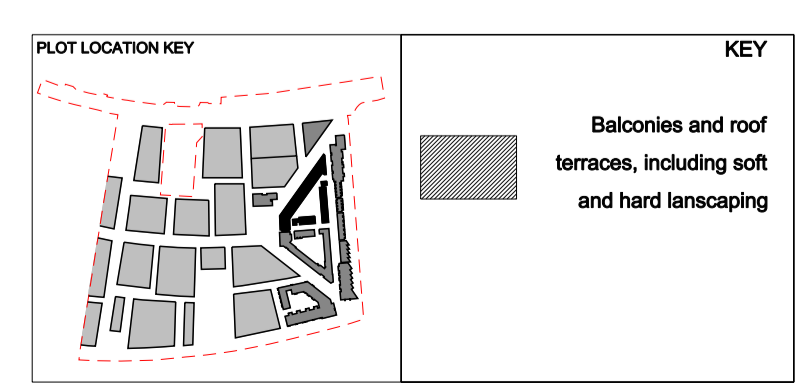

FeildenCleggBradleyStudios
LLP
 Twenty
 Tottenham Street
 London
 W1T 4RF
 t 020 73235737
 f 020 73235720
 e london@fcbstudios.com

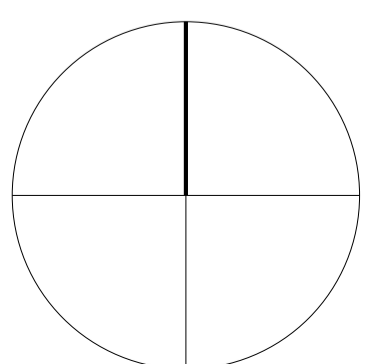
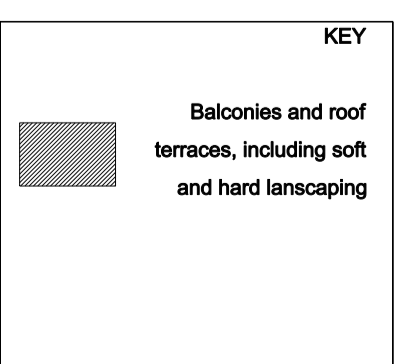
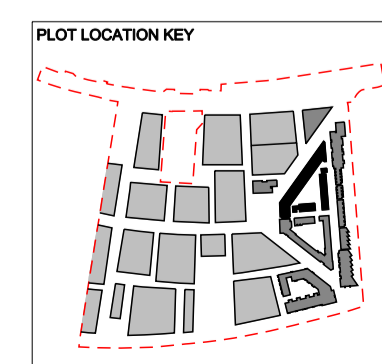
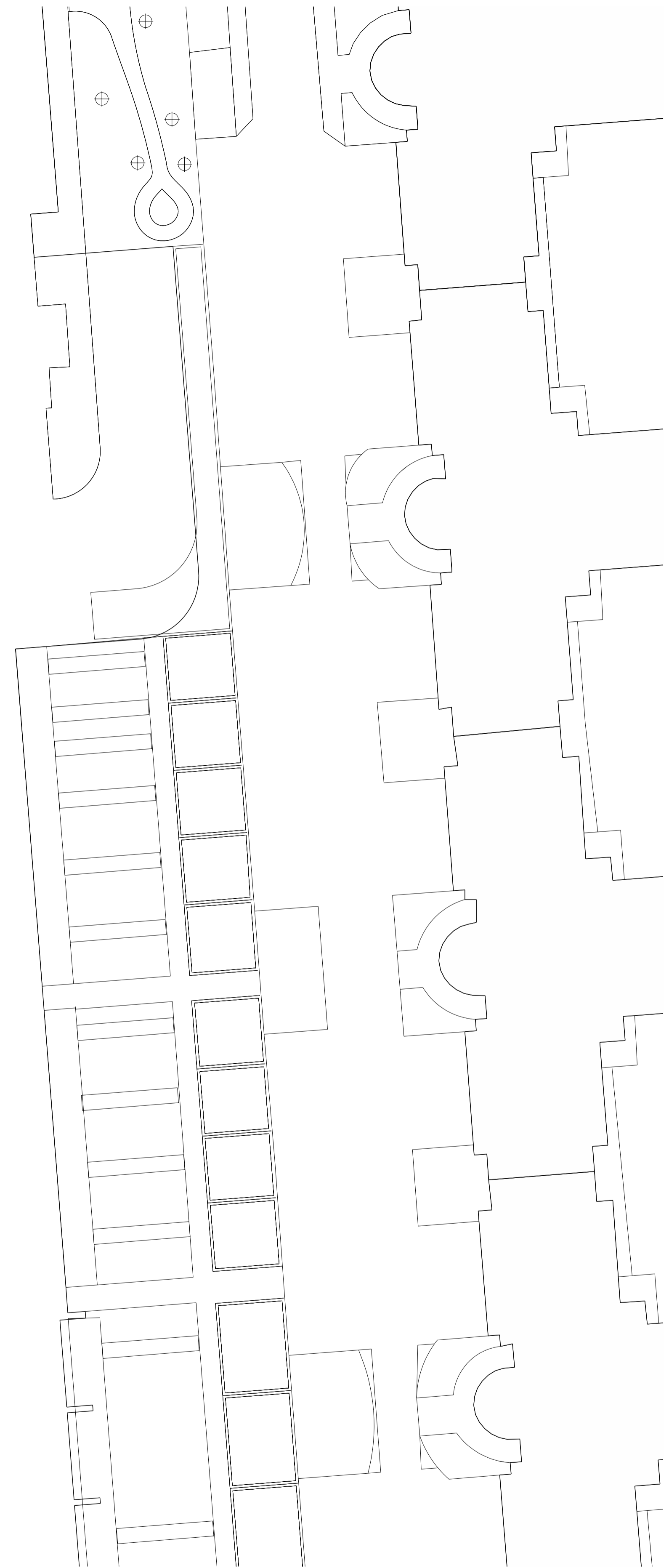
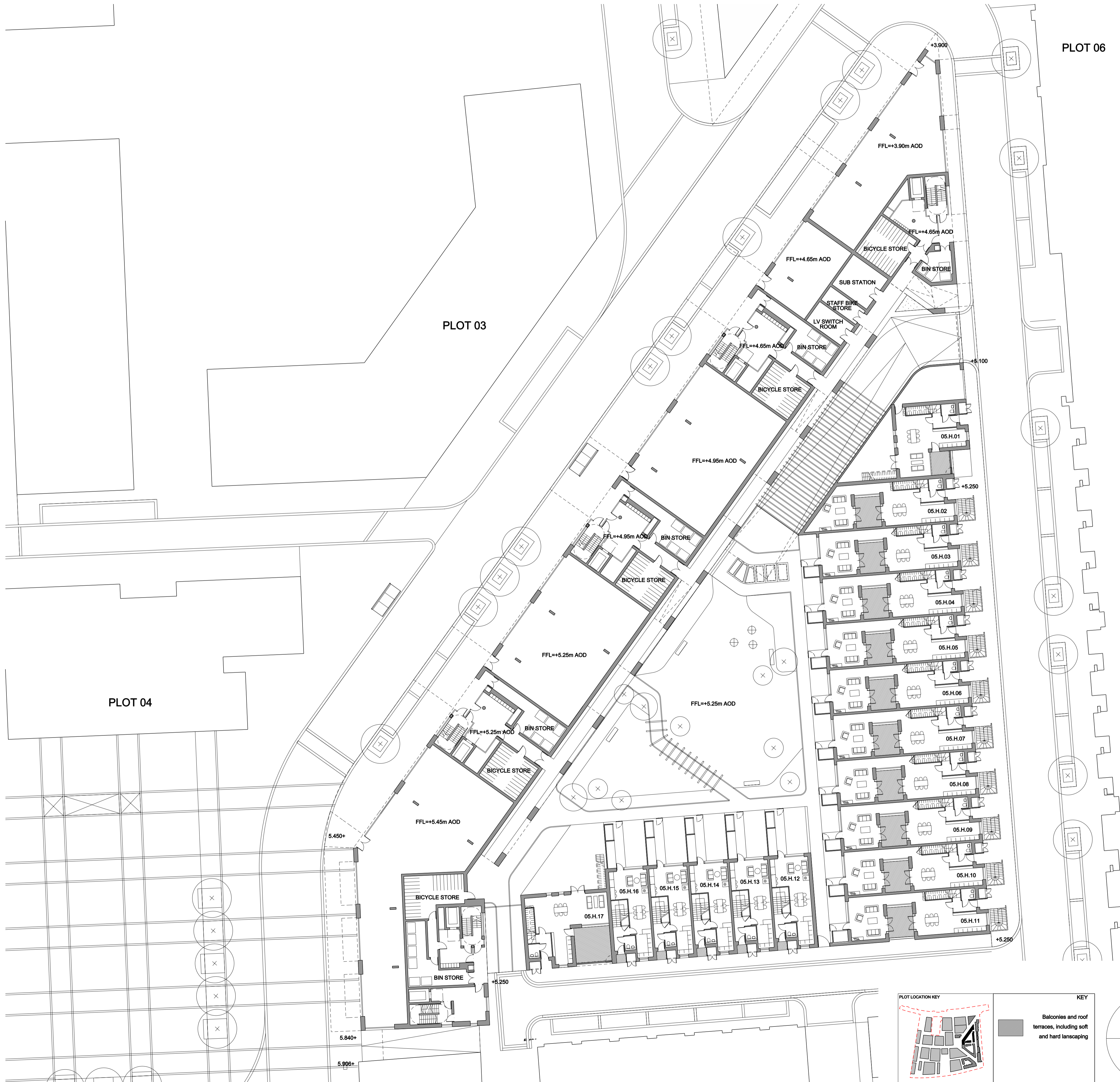

FeildenCleggBradleyStudios
 LLP
 Twenty
 Tottenham Street
 London
 W1T 4RF
 t 020 73235737
 f 020 73235720
 e london@fcbstudios.com

P1 - PLANNING ISSUE **SEPTEMBER 2011**
 Amendment Date
MINOCO PLOT DESIGN Job/Drawing No Amendment
 Plot 05 Ground Floor Plan **DPA-05-100** **P1**
 Client Scale 1:250 (1:500 @ A3)
 Clearstorm Limited and Heracles Limited Date September 2011
 both wholly owned subsidiaries of Drawn TM / ME
 Ballymore Group
 Do not scale All dimensions to be checked on site
 Original printed at A1



PLOT 06

PLOT 03

PLOT 04

P1 - PLANNING ISSUE SEPTEMBER 2011
 Amendment Date

MINOCO PLOT DESIGN Job/Drawing No Amendment
 Plot 05 First Floor Plan DPA-05-101 P1

Client Scale 1:250 (1:500 @ A3)
 Clearstorm Limited and Heracles Limited Date September 2011
 both wholly owned subsidiaries of Ballymore Group Drawn TM / ME

Do not scale Original printed at A1
 All dimensions to be checked on site

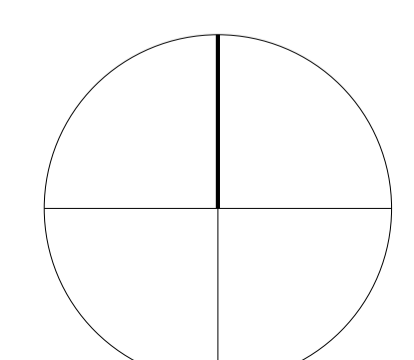
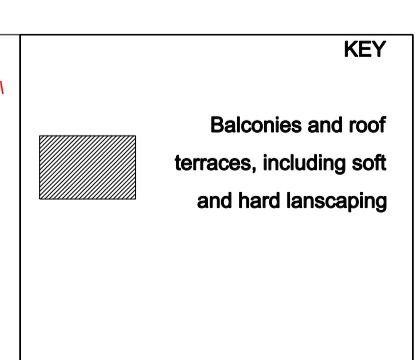
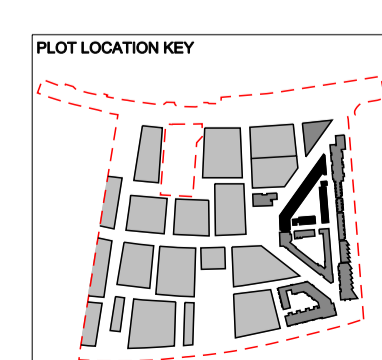

FeildenCleggBradleyStudios
 LLP
 Twenty
 Tottenham Street
 London
 W1T 4RF
 t 020 73235737
 f 020 73235720
 e london@fcbstudios.com



PLOT 06

PLOT 03

PLOT 04

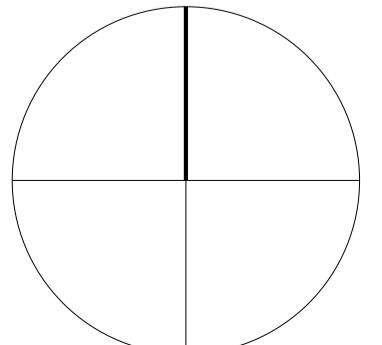
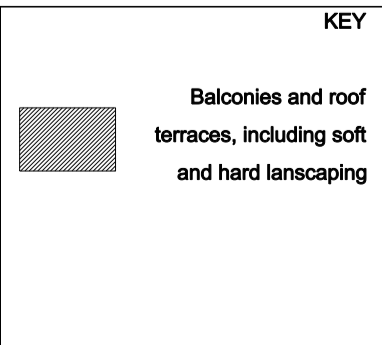
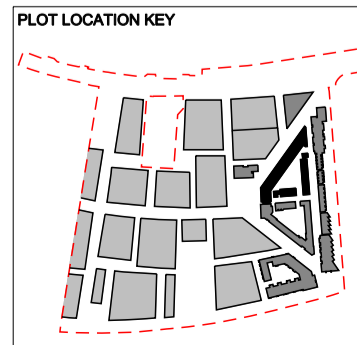

FeildenCleggBradleyStudios
LLP
Twenty
Tottenham Street
London
W1T 4RF
t 020 73235737
f 020 73235720
e london@fcbstudios.com

P1 - PLANNING ISSUE SEPTEMBER 2011
Amendment Date
MINOCO PLOT DESIGN Job/Drawing No Amendment
Plot 05 Second Floor Plan DPA-05-102 P1
Client Scale 1:250 (1:500 @ A3)
Clearstorm Limited and Heracles Limited Date September 2011
both wholly owned subsidiaries of Drawn TM / ME
Ballymore Group
Do not scale Original printed at A1
All dimensions to be checked on site



PLOT 04

PLOT 03

PLOT 06

CORE D

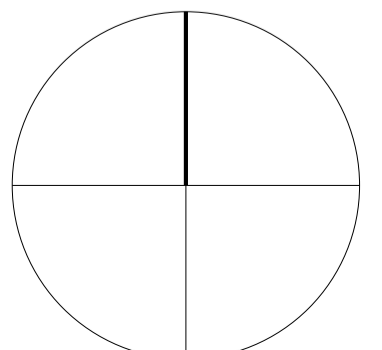
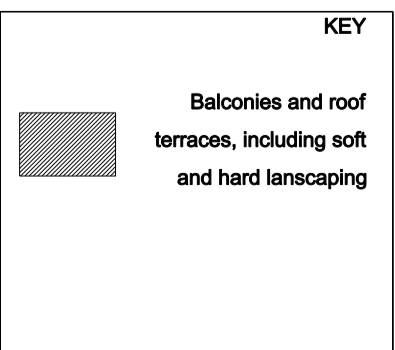
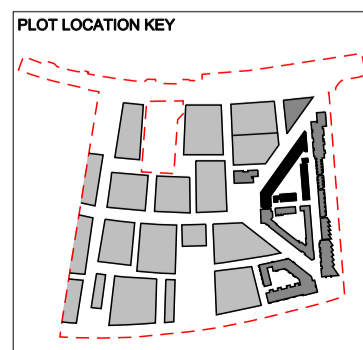

FeildenCleggBradleyStudios
LLP
Twenty
Tottenham Street
London
W1T 4RF
t 020 73235737
f 020 73235720
e london@fcbstudios.com

P1 - PLANNING ISSUE SEPTEMBER 2011
Amendment Date
MINOCO PLOT DESIGN
Plot 05 Third Floor Plan
Job/Drawing No Amendment
DPA-05-103 P1
Client
Clearstorm Limited and Heracles Limited
both wholly owned subsidiaries of
Ballymore Group
Scale 1:250 (1:500 @ A3)
Date September 2011
Drawn TM / ME
Do not scale
All dimensions to be checked on site
Original printed at A1



PLOT 06

PLOT 03

PLOT 04

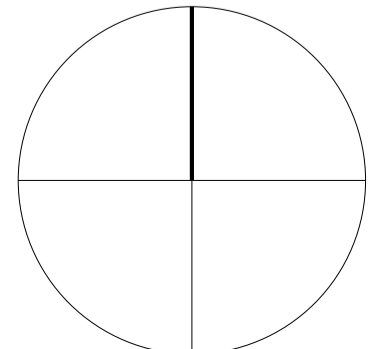
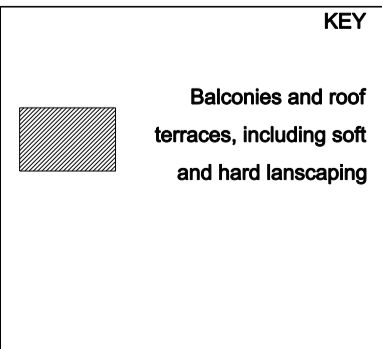
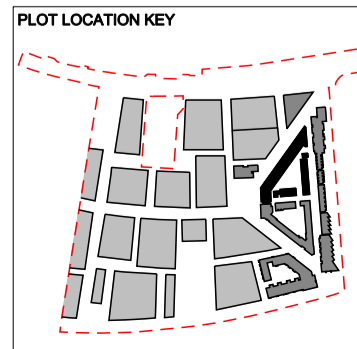

FeildenCleggBradleyStudios
LLP
Twenty
Tottenham Street
London
W1T 4RF
t 020 73235737
f 020 73235720
e london@fcbstudios.com

P1 - PLANNING ISSUE SEPTEMBER 2011
Amendment Date

MINOCO PLOT DESIGN Job/Drawing No Amendment
Plot 05 Fourth Floor Plan DPA-05-104 P1

Client Scale 1:250 (1:500 @ A3)
Clearstorm Limited and Heracles Limited Date September 2011
both wholly owned subsidiaries of Drawn TM / ME
Ballymore Group

Do not scale All dimensions to be checked on site

Original printed at A1



PLOT 06

PLOT 03

PLOT 04

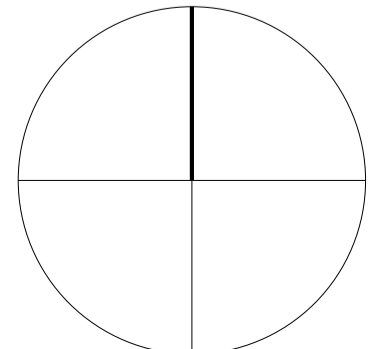
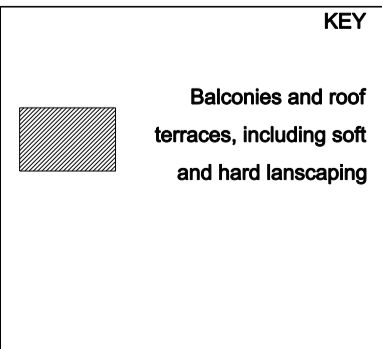
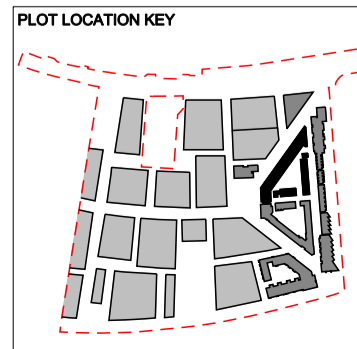

FeildenCleggBradleyStudios
LLP
Twenty
Tottenham Street
London
W1T 4RF
t 020 73235737
f 020 73235720
e london@fcbstudios.com

P1 - PLANNING ISSUE SEPTEMBER 2011
Amendment Date

MINOCO PLOT DESIGN Job/Drawing No Amendment
Plot 05 Fifth Floor Plan DPA-05-105 P1

Client Scale 1:250 (1:500 @ A3)
Clearstorm Limited and Heracles Limited Date September 2011
both wholly owned subsidiaries of Drawn TM / ME
Ballymore Group

Do not scale Original printed at A1
All dimensions to be checked on site



PLOT 06

PLOT 03

PLOT 04

05.06.01
05.06.02
05.06.03
05.06.04
05.06.05
05.06.06
05.06.07
05.06.08
05.06.09
05.06.10
05.06.11
05.06.12
05.06.13

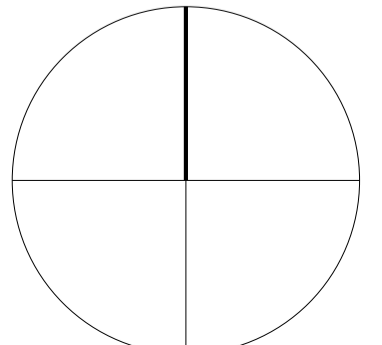
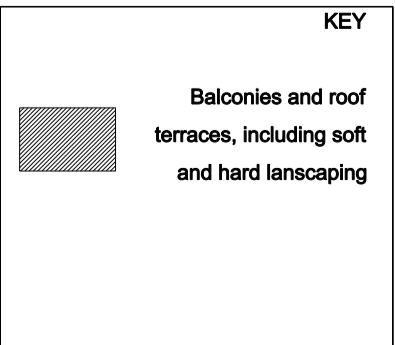
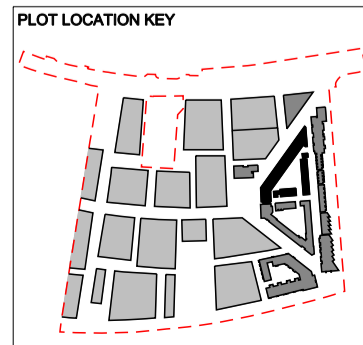

FeildenCleggBradleyStudios
LLP
Twenty
Tottenham Street
London
W1T 4RF
t 020 73235737
f 020 73235720
e london@fcbsstudios.com

P1 - PLANNING ISSUE SEPTEMBER 2011
Amendment Date

MINOCO PLOT DESIGN Job/Drawing No Amendment
Plot 05 Sixth Floor Plan DPA-05-106 P1

Client Scale 1:250 (1:500 @ A3)
Clearstorm Limited and Heracles Limited Date September 2011
both wholly owned subsidiaries of Drawn TM / ME
Ballymore Group

Do not scale Original printed at A1
All dimensions to be checked on site



P1 - PLANNING ISSUE **SEPTEMBER 2011**
 Amendment Date

MINOCO PLOT DESIGN Job/Drawing No Amendment
 Plot 05 Seventh Floor Plan **DPA-05-107** **P1**

Client Scale 1:250 (1:500 @ A3)
 Clearstorm Limited and Heracles Limited Date September 2011
 both wholly owned subsidiaries of Drawn TM / ME
 Ballymore Group

Do not scale Original printed at A1
 All dimensions to be checked on site

KEY

Balconies and roof terraces, including soft and hard landscaping

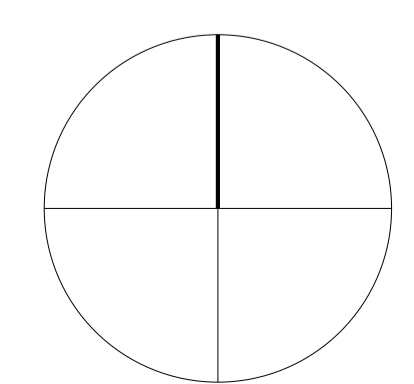

FeildenCleggBradleyStudios
LLP
 Twenty
 Tottenham Street
 London
 W1T 4RF
 t 020 73235737
 f 020 73235720
 e london@fcbstudios.com



PLOT 06

PLOT 03

PLOT 04

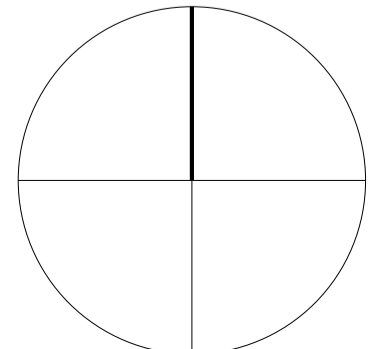
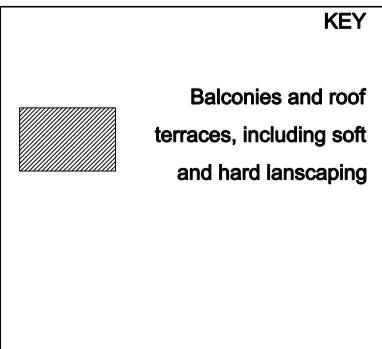
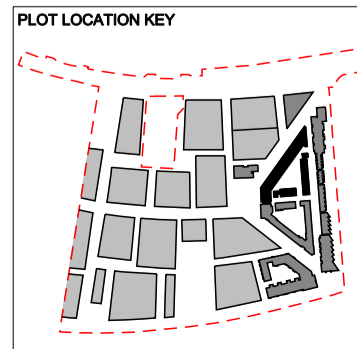

FeildenCleggBradleyStudios
LLP
Twenty
Tottenham Street
London
W1T 4RF
t 020 73235737
f 020 73235720
e london@fcbstudios.com

P1 - PLANNING ISSUE SEPTEMBER 2011
Amendment Date

MINOCO PLOT DESIGN Job/Drawing No Amendment
Plot 05 Eighth Floor Plan DPA-05-108 P1

Client Scale 1:250 (1:500 @ A3)
Clearstorm Limited and Heracles Limited Date September 2011
both wholly owned subsidiaries of Drawn TM / ME
Ballymore Group

Do not scale Original printed at A1
All dimensions to be checked on site



P1 - PLANNING ISSUE SEPTEMBER 2011
 Amendment Date

MINOCO PLOT DESIGN Job/Drawing No Amendment
 Plot 05 Roof Plan DPA-05-109 P1

Client Scale 1:250 (1:500 @ A3)
 Clearstorm Limited and Heracles Limited Date September 2011
 both wholly owned subsidiaries of Ballymore Group Drawn TM / ME

Do not scale Original printed at A1
 All dimensions to be checked on site

FeildenCleggBradleyStudios
 LLP
 Twenty
 Tottenham Street
 London
 W1T 4RF
 t 020 73235737
 f 020 73235720
 e london@fcbstudios.com

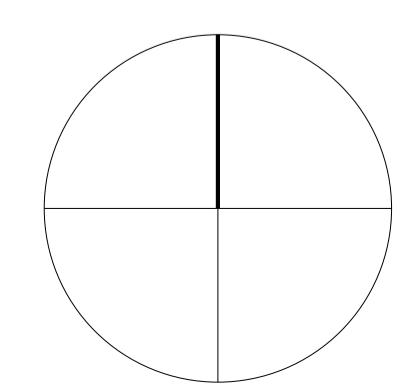
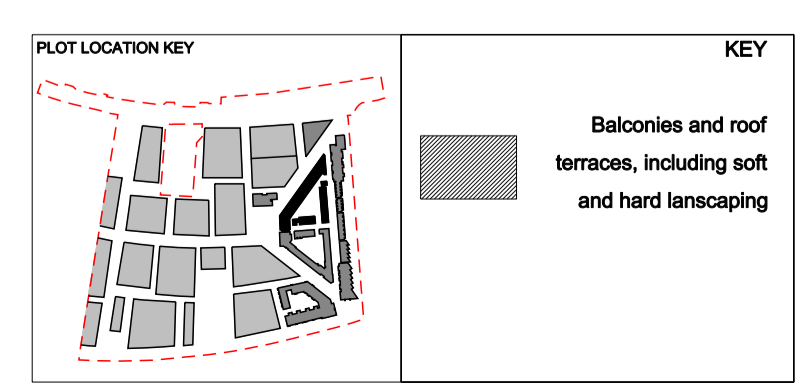

- 01 BRICK
- 02 FULL HEIGHT GLAZING
- 03 CAR PARK ENTRANCE
- 04 METAL BALUSTRADE
- 05 GLASS BALUSTRADE
- 06 JULIET BALCONY WITH GLASS BALUSTRADE
- 07 RECONSTITUTED STONE
- 08 METAL INFILL PANEL
- 09 METAL LOUVERS
- 10 LOUVERED DOORS
- 11 PRIVACY SCREEN
- 12 TIMBER CLADDING
- 13 METAL CLAD CANOPY
- 14 RAIN WATER DOWNPIPE
- 15 FLUE

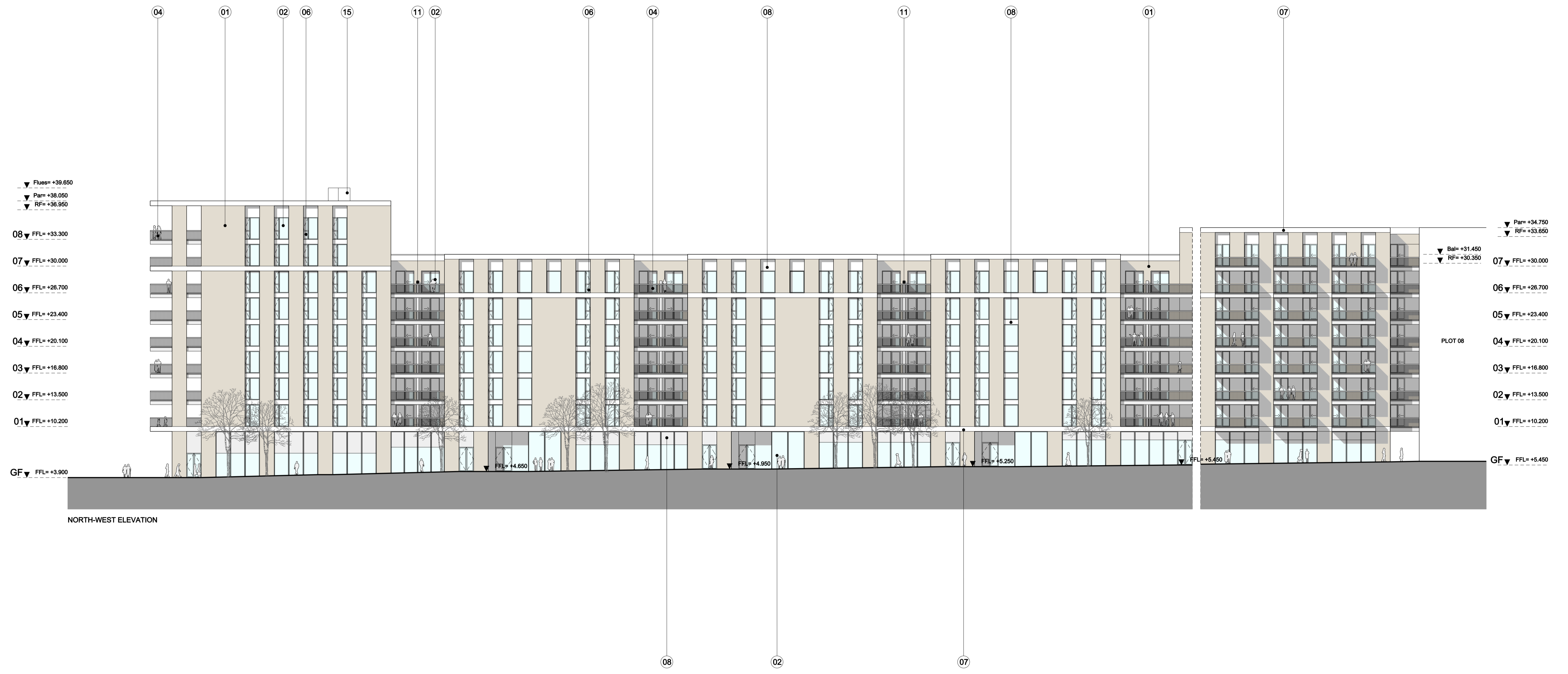

NORTH-WEST ELEVATION

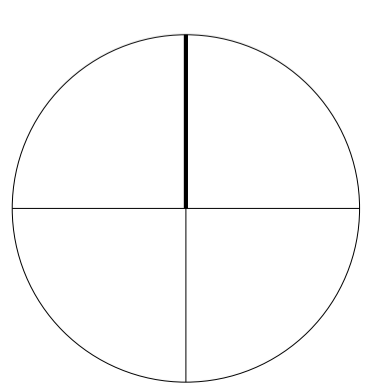
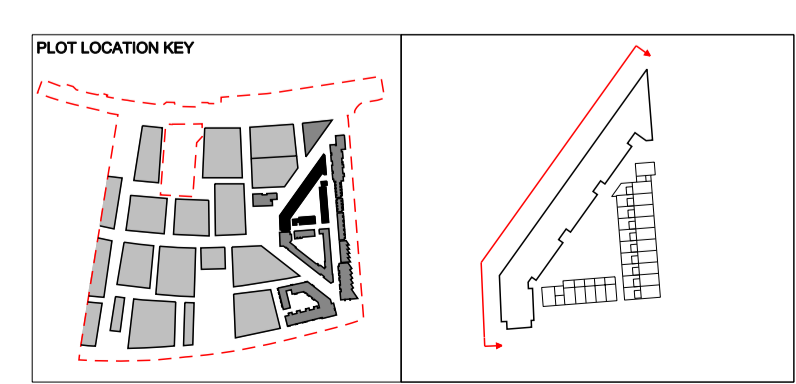

FeildenCleggBradleyStudios
 LLP
 Twenty
 Tottenham Street
 London
 W1T 4RF
 t 020 73235737
 f 020 73235720
 e london@fcbstudios.com

P1 - PLANNING ISSUE SEPTEMBER 2011
 Amendment Date
MINOCO PLOT DESIGN
 Plot 05 North-West Elevation
 Client: Clearstorm Limited and Heracles Limited
 both wholly owned subsidiaries of Ballymore Group
 Do not scale
 Original printed at A1

Job/Drawing No: DPA-05-200 Amendment P1
 Scale: 1:250 (1:500 @ A3)
 Date: September 2011
 Drawn: TM / ME
 All dimensions to be checked on site

- 01 BRICK
- 02 FULL HEIGHT GLAZING
- 03 CAR PARK ENTRANCE
- 04 METAL BALUSTRADE
- 05 GLASS BALUSTRADE
- 06 JULIET BALCONY WITH GLASS BALUSTRADE
- 07 RECONSTITUTED STONE
- 08 METAL INFILL PANEL
- 09 METAL LOUVERS
- 10 LOUVERED DOORS
- 11 PRIVACY SCREEN
- 12 TIMBER CLADDING
- 13 METAL CLAD CANOPY
- 14 RAIN WATER DOWNPIPE
- 15 FLUE



EAST ELEVATION

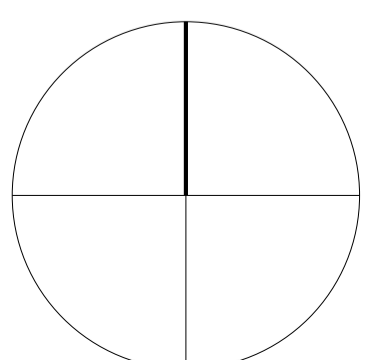
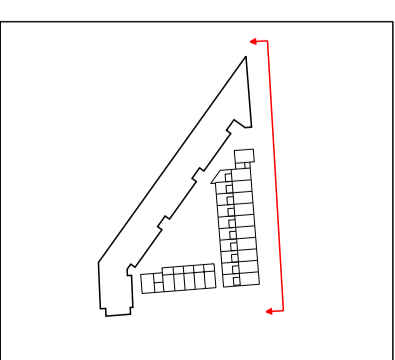
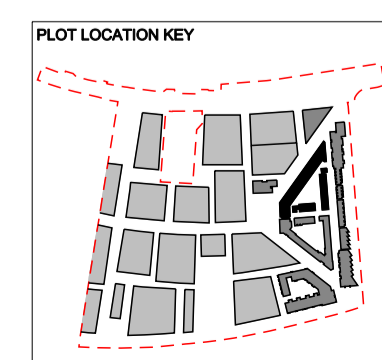

FeildenCleggBradleyStudios
LLP
Twenty
Tottenham Street
London
W1T 4RF
t 020 73235737
f 020 73235720
e london@fcbstudios.com

P1 - PLANNING ISSUE SEPTEMBER 2011
Amendment Date
MINOCO PLOT DESIGN
Plot 05 East Elevation
Client: Clearstorm Limited and Heracles Limited both wholly owned subsidiaries of Ballymore Group
Scale: 1:250 (1:500 @ A3)
Date: September 2011
Drawn: TM / ME
Do not scale
Original printed at A1
Job/Drawing No: DPA-05-201
Amendment: P1
All dimensions to be checked on site

- 01 BRICK
- 02 FULL HEIGHT GLAZING
- 03 CAR PARK ENTRANCE
- 04 METAL BALUSTRADE
- 05 GLASS BALUSTRADE
- 06 JULIET BALCONY WITH GLASS BALUSTRADE
- 07 RECONSTITUTED STONE
- 08 METAL INFILL PANEL
- 09 METAL LOUVERS
- 10 LOUVERED DOORS
- 11 PRIVACY SCREEN
- 12 TIMBER CLADDING
- 13 METAL CLAD CANOPY
- 14 RAIN WATER DOWNPIPE
- 15 FLUE

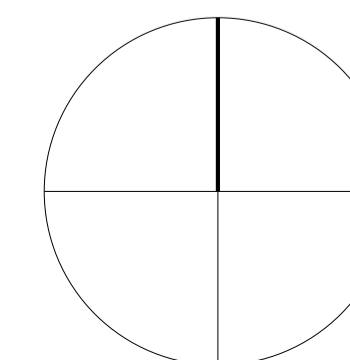
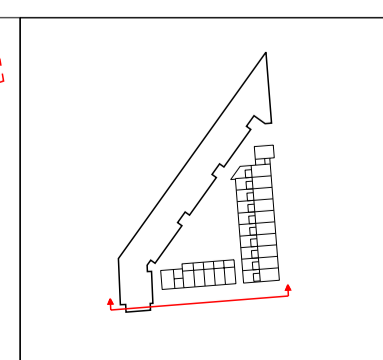
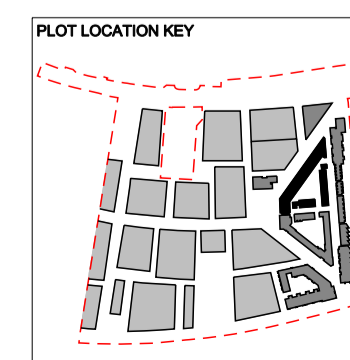

FeildenCleggBradleyStudios
LLP
Twenty
Tottenham Street
London
W1T 4RF
t 020 73235737
f 020 73235720
e london@fcbstudios.com

P1 - PLANNING ISSUE SEPTEMBER 2011
Amendment Date
MINOCO PLOT DESIGN Job/Drawing No Amendment
Plot 05 South Elevation DPA-05-202 P1
Client Scale 1:250 (1:500 @ A3)
Clearstorm Limited and Heracles Limited Date September 2011
both wholly owned subsidiaries of Ballymore Group Drawn TM / ME
Do not scale All dimensions to be checked on site
Original printed at A1

- 01 BRICK
- 02 FULL HEIGHT GLAZING
- 03 CAR PARK ENTRANCE
- 04 METAL BALUSTRADE
- 05 GLASS BALUSTRADE
- 06 JULIET BALCONY WITH GLASS BALUSTRADE
- 07 RECONSTITUTED STONE
- 08 METAL INFILL PANEL
- 09 METAL LOUVERS
- 10 LOUVERED DOORS
- 11 PRIVACY SCREEN
- 12 TIMBER CLADDING
- 13 METAL CLAD CANOPY
- 14 RAIN WATER DOWNPIPE
- 15 FLUE

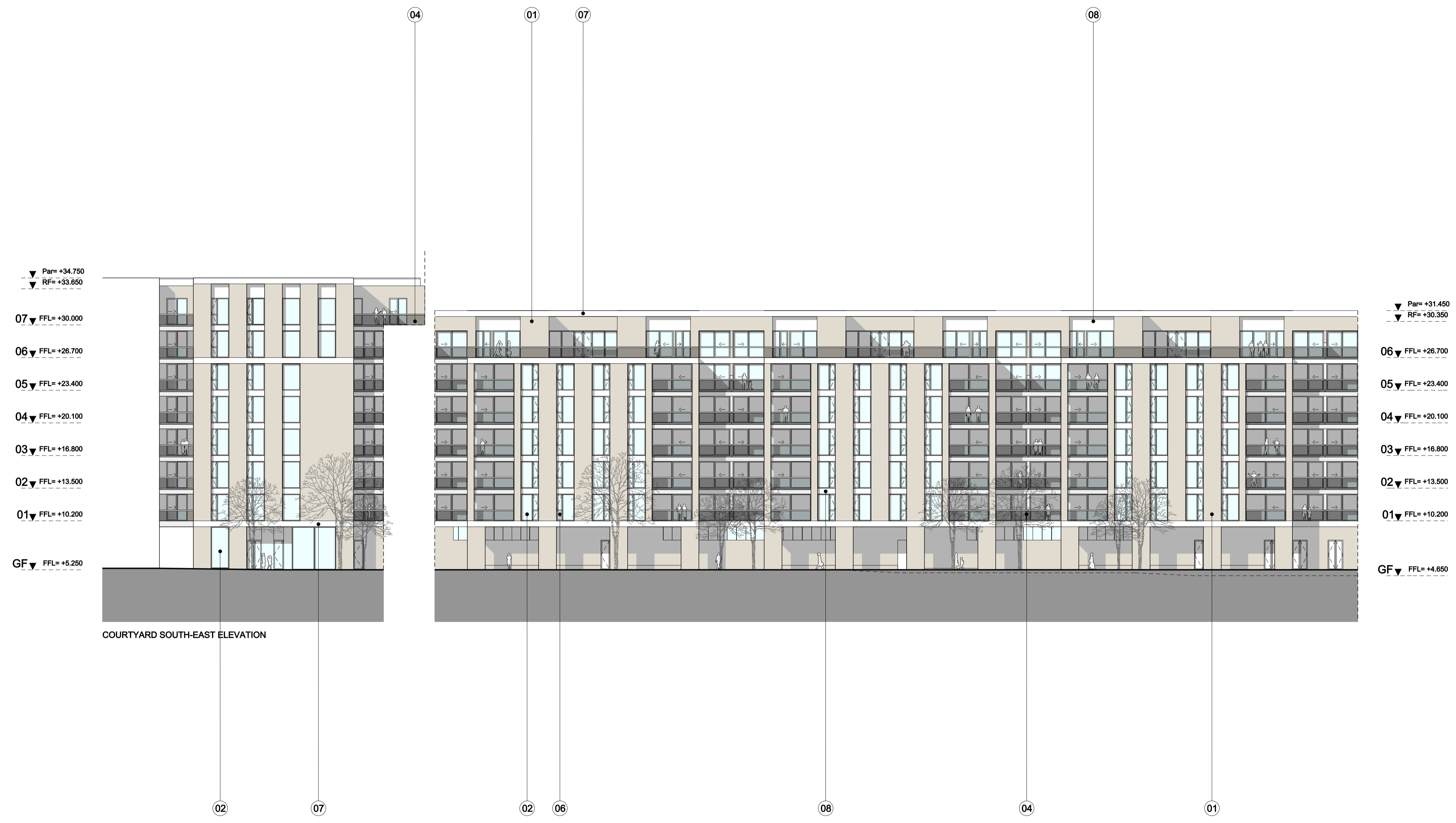

COURTYARD SOUTH-EAST ELEVATION

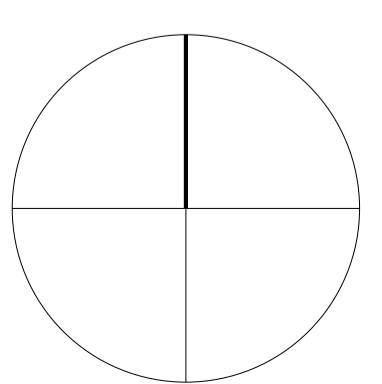
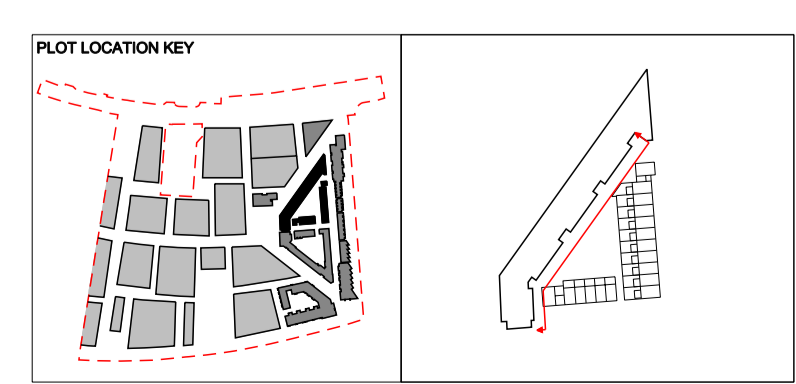

FeildenCleggBradleyStudios
LLP
Twenty
Tottenham Street
London
W1T 4RF
t 020 73235737
f 020 73235720
e london@fcbstudios.com

P1 - PLANNING ISSUE SEPTEMBER 2011
Amendment Date
Job/Drawing No Amendment
DPA-05-203 P1
Client
Clearstorm Limited and Heracles Limited
both wholly owned subsidiaries of
Ballymore Group
Scale 1:250 (1:500 @ A3)
Date September 2011
Drawn TM / ME
Do not scale
All dimensions to be checked on site
Original printed at A1

- 01 BRICK
- 02 FULL HEIGHT GLAZING
- 03 CAR PARK ENTRANCE
- 04 METAL BALUSTRADE
- 05 GLASS BALUSTRADE
- 06 JULIET BALCONY WITH GLASS BALUSTRADE
- 07 RECONSTITUTED STONE
- 08 METAL INFILL PANEL
- 09 METAL LOUVERS
- 10 LOUVERED DOORS
- 11 PRIVACY SCREEN
- 12 TIMBER CLADDING
- 13 METAL CLAD CANOPY
- 14 RAIN WATER DOWNPIPE
- 15 FLUE



COURTYARD WEST ELEVATION CUTTING THROUGH HOUSE COURTYARDS



COURTYARD WEST ELEVATION

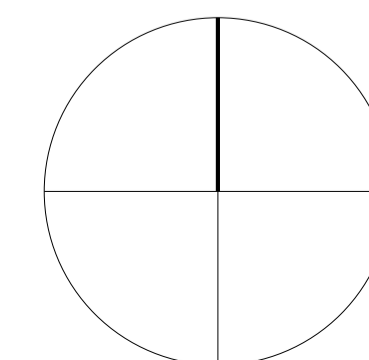
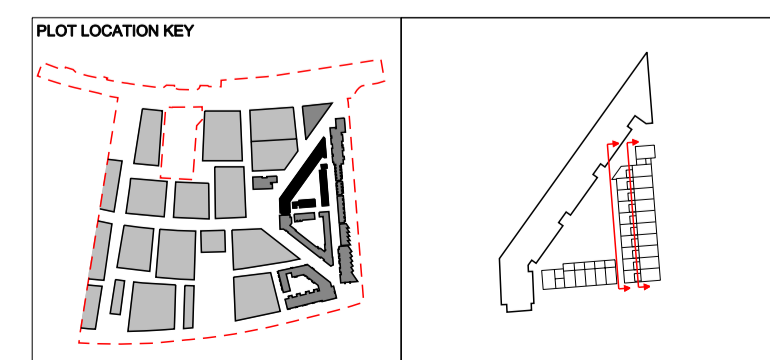

FeildenCleggBradleyStudios
LLP
Twenty
Tottenham Street
London
W1T 4RF
t 020 73235737
f 020 73235720
e london@fcbstudios.com

P1 - PLANNING ISSUE SEPTEMBER 2011
Amendment Date
Job/Drawing No Amendment
DPA-05-204 P1
Client Scale 1:250 (1:500 @ A3)
Clearstorm Limited and Heracles Limited Date September 2011
both wholly owned subsidiaries of Ballymore Group Drawn TM / ME
Do not scale All dimensions to be checked on site
Original printed at A1

- 01 BRICK
- 02 FULL HEIGHT GLAZING
- 03 CAR PARK ENTRANCE
- 04 METAL BALUSTRADE
- 05 GLASS BALUSTRADE
- 06 JULIET BALCONY WITH GLASS BALUSTRADE
- 07 RECONSTITUTED STONE
- 08 METAL INFILL PANEL
- 09 METAL LOUVERS
- 10 LOUVERED DOORS
- 11 PRIVACY SCREEN
- 12 TIMBER CLADDING
- 13 METAL CLAD CANOPY
- 14 RAIN WATER DOWNPIPE
- 15 FLUE

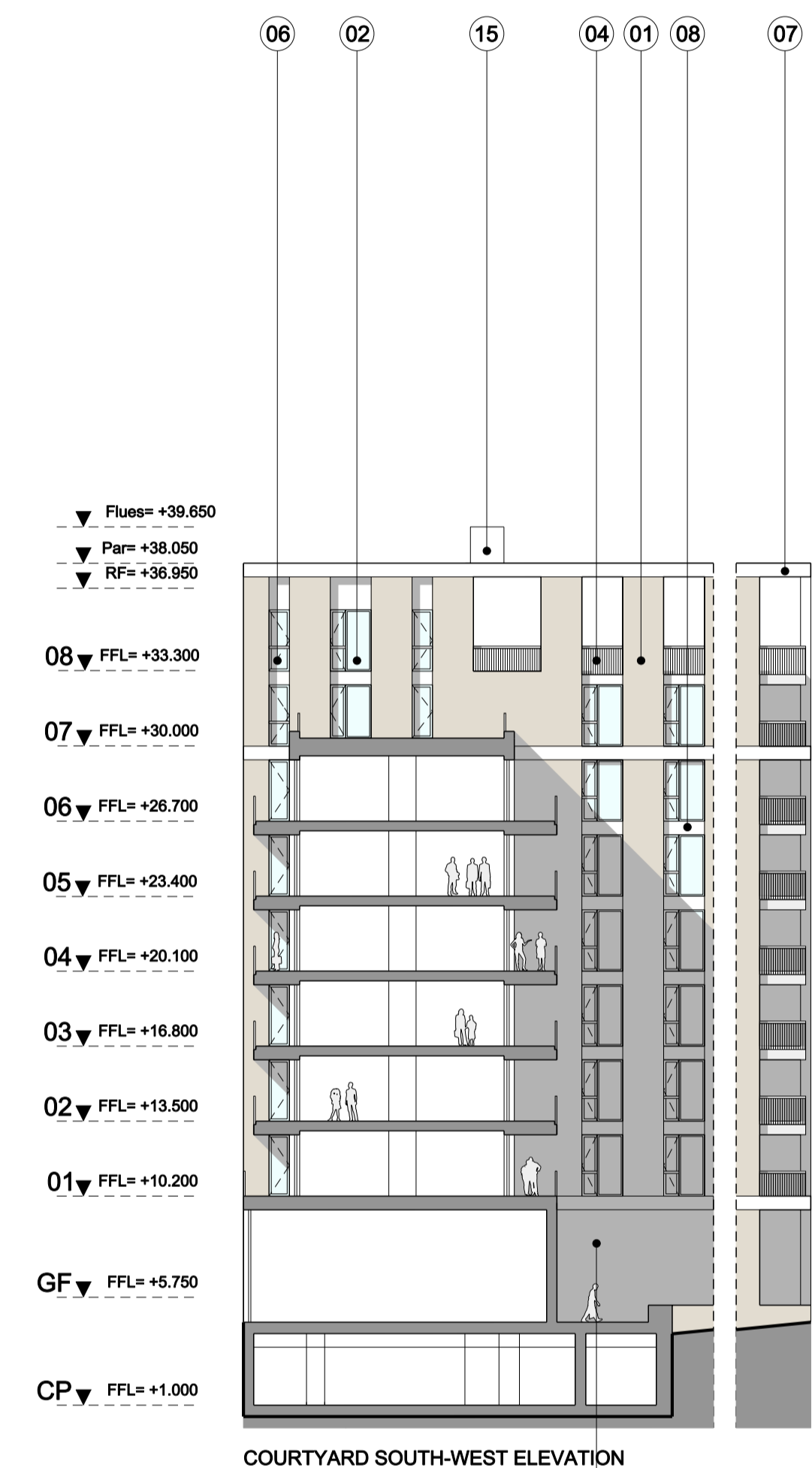
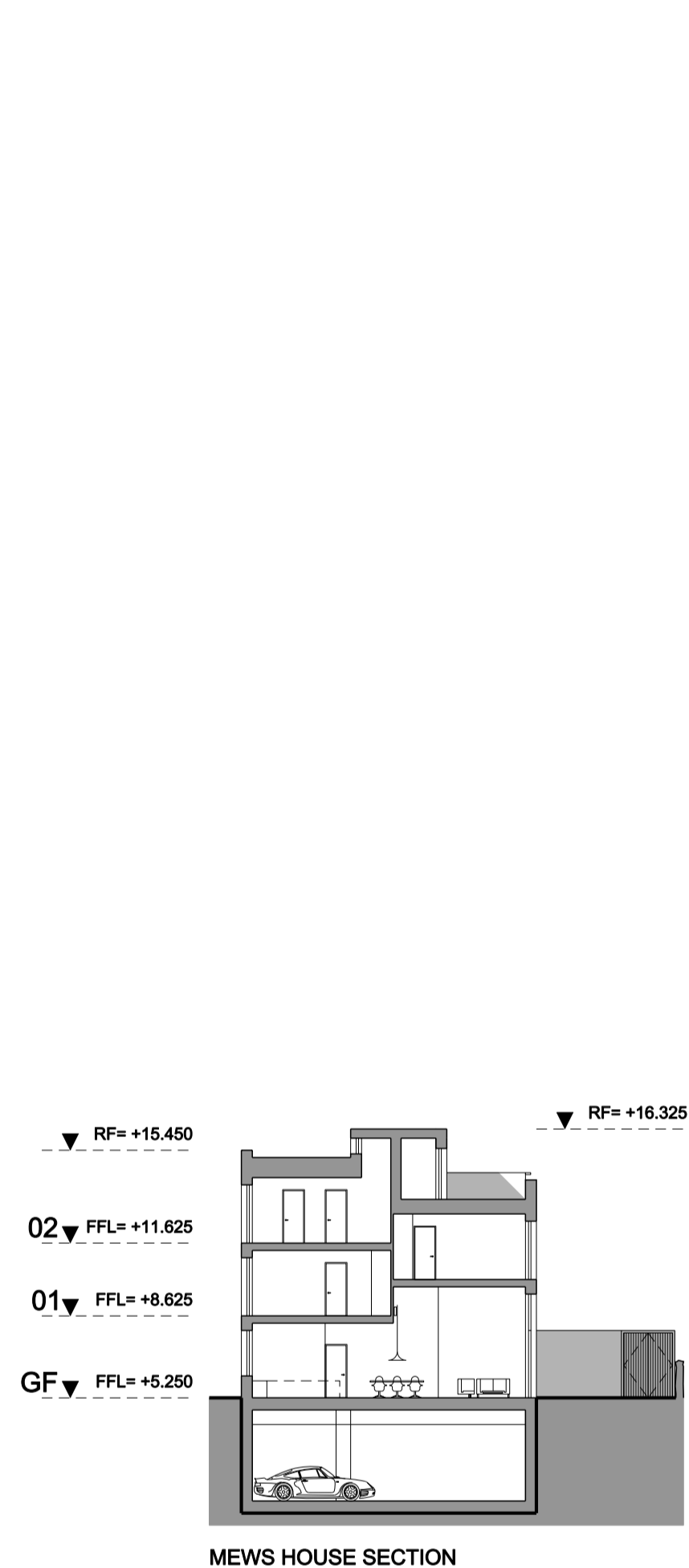

COURTYARD NORTH ELEVATION

MEWS HOUSE SECTION

COURTYARD SOUTH-WEST ELEVATION

01 02 06 12 14 02 04

07

01

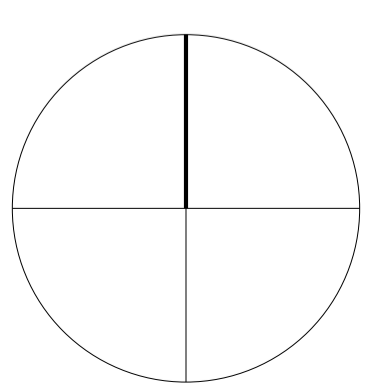
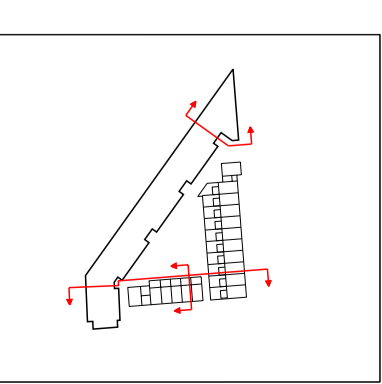
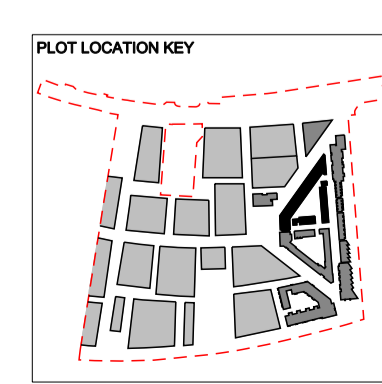

FeildenCleggBradleyStudios
LLP
Twenty
Tottenham Street
London
W1T 4RF
t 020 73235737
f 020 73235720
e london@fcbstudios.com

P1 - PLANNING ISSUE SEPTEMBER 2011
Amendment Date
Job/Drawing No Amendment P1
DPA-05-205
Scale 1:250 (1:500 @ A3)
Date September 2011
Drawn TM / ME
All dimensions to be checked on site
Original printed at A1

MINOCO PLOT DESIGN
Plot 05 Courtyard North Elevation,
Mews House Section and
Courtyard South-West Elevation
Client
Clearstorm Limited and Heracles Limited
both wholly owned subsidiaries of
Ballymore Group
Do not scale

- | | | | |
|----|--------------------------------------|----|---------------------|
| 01 | BRICK | 09 | METAL LOUVERS |
| 02 | FULL HEIGHT GLAZING | 10 | LOUVERED DOORS |
| 03 | CAR PARK ENTRANCE | 11 | PRIVACY SCREEN |
| 04 | METAL BALUSTRADE | 12 | TIMBER CLADDING |
| 05 | GLASS BALUSTRADE | 13 | METAL CLAD CANOPY |
| 06 | JULIET BALCONY WITH GLASS BALUSTRADE | 14 | RAIN WATER DOWNPIPE |
| 07 | RECONSTITUTED STONE | 15 | FLUE |
| 08 | METAL INFILL PANEL | | |

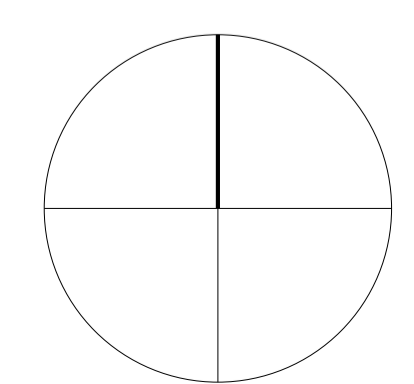
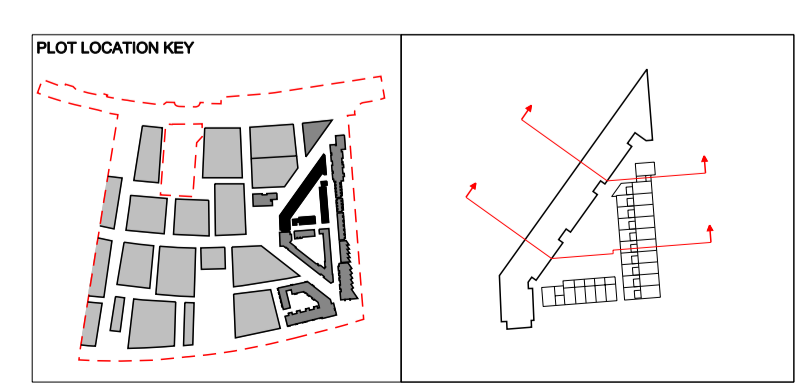
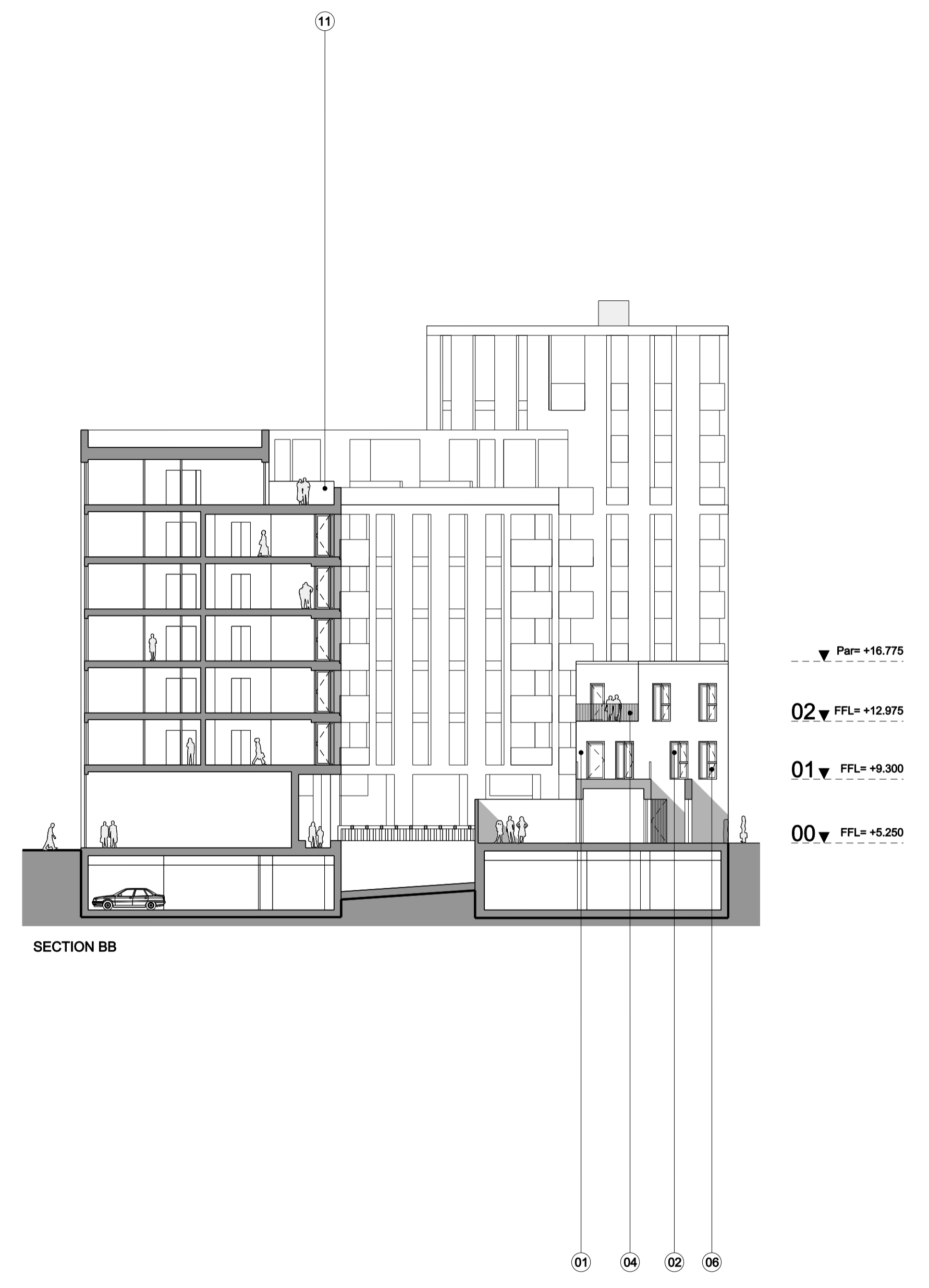
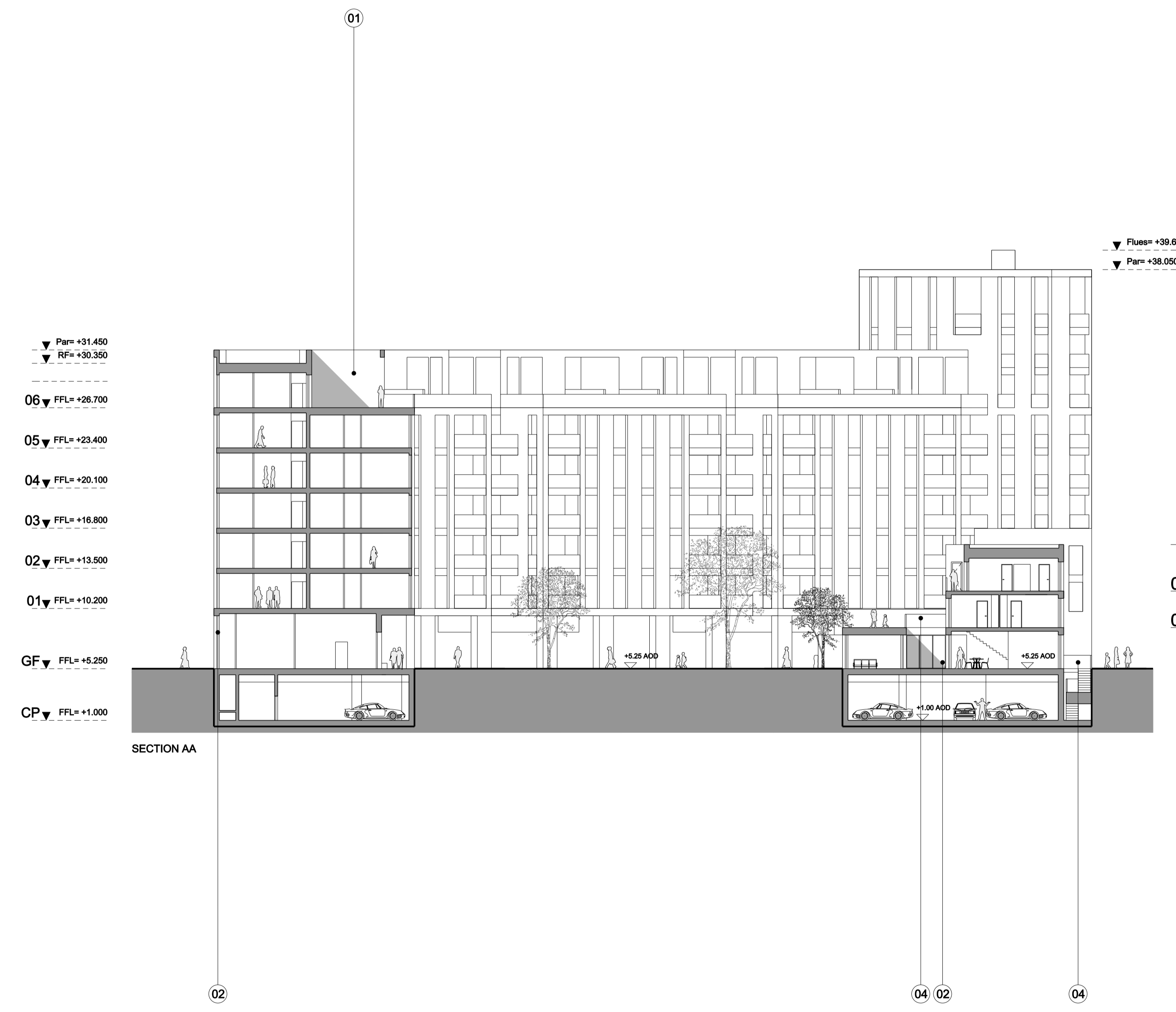

FeildenCleggBradleyStudios
 LLP
 Twenty
 Tottenham Street
 London
 W1T 4RF
 t 020 73235737
 f 020 73235720
 e london@fcbstudios.com

P1 - PLANNING ISSUE **SEPTEMBER 2011**
 Amendment Date
MINOCO PLOT DESIGN
 Plot 05 Sections AA and BB
 Client: Clearstorm Limited and Heracles Limited
 both wholly owned subsidiaries of
 Ballymore Group
 Do not scale
 Original printed at A1

Job/Drawing No: **DPA-05-300** Amendment: **P1**
 Scale: 1:250 (1:500 @ A3)
 Date: September 2011
 Drawn: TM / ME
 All dimensions to be checked on site

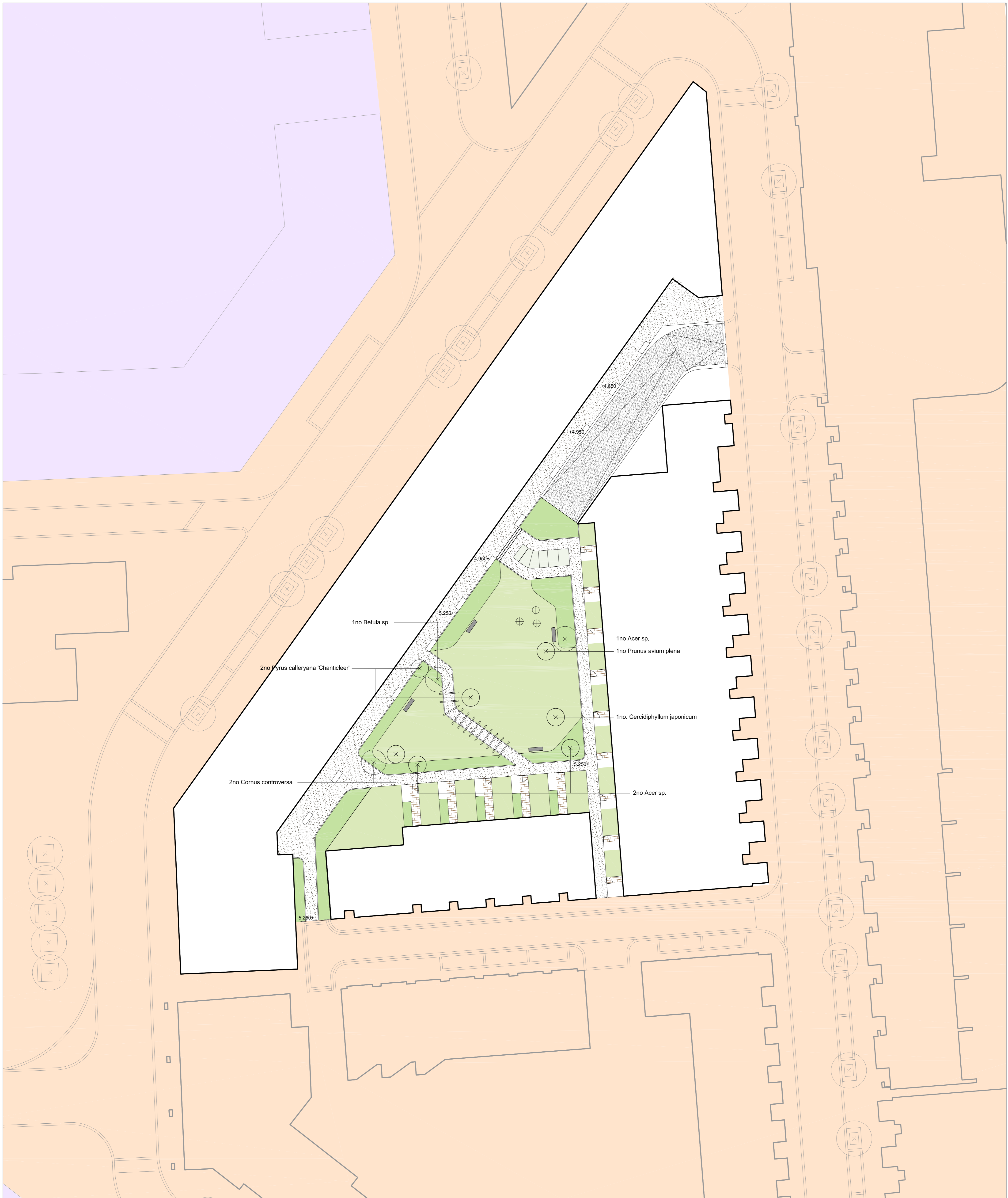

KEY	
	RESIN-BOUND GRAVEL
	SELF BINDING GRAVEL
	KITCHEN GARDENS
	DETAILED AREA
	KERB ALONG GARDEN PATHS
	BENCH SEATING
	MEADOW PLANTING
	OUTLINE AREA
	PERGOLA
	CHILDRENS PLAY ELEMENT
	PROPOSED TREE
	PROPOSED LEVEL
	PAVING
	LAWN
	EXISTING LEVEL
	CONCRETE
	SHRUB AND HERBACEOUS PLANTING
	EXISTING NORTH WOOLWICH ROAD LANDSCAPE TO BE RETAINED
	NORTH WOOLWICH ROAD

- GENERAL NOTES**
1. Do not scale drawing.
 2. All setting out, levels and dimensions to be agreed on site.
 3. The dimensions of all materials must be checked on site before being laid out.
 4. This drawing must be read with the relevant specification clauses and detail drawings.
 5. Order of construction and setting out to be agreed on site.

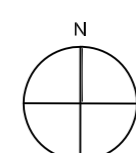
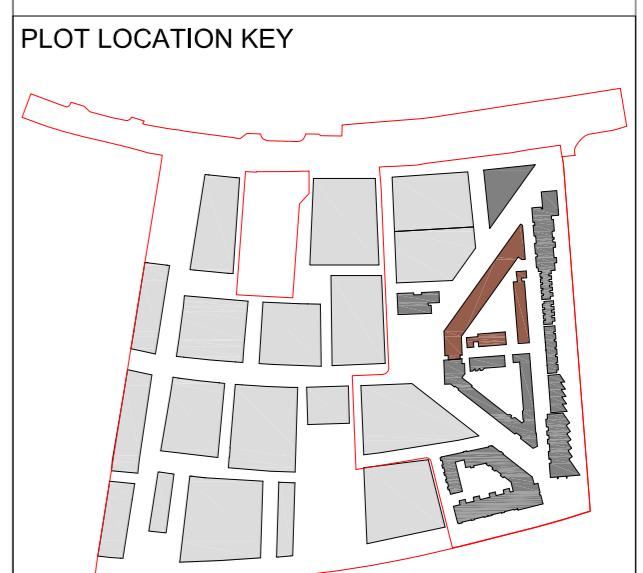

Project MINOCO	Drawing Title PLOT 5 LANDSCAPE FINISHES PLAN	Revision R01 - Minor Amendments	Date 15/09/11	Client: Ballymore Group Address: Pointe North 3 Greenwich View Place London E14 9NN	Consultant TOWNSHEND Landscape Architects Unit 3A Zetland House London EC2A 4HD Telephone: 020 7729 9333 Fax: 020 7729 3300 E-Mail: info@townshend.co.uk	Project No. 465.1	Scale 1:250 1:500 @ A3	Approved By MA	Drawing No. DPA-05-900	Revision R01
						Date SEP 2011	Drawing Size A1	Drawn By MIC		

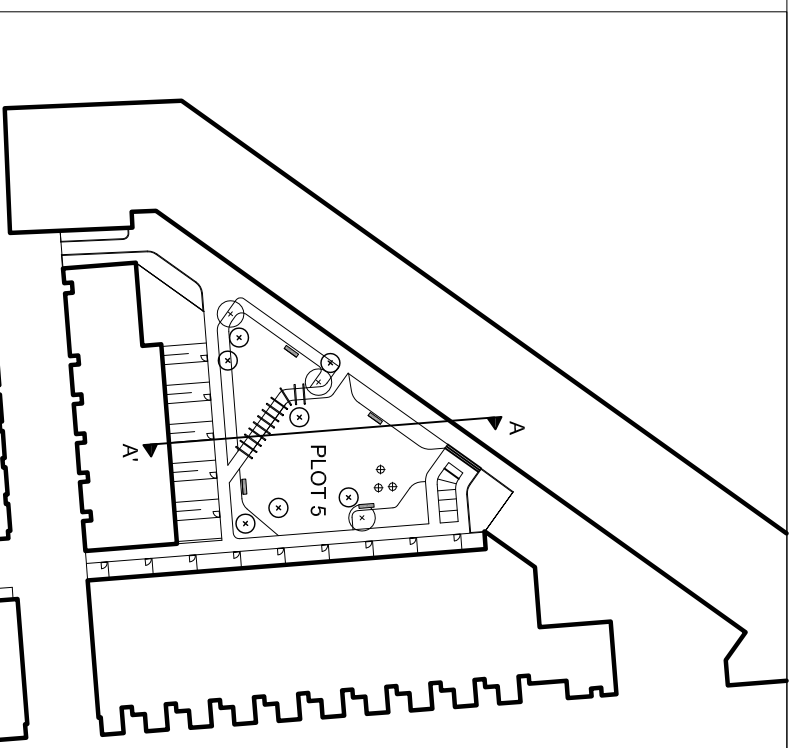
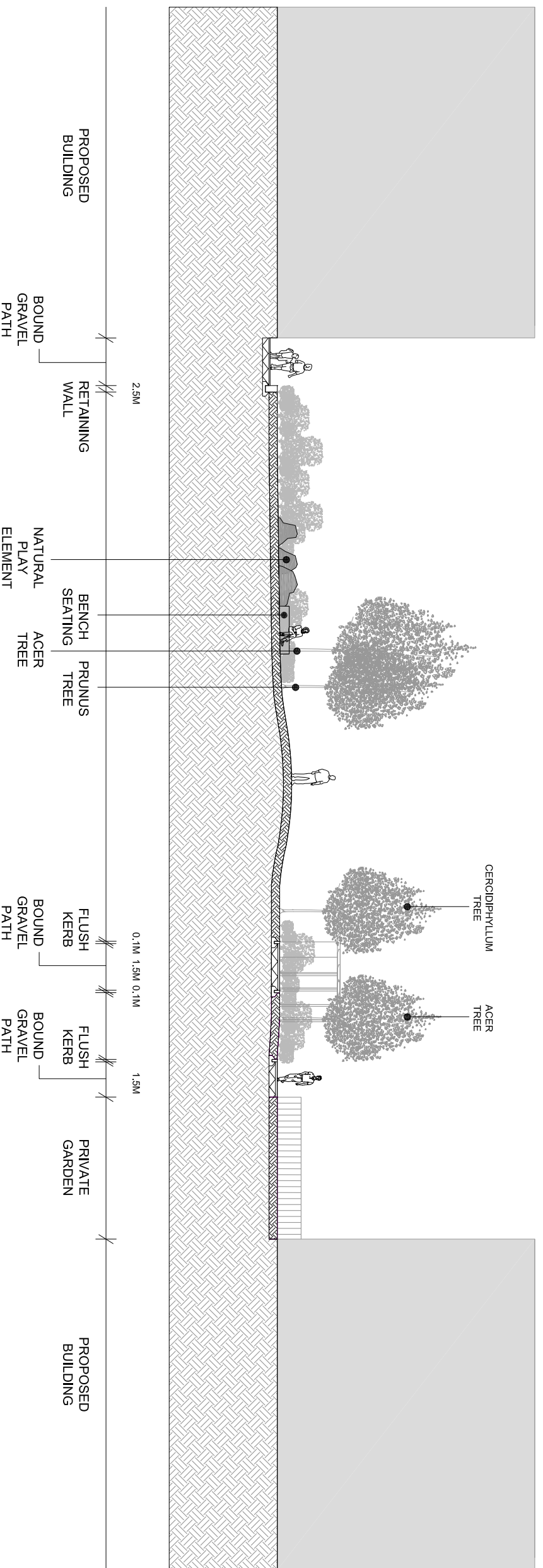

Project
MINOCO PHASE 1

Client
BALLYMORE GROUP

Drawing Title
SECTION A - A'
PLOT 5

Revision	Date
R00 - First Issue	



Consultant
TOWNSHEND
 Landscape Architects
 Unit 3A Zealand House
 London EC2A 4HJ
 Telephone: 020 7729 9333 Fax: 020 7729 3300
 E-Mail: tk@townshenda.com

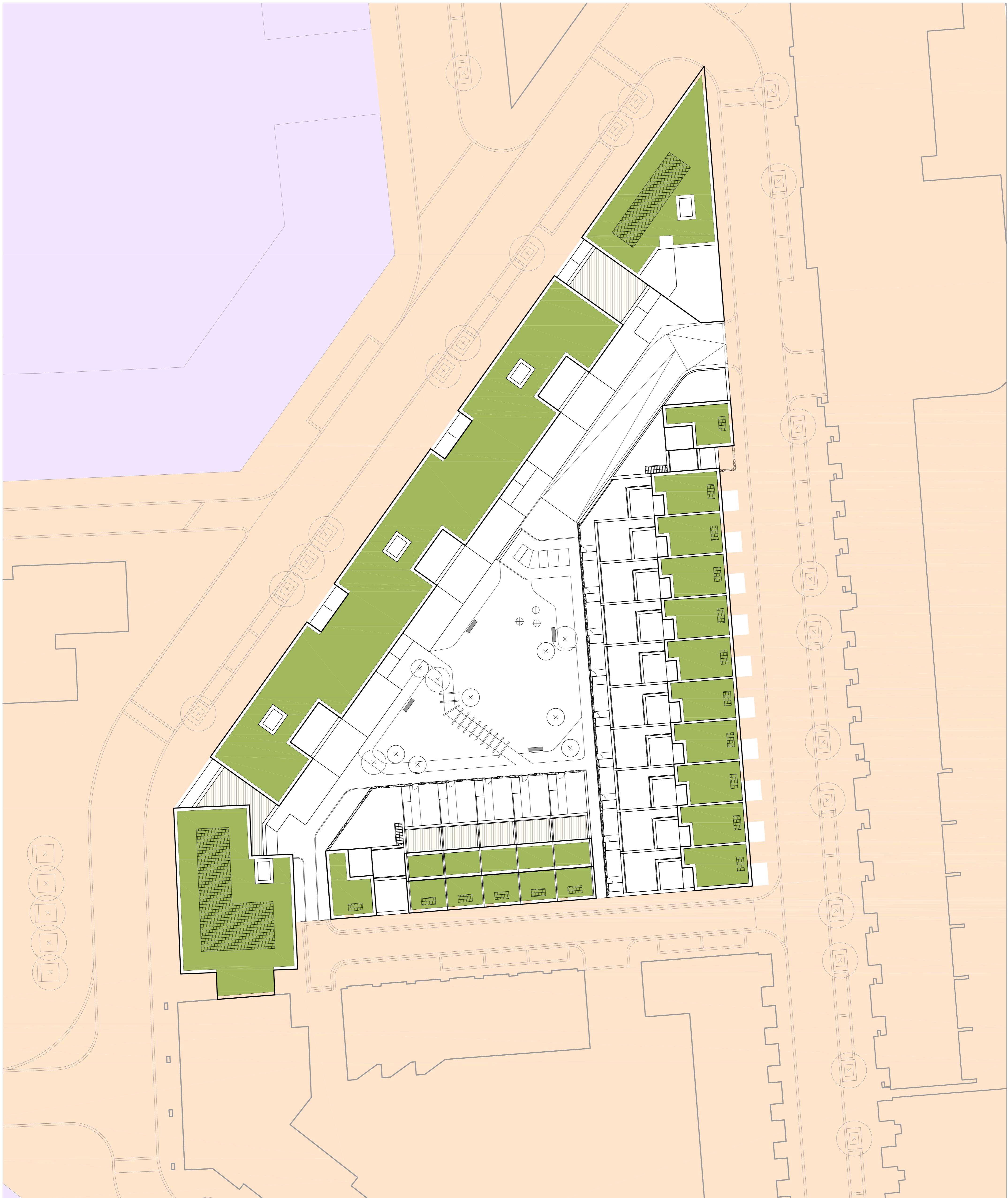

Project No. 465.1	Scale 1:200@A3	Approved By MA	Drawing No. R00
Date AUG 11	Drawing Size A3	Drawn By MIC	Revision DPA-05-901

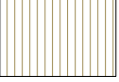

KEY

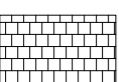
	ROOF TERRACE
	GREEN AND BROWN ROOFS
	GREEN AND BROWN ROOFS

- GENERAL NOTES**
1. Do not scale drawing.
 2. All setting out, levels and dimensions to be agreed on site.
 3. The dimensions of all materials must be checked on site before being laid out.
 4. This drawing must be read with the relevant specification clauses and detail drawings.
 5. Order of construction and setting out to be agreed on site.

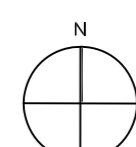
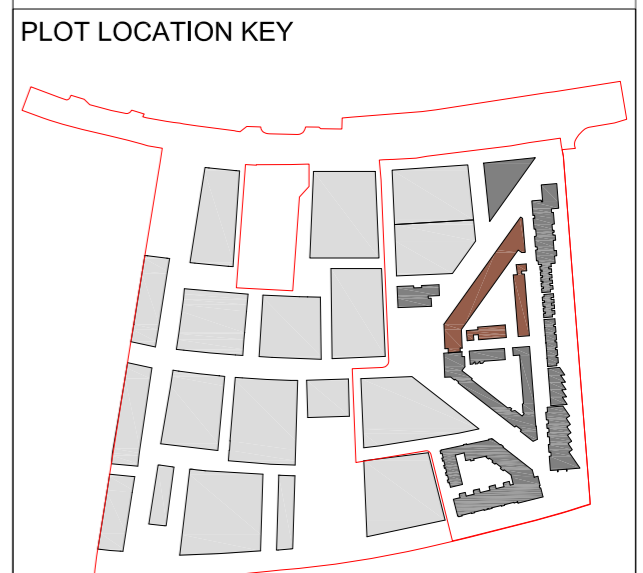

Project MINOCO	Drawing Title PLOT 5 LANDSCAPE ROOF PLAN	Revision R01 - Minor Amendments	Date 15/09/11	Client: Ballymore Group Address: Pointe North 3 Greenwich View Place London E14 9NN	Consultant TOWNSHEND Landscape Architects Unit 3A Zetland House London EC2A 4HD Telephone: 020 7729 9333 Fax: 020 7729 3300 E-Mail: ta@townshend.co.uk	Project No. 465.1	Scale 1:250 1:500 @ A3	Approved By MA	Drawing No. DPA-05-902	Revision R01
						Date SEP 2011	Drawing Size A1	Drawn By MIC		

Dimensions to be verified on site.
Rigged dimensions to take precedence to those scaled.
Any areas indicated on this drawing are for guidance only.
No responsibility is taken for their accuracy.