



# PIONEER

Vol I, No. 22

Amache, Colorado

January 9, 1943

## CO-OP IN MEMBERSHIP DRIVE

### FANSLAN REPORTS

#### AMACHE TEACHERS DO WELL AT NAVY SCHOOL

Amache still shows the greatest percentage among the centers in response to the positions offered by the Naval language school, stated Registrar Lewis W. Fanslan, who returned from Boulder this week. He was accompanied by Kay Sugahara of the employment office.

Six more teachers from the center joined the first group and six more are soon to follow.

"The instructors and their families are doing much to create a high respect for the evacuees with their excellent deportment, personality, and grooming," Fanslan reported.

#### SHARES TO GO ON SALE

A charter membership drive for the community enterprises starts Monday and will continue through Thursday, Jan. 21, E. H. Runcorn, associate community enterprise superintendent, announced Thursday.

Shares will be sold at \$5 each and an individual will be allowed a limit of 20 shares.

The center has been divided into seven teams, and the progress of each team, showing the increase in the number of charter members and capital stock, will be denoted on thermometer charts.

Beginning Monday and ending Friday, an explanation of the temporary community enterprises and the cooperative association which will be organized by the charter members will be made by two representatives of each team.

Application cards for membership and the proposed by-laws in both English and Japanese will be distributed at the block meetings.

The seven teams and their representatives are as follows.

Team 1: 7G, 8G, 8F, 7F, 11E--Runcorn and F. Konno.  
Team 2: 6H, 6G, 7H, 7E, 8E--T. Domoto and T. Nishizaki.

Team 3: 6E, 6F, 11K, 10H, 12K--M. Naruse and T. Saito.  
Team 4: 9H, 9L, 9K, 8K, 7K--T. Shima and B. Kawashima.

Team 5: 10E, 12G, 9E, 11F, 12E--K. Iki and A. Kajioaka.

Team 6: 11H, 12H, 11G, 12F--N. Kurita and F. Tsuchiya.

Team 7: Administrative personnel--W. Ray Johnson and Dell Love.

#### NEW MOVIE SCHEDULED

"Melody for Three," starring Jean Hersholt and Fay Wray, will be screened for the residents of Blocks 7G and 8G at the 7G mess hall and for the people of Blocks 7F and 8F at the 7F mess hall tomorrow at 7 p.m.

The picture is a Dr. Christian story with a musical background and centers around the activity of a Chicago broadcasting studio. The highlight of the film is the playing of Brahms Hungarian Dance No. 5 by a 75-piece orchestra with a guest soloist.

The movie will be shown according to the schedule followed last week except that it will be moved to the other mess hall.

Tickets are available at the block information offices. Five cents will be charged for children under 15 years and 10 cents for adults.

#### Three WRA Officials Visit

Three officials of the WRA are visiting in the center this week.

They are Donald R. Stein, assistant chief of the employment division of the Washington office; M. O. Anderson, employment officer in the Denver office; and Richard Bennets of the Denver office.

Bennets is particularly interested in speeding the school construction work.

#### Job Offers To Be Listed

Evacuees intending to take up any one of the employment offers posted in the placement office should ask to include the offer with their leave clearance applications as it will hurry the leave process, said Placement Officer Walter J. Knodel.

#### LEASES OFFERED HERE

Center residents interested in leasing land in this vicinity on a cash-rent, or crop-rent basis are requested to come in and register with Junior Placement Officer Mario Verchio at the former con-

tractor's building, announced Placement Officer Walter J. Knodel.

Opportunities are offered in fruit, truck, or general farming by substantial and trustworthy farmers in Colorado, added Knodel.



BY TAKIE KUSUNOKI

Blame the following guff on Guest Columnist Josephine Patrio-la Ide, an admitted authority on Wimin. So, gentle reader(s), here comes Joe to talk for me:

Never trust a woman, my pappy told me. He did and got hitched. I did and here I am writing a woman's column...Heaven forbid!

Yambo Yamazumi of the loud mouth and stone face breezed into the canteen the other day and purchased a lighter from kewpie-faced Salesgirl Fumi Fukuda. The gadget didn't work...Yambo beefed. Fumi offered consolation and advice: "Here's a match," she cooed, "you're supposed to light the lighter first and warm it up." And she meant it!

Sumi Kawamura, hefty songbird, homeward bound from 9K one dark night, fell into a gully. Now there are two gulleys.

Chum Hiroshi Ito reminds us that there is a definite improvement in the attitude of the students towards school. At first the cry was, "To 'el with the d--- school!" But now it's, "To heck with this darn dump!" Happy teachers gurgled: "We are so pleased, we could scream."

"Sea gulls cry goo, goo, goo, and fly sly--ah, I shall explain the meaning of the word fly. You fly a chicken in the pan, you fly a dove of peace." So opened a New Year's eve discourse on sea gulls by Professor Tosh Ninomiya, who remembers nothing.

A youngster entered the V & X (five and ten to you) and asked for tooth powder. Naoko Kajioke, smilingly, handed him a "new brand." A few hours later, the kid returned; wanted his money back complaining the powder burned his mouth. Naoko didn't understand--until she saw the brand. It was Dental Plate Cleanser.

One thing about Jeanie Tanaka, she's even tempered, said a friend. "Yeah," says we, "always mad." And who said she wasn't stubborn?

## ART CLASS NOT CLOSED

A number of students enrolled in the recreation department's Art studio have failed to attend the classes, the Art studio declared last week.

A misunderstanding may have occurred when the night school's Art studio stated that there would be no classes until further notice.

Those who have been attending classes in the 7E recreation hall are urged to return.

Students and instructors of the Art studio will hold a tea party tomorrow at the 7E recreation hall at 6:30 p.m.

## Libraries

### Open Daily

The libraries at 8H-1F and 8H-5A-B will be open to the public every day of the week, according to the education department.

The hours are: Mondays through Fridays, 6:30 to 9 p.m.; Saturdays, 1 to 5 p.m.; and Sundays 2 to 4 p.m.

Michiko Sanui is head librarian at 8H-1F, while Mabel Andow is in charge at 8H-5A-B.

## WOMEN'S FEDERATION CHANGE MEETING DATES

Meetings of the Granada Women's federation shall henceforth be held on the first and third Thursdays of each month instead of weekly, it was decided by AMACHE BUSSEI MEET TOMORROW

An important meeting of the Amache YBA will follow the regular 2 p.m. service at the 7G Buddhist hall tomorrow, announces Rev. Tokuyasu Shirakawa.

### LIST BUDDHIST CHOIR PRATICE

Mary Watanabe and Yaeko Morita, directors, have announced the following schedule for Buddhist choir practices: every Tuesday from 6:30 to 7:30 p.m. and Saturdays from 1 to 2 p.m. at Buddhist church No. 1.

## NEW COURSES FOR ADULTS

Classes in textile art and interior decorating, and the new semester of the handicraft class began this week.

Textile art and interior decorating students meet on Mondays, Wednesdays, and Fridays from 1:30 to 4:15 p.m. at the 8K recreation hall, and on Tuesdays and Thursdays from 1:30 to 4:15 p.m. at the 12F recreation hall.

Evening classes convene on Mondays, Wednesdays, and Fridays, from 7 to 9:15 o'clock at 8H-6E. Shizue Watanabe is the instructor.

The handicraft group, under Mrs. Lily Sasaki, instructor, will meet at the adult education center from 6:30 to 9 p.m. on Mondays and Wednesdays; 9 to 11:30 a.m. and 1:30 to 4 p.m. on Tuesdays and Fridays; and 1:30 to 4 p.m. on Saturdays.

### 11E ADVISER

#### THANKS PUBLIC

In behalf of the residents of Block 11E, H. A. Saisho, adviser, expresses his thanks to the public for its cooperation in making the 11E talent show a success.

the members Thursday morning.

The next meeting will be held at 10 a.m. in the 11G recreation hall on Jan. 21. Co-chairman Mrs. Chizuyo Kanazawa requests that at least one representative from every block be present at the meeting to discuss several important matters.

### HAMAJI CHOSEN TO LEAD PLAY GROUP

Roy Hamaji was chosen president of the Amache Little Theater group at an election held recently.

Other officers are Kenji Okuda, vice president; Tasi Sasaki, secretary; Mitty Kimura, treasurer; and Cherry Yoshitomi, historian.

A constitution was also drawn up by the group.

# MEETINGS AT MESS HALLS LIMITED



## CHURCH SERVICES SUNDAY

Event	Time	Rec Hall
<b>BUDDHIST</b>		
Sunday school	9:00 a.m.	7G-12G
SS teachers' meeting	10:30 a.m.	7G-12G
Young People's meeting	2:00 p.m.	7G
<b>PROTESTANT</b>		
Sunrise prayer meeting	6:15 a.m.	10H
Sunday school	8:45 a.m.	8H
Japanese service	10:00 a.m.	7H-10H
English service	10:15 a.m.	8H
Young people's meeting	7:00 p.m.	9H

## CLEARANCES NECESSARY

The use of the mess halls as a meeting place has developed into a problem and the cooperation of the residents is asked by Project Director James G. Lindley.

Meetings should be limited and should be recorded by the police department after a clearance is received through the 7E recreation office, said Lindley.

Block managers and the recreation department are responsible for the schedules, the preparations, and for the clean up of all mess hall activities after Jan. 1, Lindley concluded.

## LINDLEY CHALLENGES ANONYMOUS WRITERS

Numerous charges made against various individuals, both evacuees and administrative members, in anonymously written letters have been received by Project Director James G. Lindley. Said Lindley: "Please

do not waste any more of my time, or yours, in writing anonymous letters. If you haven't enough courage to face the man that you are accusing, then I am not interested in your charges."

## EQUIPMENT FOR CENTER OBTAINED

David N. Katz, procurement officer, has returned from a trip to Fort Snelling where he looked at some government surplus property with Malcolm E. Pitts, WRA field administrative officer. Three carloads of equipment, including books, were obtained for use in this center.

## UNCLAIMED MAIL AT POST OFFICE

Letters addressed Franklin Radio Shop, Yosh's Barber Shop, and Oriental Seed and Plants may be claimed at the post office by their respective owners.

## Soldiers on Furlough

Nisei soldiers who visited in the center this week include:

Pfc. Richard Matsumoto, Pfc. Isaac Sasaki, Camp Wolters, Tex.; Pvt. Masao Yamaguchi, Ft. Bliss, Tex.; Sgt. David Yoshida, Camp Hale, Colo.; Pfc. Hiroshi Mitobe, Camp Crowder, Mo.; Sgt. Tadao Saito, Station Hospital, Camp Crowder, Mo.; Pvt. Sam Kuwata, Ft. Sam Houston, Tex.; Staff Sgt. Jack Obasni, Camp Savage, Minn.; Pvt. Carl K. Kawamoto, Pvt. Tadashi Hirose, Ft. Leavenworth, Kan.

## APPLICATIONS FORWARDED

Approximately 200 applications for sending household goods to this center have been forwarded to the San Francisco office, according to Henry F. Halliday, senior administrative officer.

## Mrs. T. Gima Returns Here

Mrs. Tanjiro Gima, 11K-4E, returned from Los Angeles this week with the ashes of her husband who passed away in the Los Angeles General hospital Dec. 21. Funeral services were held in Arcadia.

Mrs. Gima was accompanied by her daughter, Miyeko, and Mario Vecchio, placement officer.

## MORE GOODS AUGMENT DEPARTMENT STORE STOCK

A complete line of shoes is now carried by the clothing store, Rio Kashiwagi announced Tuesday. Late winter goods have arrived and are on sale.

The toy department will be moved to the variety store to better accommodate the customers. An open stock line of dishes is also being sold at the variety store, and it is hoped to carry the less expensive variety soon,

Kashiwagi stated.

The grocery store now carries a complete line of goods.

In answering the question of why some merchandise are sold for more and others for less, Kashiwagi said that it was due to the late buying. On the average, residents will find that the prices at the community enterprise stores are less in comparison to the outside.

## CARD CLASS SHIFT MADE

Bridge class changes have been announced by Roy Iizuka, instructor.

Classes are now held on Mondays, Wednesdays, and Fridays, 7 to 10 p.m. at the 11H recreation hall; Tuesdays, Thursdays, and Saturdays, 7 to 10 p.m. at the 7K recreation hall; and Sundays, 2 to 5 p.m. at the 7K recreation hall.

## Thumb Nail SKETCHES

"A teacher affects eternity; he can never tell where his influence stops."

Dr. Enoch Dumas, elementary school principal, is an advocate of this thought expressed by Henry Adams.

Ten years of close association with students in schools and colleges in Oregon, Washington, Colorado, and Kansas have acquainted him with the workings of the young mind.

A proponent of progressive education, Dr. Dumas does not strictly adhere to stereotyped teaching methods. He is sponsoring a course in which several subjects are studied and the relationships of one subject with another impressed upon the students through association.

Illustrative of his understanding is the story told in the education office concerning a little girl, who, when told by her mother that she was going in to see "Doctor" Dumas, burst into tears.

Instead of uniformed nurses and surgical instruments, she found neat office girls and row upon row of children's books. Dr. Dumas quickly won the child's confidence and sent her out anticipating her first day in school.

The man who is entrusted with the education of hundreds of youngsters in their formative years worked his way through college, at one time or another having been a logger, forester, department store clerk, librarian, lecturer, ambulance helper, and tutor.

Dr. Dumas is a '33 graduate of Willamette university in Oregon. He earned his MA in 1939 and Doctor of Education degree two years later from Colorado State College of Education.

## NO DANCE ON SATURDAY NIGHT

There will be no Saturday night dances until further notice as all the public address systems are being used for movies or scheduled to be used for talent shows, the recreation department announced Thursday.

## GRANADA PIONEER

Published Wednesdays and Saturdays by the WRA and distributed free to every apartment. Editorial office: PIONEER building, Amache, Colo. Phone: 63 Oski Taniwaki, director Bob Hirano, editor

Staff: Suyo Sako, Jiro Sumita, Khan Komai, Taxie Kusuruki, Jack Ito, Robert Asamoto, Tomoko Yatabe, Alice Taketa, Joseph Ide, Choji Nakano, Elmer Ioka, Hiromichi Morimoto, Tsugime Akaki, Jim Yamaguchi, Sab Okamura, George Hamamoto, Masaji Murai, John Tsuruta, Hiroshi Ito, Harry Ioka, Edith Kodama, June Taketa, Makoto Morita, Yutaka Kubota, Ernest Uno, Roy Hamaji.

## Faith in Journalism

We appreciate the straight thinking and understanding attitude of the editors of the Rocky Mountain News at a time when emotions rather than reason dictate the policies of many newspapers.

Their editorial about the Granada center's school project last Sunday demonstrates that they realize the problems which face the evacuees and the WRA administrators.

Before Pearl Harbor, we believed that American newspapers and newspapermen topped the world in accuracy and fairness. Since then, that thesis has been shaken. Only a few of the nation's great dailies, such as the News, help us to keep faith in American journalism.

## Letters TO THE EDITOR

TO THE EDITOR:

Some weeks ago, four or five coal haulers fell from the rear of a truck and were seriously injured. I understand that not all have recovered to this day.

What I want to know is,

why the PIONEER didn't carry the news about such a big accident?

A COAL HAULER

The hospital refused to give our reporter any information on the subject. --ed.



## RUSTLINGS

FROM OTHER CENTERS

ROHWER...

A clogged drainpipe plus 24 hours of rain created a flood in one part of the center.

More than 75 Boy Scouts took part in the center's first Court of Honor. Three life Scout awards were made.

A two-day rally started the YMWCA organization drive.

GILA...

Coins were hidden in mochi cakes and given to the children during the mochi maki.

Goose was the main dish on the New Year's day menu. HEART MOUNTAIN...

A modern bakery plant will be built to supply the center with bread and pastry.

Hog and cattle projects will be started and is expected to meet the meat needs of the residents.

Community enterprises is planning to build a recreation center to meet the increasing demands of the residents. Included will be an eight-alley bowling section, a soda fountain, a hamburger kitchen, booths, and tables, and three billiard tables.

The Sentinel had 16 pages in its special New Year's edition. TOPAZ...

A 32-year-old risei was found alive 10 miles from the center after a three-day search by the center residents.

POSTON...

The Chronicle is the new name of the center's publication.

Included in the New Year's celebration was a "Cavalcade of Poston," presenting panoramic scenes of center life.



# STUDENTS TO BE EXAMINED WRA ESTABLISHES NEW OFFICIAL STOREHOUSE

All students in Amache schools will be given the opportunity to have their hearing and eyesight tested beginning next week, the school's physical education department said today.

Carey Downing of the state education department will supervise the hearing tests with an audiometer. Miss Downing will stay at the Amache project for three days. After their hearing is tested, students will have their eyes examined.

According to Morris H. Soglow, physical education adviser, all students with defective hearing or sight will be afforded treatment at the center hospital.

## ROBERT GEORGE TO ADDRESS RWA

Robert George, junior high school instructor, will address RWA members, a discussion group of the YWCA, and their guests tomorrow at 3 p.m. at the 9K recreation hall. His topic will be "Attitudes."

A discussion is also planned and refreshments will be served.

Nippon hall at Sebastopol has been established as a receiving point for evacuee stored household goods, Henry F. Halliday, senior administrative officer, announced Friday.

A WRA representative from the San Francisco office will be at Sebastopol from Feb. 1 to 15 to receive the goods. Residents formerly of this vicinity who have not filed their applications are requested to do so now. They will be required to have goods

## GET-TOGETHER SET FOR MONDAY EVE

An informal get-together, featuring entertainment and community singing, will be held from 7 to 9 p.m. in Terry hall Monday.

Henry Suzukida will act as master of ceremonies for the program being sponsored by the recreation department; Joseph Ide, Koe Yoshida, Fred Arimoto, Frank Suzukida, Hippo Shibata, and Mits Usui will lead the singing; Chidori Shiotani will be vocalist, and Namiko Ota will provide accompaniment for the singing.

shipped to this point at their own expense.

Necessary packing or crating for rail shipment will be done by the WRA. Henry Shimizu is assisting in receiving the applications.

## BLUE TRIANGLE MEETS TODAY

An election of officers will take place when the Blue Triangle meets tomorrow at 1:30 p.m. at the 8F recreation hall. The president and the representative of each Girl Reserve club are asked to attend the meeting.

## RECORDS TO BE PLAYED TONIGHT

Both classical and popular music will be played tonight from 7 to 10:30 p.m. at the 12H mess hall, Terry Mae Murekami, chairman, stated Thursday.

## REV. SUZUKI TO DELIVER SERMON

Rev. Lester Suzuki will give a sermon at the Protestant church service at Terry hall tomorrow morning.

# CO-OPS: OF, BY, AND FOR YOU

## PATRONAGE DIVIDENDS ON PURCHASES

The fourth and last of the primary principles of consumer cooperation is without doubt the most powerful Rochdale rule. Simply stated, the principle is that net profits are paid back as patronage dividends to members and patrons in proportion to their purchases.

If applied consistently for a period of years, as in Denmark and Sweden, for example, this principle has the power to break monopolies, build consumer-owned factories, eliminate tenancy on farms, and prevent generally a vitiating governmental bureaucracy.

Let us use a very conservative example to show how the principle will work in our Amache cooperative enterprises, inc. The temporary local community enterprises, exclusive of mail order business, have done an average of \$20,000

gross business per month since September 1. This is an average expenditure of only \$12.50 per family per month for 1600 families.

Let us assume that this volume of business keeps up and \$240,000 gross is taken in for the year. Assume further that after paying rent, taxes, depreciation, 4% interest on all shares, and cash wages unfortunately below normal, a net profit of \$12,000 is shown for its first year of business.

Without patronage dividends and a co-op set-up this conservative amount would be pocketed as stock dividends by a few large stockholders.

In our co-op, however, this 5% net profit will be returned to the 1600 families in proportion to their part in the \$240,000 gross annual volume.

What will the results

of this policy be? First, there will be the beginning of more widespread savings and ownership which will supplement the low center wage level and provide protection against the inevitable subnormal post-war period.

Second, more interest and active participation in the economic and business life of the community will be developed.

Third, and most important, patronage dividends definitely tend to do away with centralization of economic power, the basic cause of present world-wide entanglements.

Here in this one principle, Amache citizens--or citizens anywhere--have an economic tool with which to build economic democracy to match our religious and political freedoms if they will but apply the principle consistently.--E.H. Runeson

**DOLLARS AND SENSE**

Queries as to who receives the money taken in at games played in the Granada high school gym have increased of late.

Interested in the question ourselves, we asked the recreation department about the matter. Happily we found that arrangements for dispersal of the gate receipts had been already made.

Center teams and the Granada town club are recognized as the home team on alternate games. The home team receives a fixed larger percentage of the gate receipts, while the visiting team gets the remainder.

A further stipulation requires the home team to pay the expenses of staging the game, the visiting team taking a smaller but clear out.

In the long run, therefore, with the alternating policy and paying of expenses, both teams come out financially even.

**OF DIRT AND HOPE**

Two hundred high school boys find themselves once more taking part in basketball as Anaheim high raises the curtain on its 1943 season with an intramural program.

Used to playing on polished floors where quick stops and pivots and smooth dribbling are possible, the boys are having trouble in adapting their style of play to dirt courts.

In 10 games played so far, the biggest score we have noticed is a 14-4 count. No point could better illustrate the playing limitations of the dirt court.

We join the boys in looking forward to completion of the high school gym when indoor sports will no longer be handicapped.

**GOOD SPORTS**

Yuk Yawata, high school physical education instructor, is a football, basketball, and tennis letterman from Oakland's University high.

After graduation, he

**CAGE SIGN UP STARTS**

Managers wishing to enter a team in one of the basketball leagues are asked to sign up at the 7E recreation hall by Wednesday.

A team of at least five must be signed up at the recreation office by that date to enter in the leagues.

The team sign-up will be followed by an important managers' meeting to be held at the 7E recreation hall Thursday at 7 p.m.

The meeting will be held to discuss the rules and regulations drawn up by the basketball board of directors.

Game schedules will also be formed. All managers are asked to be present at the meeting.

**GIRLS' SPORTS SUGGESTED**

Girls out of school who are interested in forming a basketball or volleyball league are requested to sign up now at the 7E recreation office so that arrangements can be made for such a league.

A formation of mess hall girls' teams was suggested by Miyoko Hayashi, girls' athletic director.

**Ice-Skating Rink Planned**

An ice-skating rink will be constructed west of Block 7E as soon as grading equipment arrives, according to the recreation department. Approximately 70 pairs of ice skates are now on sale at the community store.

enrolled in San Mateo JC, where he earned a berth on the varsity tennis team playing singles.

At Santa Anita, he was a member of the Frisco Fogs, "A" league cage champs.

**PREP GIRLS PLAN LEAGUE**

A school-wide intramural basketball program is about to get underway for high school girls. Entrants are girls who recently have been learning the fundamentals of the game.

Josephine Korsoski and Martha Tsuchiya, physical education instructors, will be in charge of the program.

Meanwhile the girls, who played the Granada high school girls at the Granada high gym recently, are looking forward to other outside activities.

Volleyball and goal-hi are the chief girls' sports activities at the junior high school where Fred Mahoney is aided by Sachiko Sakakura, who replaced Mayme Kishi as assistant instructor. Miss Kishi is expected to leave for school late this month.

**JUDO MEN IN PRACTICE**

More than 50 judo enthusiasts are working out four times a week at the 8E judo hall, according to Instructor Takaharu Kawashima, who is aided by 17 assistants.

Belts to signify the various classifications will be issued to the judoists in the near future, said Kawashima. A plan is also underway to start judo classes as a part of the high school education program.

Judo practices are held at the 8E hall on Mondays, Wednesdays, and Fridays from 6:30 to 8:30 p.m. and on Saturdays from 2 to 4 p.m.

**PRACTICE HOOP COURTS RESERVED**

The basketball courts at the 9G playground will be reserved for practice games only, announces the recreation department.

Permits for their use will be granted upon request at the 7E recreation office.

# LIL' NEEBO (LITTLE NISEI BOY)

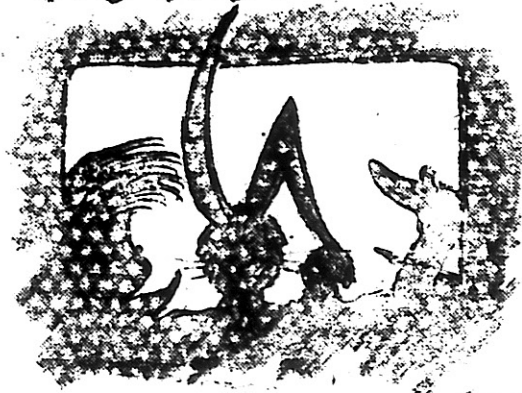

Jan. 2, 1995

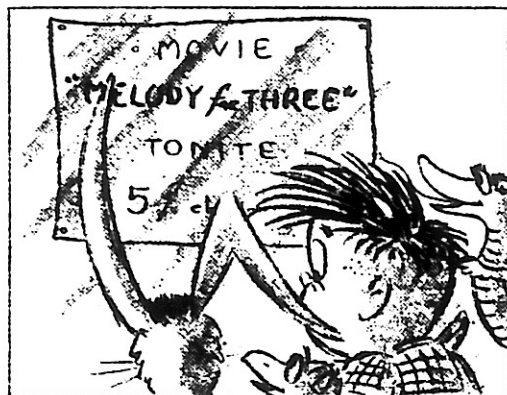

THANKS TO RUISSA YAMADA

## 治療に関する重要事項

### 1. 治療所入口

入口は病舎北側の入口を使用する事  
通路は一般民衆の使用するものに非ず  
(図面参照)

### 2. 特別治療

午前九時半より午前十一時半迄の治療は  
特別治療時間とし下記の如く診察に當てらる

月曜日	—	梅毒
火曜日	—	肺病
水曜日	—	健康幼児
木曜日	—	婦人病
金曜日	—	妊婦

註 水曜日健康児とあるは何の病氣もない  
幼児の事であつて病児の場合普通  
治療所に行く事

### 3. 普通治療

毎日午後二時四十五分より。(日曜日を除く)  
土曜日午前九時半より拾一時半迄

### 4. 受付

病人にして普通治療又は特別治療希望者は  
医師の診察を受ける前に「受付」で登録を要す

### 5. 治療時間絶対厳守

- ① 上記治療時間以外の治療は絶対的應急の場合に限るものとす
- ② 就働者にして治療を欲する者は自個の健康を第一とし仕事を休み診察を乞ふ事
- ③ 小数の医師は献身的に制定時間以上勤務して居るのであるから一般居住民は協調せし治療時間を厳守する事



# WRA 病院案内図

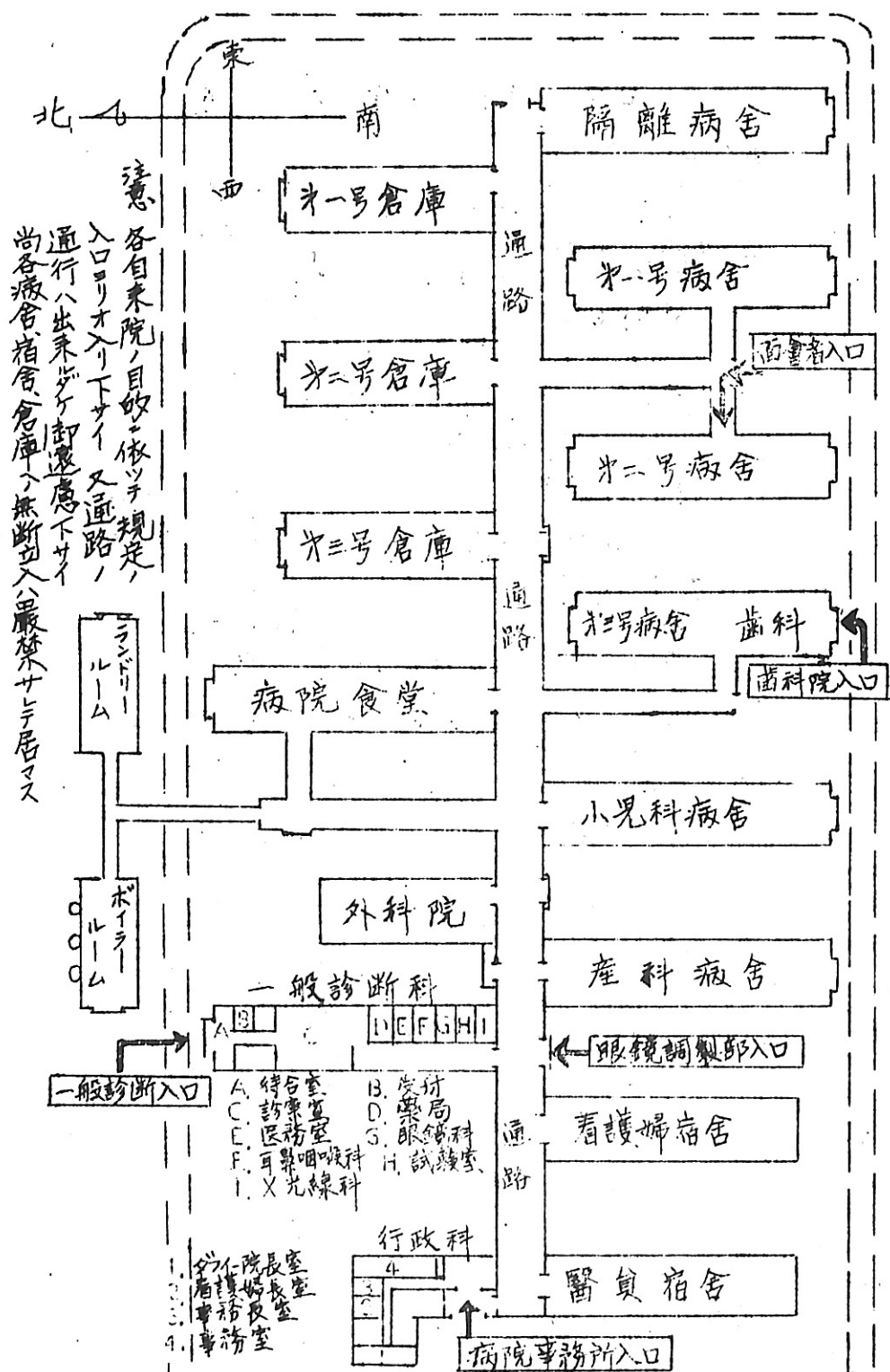

コ案内圖ハ各自保存シテ来院ノ節一應御一見ヲ願ヒマス

八百三丁



共同消費組合の解説

既に於ては、タリにも共同消費組合設立の機運あり。持所有者の境遇に最も適合する商業組織であることは否めない。以下所謂共同消費組合の一般的解説を試みて見よう。消費組合の根本は究極するところ消費有自身の利益福利を擁護するのために小賣卸賣又は其の他の資源の共有をほかるものである。而して經營方針にしても、資本の募集にせよ、この指導精神と基礎にして運用せざる可きである。事は周知の通り、幹とするものがあつて、一個人で大量の株を專有し、利益の分配を要求するが如きことは許容されない。常例集会に於いても投票權は株券の所有數に拘限されることなると一人一票の割にして總べて萬機公論に従ふものである。販賣方面にしても顧客を主意にしてサービス品質の選擇均等の正確等と云ふ点に留意されし可きである。利益を追究する個人事業と決して同一視して運用される可きものではない。第一には消費利益を主と見るけれども又適宜に資本に對する配當をなすと云ふのが其の設立基礎である。現に於ける一般ビジネスは企業家への報酬資本に對する利益率に經營上の消費の点が重視されてゐるが消費組合に於けるには利益率は經營上の消費の点が重視されてゐる。

學校建築問題

社  
 通船東少ラナクセンタ  
 一、卒成建築問題に對し  
 て大々的に報道讃議し  
 てゐたロツギーマラン  
 ソンニム、ス紙は今日左の如  
 同情あり社説を掲載し、廣  
 民主の義政体にあつては教  
 育は最も重要な役割となす  
 るが、特に貧乏の居住を劃  
 した故郷工役に移住した  
 一千八百餘名の日系市民に  
 對して施設をなす教育を繼  
 續せしむること、始終規  
 され、居り、頗る学校建築は  
 洗滌するることなく、進行せ  
 る可きである。  
 三十万八千井に達する建築  
 費、一面材料に對するイン  
 フレーションの結果であつ  
 て何等 W. R. A. に其の責任が  
 あると云ふ意味ではない。  
 費用の点に關しては其の筋  
 より充分調査をす、可き  
 てあらと

● 獅子身中の虫

近頃セクター内のサイドウラ  
ルク工事中の従業員に対して  
窓口を浴びせてたる傾向が段  
々と増加してゐる様で、あるが非  
常に遺憾に思ふものがある  
一般周知の如く従業員は給料  
の目的で労働してゐるわけでは  
ない、彼等は皆社会的精神を持  
つて、幾かでもセクターの美化  
を圖り又生活の明朗化するべく  
に上へ最も大膽なる良き行動  
であると思ふ。その善良なる  
従業員に対して窓口するが如  
き不心得者は所謂「獅子身中  
虫」の類であつて人道上徹ち下  
級に屬する者である。工事中の  
サイドウラークは今後と謂へば  
多数の人員を要するは勿論、寧  
ろ此の際居住民の協力を乞ふ  
わづらう。L.G. テンブル

民族の体面を保て

天の榮光と輝へたクリスマスも去り、新年も来た。青空高く  
澄しふいアーカンソー平原にある、グラナダの轉住所は寒か  
うず平拓の境地にまだ寝つてゐる……拙なりこの境地に渡  
る呼ぶ者は……この頃所長リンドレー氏に宛セシター職  
員の或る者及び居任氏の個人を中傷し密告する手紙が急に  
増へた。同胞移住者に理解を拂つて居り紳士であるリンドレ  
ー所長も狐に遠慮に想ひ不心得者に対して左の如く嚴重なる  
注意を喚起した。〔今後職員又は個人に対して意志を發表した  
い者は斯る卑怯な事をせず正々堂々と余の事務所に來て本  
人と対立の上で述べられたい。若し斯る勇氣を持たない者  
は以後絶体に他王中傷する様な事は慎んで貰ひ度い。互に  
に時間とエナジーを節約することに努むる。〕

(4)





# 断片

雪の日  
人跡きれた  
砂原の片隅で  
我が股指をきく

うきことに争ふ  
捨世の人生  
清らかな鼓界に  
求めねばならぬ  
意識の鼓を悔ゆ

赤道を燃やし  
涙を流して  
北極を凍らすのに  
北は「未来」の  
成就である

こんもりと鳥のたつ集や冬水立  
こぼれ水こぼりて宿す冬の月  
元日の空に高鳴るメスの鐘  
冬水立枯葉点々若くあり  
東雲をついて輝く初日の出  
冬水立鳥の古葉の下りなし

## 新作

唐澤文夫  
紙條網の外はサボテン  
の丘で夕陽が射してなる  
見馴れたキヤンデラ雪景  
となり並水のつら

波渡小は  
故郷の土  
土も潤る  
古里の土  
顔も潤る  
故郷の山川  
波も北へ  
流る北の消息  
あゝ、いそいそ  
故郷の空  
その白の頂  
一箇の校庭

ゴロラドの高原に現る初日の出  
元旦に餅さへ足りて収容所  
収容所雑煮五粒の猛者あり  
炊これし取樹の詩の泉の鼓  
主客共に暖爐にコイル掛け入る  
爐は話罵府の思ひ出で次々に

原後妻今日を歩みぬ爐辺りまで  
新年や黙然として爐に水あり  
元日の風呂の火を焚く音あり  
かひは居天井はしる像が鳥  
旅の春巻に今年の恵みあり  
新年も年を迎へて我二十文

収容所汚れし氷柱東りにナリ  
みじり兒の眼水しサタタタ大鼓  
聖樹下に入らんと知らぬ子葉  
女の病むセンター遠し界蒼蒼  
霜の夜やバケツにコイル拾ふ音  
矢崎紫簾子

## 詠草

小春日の  
陽光うれし道ながら  
音に見向けに  
鈴ふる意地

半生の夢語り合ふ暖爐炭  
ストーブに強り返へし詩を子へ使り  
句想疎る鼓と風邪の床の中  
村止 持子  
元旦に一人見えり熱柿願  
グラナダの元旦永久に記念せん  
元朝の曠野くまなく晴れにナリ

初舞台皆んなの顔の朗かに  
持むやコ、グラナダの初日の出  
風邪押して細刀流の剣舞哉  
白水の床の闇ありの餅の花  
風邪引きの前口上やマイナナ  
食堂の持ち寄り藝や術元日

灰坂の賀状も今春は絶へにナリ  
グラナダの雪の原より初日の出  
新春の家族は四散せしまに  
お餅とも違ひて配所の正月月  
元日に餅掲げてる一燕あり  
昨日萬幸すみて演藝またへ

## 定期會合

次回の題…… 詠  
正 月 二十日  
川柳論 文 藝 会 議 後 六 時 半  
文 藝 作 品 の 提 稿 は 松 井  
秋 水 氏 宛 に ……

鐵道鼓シガリ線ゆらし悠然と  
暖爐や三女雄辯に語り出し  
松 風

此處へ来て思ひにナリ祖意様と  
幾山河越えて曠野の初日の出  
原 谷 貞 子

岩田氏は氏は岩田氏であること  
訂正す。

文藝作品の投稿は松井  
秋水氏宛に……

○ グリナグ文藝人協会が教育局の分業として出て来たものが既に一月餘りたつた。前米在留同胞諸氏の文藝作品を本紙にも発表して見ると、種々たるが、それの本格的になつて来た。

○ 米本紙の支事、谷脇、朝不亭氏、御厚意に感謝する。今日の我々の文藝作品は、既に成人に限らず初心者にもつと進歩の付く。同行者並に、初心者には、御指導下さる。終りに筆を添へたいことは、文藝作品の投稿者は必ず各句會に出席して批評をお受け下さい。 秋 水

○ 園芸盛ん  
新年以来メンター墓の間に、は彼方此方に盛んに遊ばれてゐるが、Fリクレーションホールに於ては、小林、井、邦氏、幹旋の許に園芸大会の催され、毎日六十餘名の出席者あり、頗る盛會と云われてゐる。

○ 新課目講習開始  
今週五、六日の二日、新にフロア・シエーの講習が開始される。これにまつた、で講習希望者は、多数出席する様當局は希望してゐる。

今日五、六日の二日、新にフロア・シエーの講習が開始される。これにまつた、で講習希望者は、多数出席する様當局は希望してゐる。

因に會場、時日は左記の如くである。

月曜 午後七時より九時迄  
金曜 午後七時より九時迄  
水曜 午後七時より九時迄  
木曜 午後七時より九時迄  
火曜 午後七時より九時迄  
12日 食 堂



主婦夫人  
秘書入用

今日左の如き美人要求が美術部より来た。先に該部なる美人は早速申込み度し。

一、美人の事、由縁堂の事、一、二十代、事、愛嬌、つぶり、一、身長五呎、一、髪、一、体、百五十、下、位、(度、下、り、あ、り)

一、身長五呎、一、髪、一、体、百五十、下、位、(度、下、り、あ、り)

○ セライ來訪の二世兵士  
エリタナ州、レナード、ウッド、兵營、  
ワ、イ、ミ、ン、グ、ワ、イ、ン、兵營、  
チ、キ、サ、ス、州、オ、ール、兵營、  
ウ、イ、ス、コン、シン、州、マ、ワ、ン、兵營、  
コ、ロ、ラ、ド、カ、ン、ソ、ン、兵營、  
ミ、ン、グ、ン、カ、ス、ク、兵營、  
藤、森、ウ、イ、ア、ム、兵營、  
夫、る、金、曜、日、も、E、リ、ク、レ、シ、ョ、ン、ホ、ール、に、於、て、慰、安、接、待、し、る、が、果、會、者、四、名、徳、永、愛、子、嬢、の、轉、族、に、て、張、る、盛、大、な、た、り、  
渡、辺、ノ、リ、嬢、並、に、森、田、ハ、子、嬢、指、揮、下、に、  
於、第、一、併、教、會、堂、  
毎、週、火、曜、日、午、後、六、時、半、より、七、時、半、迄、

上、曜、日、午、後、七、時、半、より、七、時、半、迄、  
日、曜、日、佛、教、礼、拜、後、  
於、第、二、併、教、會、堂、  
今、日、こ、ろ、毎、週、日、曜、日、午、前、七、時、半、より、午、後、七、時、半、迄、

佛、教、聖、  
上、曜、日、午、後、七、時、半、より、七、時、半、迄、  
日、曜、日、佛、教、礼、拜、後、  
於、第、二、併、教、會、堂、  
今、日、こ、ろ、毎、週、日、曜、日、午、前、七、時、半、より、午、後、七、時、半、迄、

佛、教、聖、  
上、曜、日、午、後、七、時、半、より、七、時、半、迄、  
日、曜、日、佛、教、礼、拜、後、  
於、第、二、併、教、會、堂、  
今、日、こ、ろ、毎、週、日、曜、日、午、前、七、時、半、より、午、後、七、時、半、迄、

佛、教、聖、  
上、曜、日、午、後、七、時、半、より、七、時、半、迄、  
日、曜、日、佛、教、礼、拜、後、  
於、第、二、併、教、會、堂、  
今、日、こ、ろ、毎、週、日、曜、日、午、前、七、時、半、より、午、後、七、時、半、迄、

佛、教、聖、  
上、曜、日、午、後、七、時、半、より、七、時、半、迄、  
日、曜、日、佛、教、礼、拜、後、  
於、第、二、併、教、會、堂、  
今、日、こ、ろ、毎、週、日、曜、日、午、前、七、時、半、より、午、後、七、時、半、迄、

佛、教、聖、  
上、曜、日、午、後、七、時、半、より、七、時、半、迄、  
日、曜、日、佛、教、礼、拜、後、  
於、第、二、併、教、會、堂、  
今、日、こ、ろ、毎、週、日、曜、日、午、前、七、時、半、より、午、後、七、時、半、迄、

佛、教、聖、  
上、曜、日、午、後、七、時、半、より、七、時、半、迄、  
日、曜、日、佛、教、礼、拜、後、  
於、第、二、併、教、會、堂、  
今、日、こ、ろ、毎、週、日、曜、日、午、前、七、時、半、より、午、後、七、時、半、迄、

佛、教、聖、  
上、曜、日、午、後、七、時、半、より、七、時、半、迄、  
日、曜、日、佛、教、礼、拜、後、  
於、第、二、併、教、會、堂、  
今、日、こ、ろ、毎、週、日、曜、日、午、前、七、時、半、より、午、後、七、時、半、迄、

佛、教、聖、  
上、曜、日、午、後、七、時、半、より、七、時、半、迄、  
日、曜、日、佛、教、礼、拜、後、  
於、第、二、併、教、會、堂、  
今、日、こ、ろ、毎、週、日、曜、日、午、前、七、時、半、より、午、後、七、時、半、迄、

佛、教、聖、  
上、曜、日、午、後、七、時、半、より、七、時、半、迄、  
日、曜、日、佛、教、礼、拜、後、  
於、第、二、併、教、會、堂、  
今、日、こ、ろ、毎、週、日、曜、日、午、前、七、時、半、より、午、後、七、時、半、迄、

佛、教、聖、  
上、曜、日、午、後、七、時、半、より、七、時、半、迄、  
日、曜、日、佛、教、礼、拜、後、  
於、第、二、併、教、會、堂、  
今、日、こ、ろ、毎、週、日、曜、日、午、前、七、時、半、より、午、後、七、時、半、迄、

佛、教、聖、  
上、曜、日、午、後、七、時、半、より、七、時、半、迄、  
日、曜、日、佛、教、礼、拜、後、  
於、第、二、併、教、會、堂、  
今、日、こ、ろ、毎、週、日、曜、日、午、前、七、時、半、より、午、後、七、時、半、迄、

佛、教、聖、  
上、曜、日、午、後、七、時、半、より、七、時、半、迄、  
日、曜、日、佛、教、礼、拜、後、  
於、第、二、併、教、會、堂、  
今、日、こ、ろ、毎、週、日、曜、日、午、前、七、時、半、より、午、後、七、時、半、迄、

佛、教、聖、  
上、曜、日、午、後、七、時、半、より、七、時、半、迄、  
日、曜、日、佛、教、礼、拜、後、  
於、第、二、併、教、會、堂、  
今、日、こ、ろ、毎、週、日、曜、日、午、前、七、時、半、より、午、後、七、時、半、迄、

佛、教、聖、  
上、曜、日、午、後、七、時、半、より、七、時、半、迄、  
日、曜、日、佛、教、礼、拜、後、  
於、第、二、併、教、會、堂、  
今、日、こ、ろ、毎、週、日、曜、日、午、前、七、時、半、より、午、後、七、時、半、迄、

羅、府、メ、リ、ノ、ール、神、父、  
元、教、會、員、と、尋、ね、  
羅、府、メ、リ、ノ、ール、教、會、神、父、は、  
今、四、九、の、如、き、文、面、を、當、局、宛、に、  
寄、越、し、た、  
元、羅、府、メ、リ、ノ、ール、教、會、員、全、  
部、の、位、所、姓、名、を、至、急、知、り、度、  
し、御、援、助、を、乞、ふ、  
教、會、員、は、早、速、日、G、も、日、の、山、口、  
氏、か、も、E、S、E、の、松、川、則、夫、氏、迄、  
通、知、あ、り、度、し、と、

羅、府、メ、リ、ノ、ール、神、父、  
元、教、會、員、と、尋、ね、  
羅、府、メ、リ、ノ、ール、教、會、神、父、は、  
今、四、九、の、如、き、文、面、を、當、局、宛、に、  
寄、越、し、た、  
元、羅、府、メ、リ、ノ、ール、教、會、員、全、  
部、の、位、所、姓、名、を、至、急、知、り、度、  
し、御、援、助、を、乞、ふ、  
教、會、員、は、早、速、日、G、も、日、の、山、口、  
氏、か、も、E、S、E、の、松、川、則、夫、氏、迄、  
通、知、あ、り、度、し、と、

羅、府、メ、リ、ノ、ール、神、父、  
元、教、會、員、と、尋、ね、  
羅、府、メ、リ、ノ、ール、教、會、神、父、は、  
今、四、九、の、如、き、文、面、を、當、局、宛、に、  
寄、越、し、た、  
元、羅、府、メ、リ、ノ、ール、教、會、員、全、  
部、の、位、所、姓、名、を、至、急、知、り、度、  
し、御、援、助、を、乞、ふ、  
教、會、員、は、早、速、日、G、も、日、の、山、口、  
氏、か、も、E、S、E、の、松、川、則、夫、氏、迄、  
通、知、あ、り、度、し、と、

羅、府、メ、リ、ノ、ール、神、父、  
元、教、會、員、と、尋、ね、  
羅、府、メ、リ、ノ、ール、教、會、神、父、は、  
今、四、九、の、如、き、文、面、を、當、局、宛、に、  
寄、越、し、た、  
元、羅、府、メ、リ、ノ、ール、教、會、員、全、  
部、の、位、所、姓、名、を、至、急、知、り、度、  
し、御、援、助、を、乞、ふ、  
教、會、員、は、早、速、日、G、も、日、の、山、口、  
氏、か、も、E、S、E、の、松、川、則、夫、氏、迄、  
通、知、あ、り、度、し、と、

羅、府、メ、リ、ノ、ール、神、父、  
元、教、會、員、と、尋、ね、  
羅、府、メ、リ、ノ、ール、教、會、神、父、は、  
今、四、九、の、如、き、文、面、を、當、局、宛、に、  
寄、越、し、た、  
元、羅、府、メ、リ、ノ、ール、教、會、員、全、  
部、の、位、所、姓、名、を、至、急、知、り、度、  
し、御、援、助、を、乞、ふ、  
教、會、員、は、早、速、日、G、も、日、の、山、口、  
氏、か、も、E、S、E、の、松、川、則、夫、氏、迄、  
通、知、あ、り、度、し、と、

羅、府、メ、リ、ノ、ール、神、父、  
元、教、會、員、と、尋、ね、  
羅、府、メ、リ、ノ、ール、教、會、神、父、は、  
今、四、九、の、如、き、文、面、を、當、局、宛、に、  
寄、越、し、た、  
元、羅、府、メ、リ、ノ、ール、教、會、員、全、  
部、の、位、所、姓、名、を、至、急、知、り、度、  
し、御、援、助、を、乞、ふ、  
教、會、員、は、早、速、日、G、も、日、の、山、口、  
氏、か、も、E、S、E、の、松、川、則、夫、氏、迄、  
通、知、あ、り、度、し、と、

羅、府、メ、リ、ノ、ール、神、父、  
元、教、會、員、と、尋、ね、  
羅、府、メ、リ、ノ、ール、教、會、神、父、は、  
今、四、九、の、如、き、文、面、を、當、局、宛、に、  
寄、越、し、た、  
元、羅、府、メ、リ、ノ、ール、教、會、員、全、  
部、の、位、所、姓、名、を、至、急、知、り、度、  
し、御、援、助、を、乞、ふ、  
教、會、員、は、早、速、日、G、も、日、の、山、口、  
氏、か、も、E、S、E、の、松、川、則、夫、氏、迄、  
通、知、あ、り、度、し、と、

羅、府、メ、リ、ノ、ール、神、父、  
元、教、會、員、と、尋、ね、  
羅、府、メ、リ、ノ、ール、教、會、神、父、は、  
今、四、九、の、如、き、文、面、を、當、局、宛、に、  
寄、越、し、た、  
元、羅、府、メ、リ、ノ、ール、教、會、員、全、  
部、の、位、所、姓、名、を、至、急、知、り、度、  
し、御、援、助、を、乞、ふ、  
教、會、員、は、早、速、日、G、も、日、の、山、口、  
氏、か、も、E、S、E、の、松、川、則、夫、氏、迄、  
通、知、あ、り、度、し、と、

KEY TO TRANSLATION

- |                          |                        |
|--------------------------|------------------------|
| 1. Community enterprises | 15. Handicraft         |
| 2. School construction   | 16. School banks       |
| 3. Letter from G. Temple | 17. Literary column    |
| 4. Warning               | 19. Literary editorial |
| 5. Baggage               | 20. Ego                |
| 6. Cash found            | 21. New class          |
| 7. Police party          | 22. Secretary wanted   |
| 8. Translation taught    | 23. Soldier visitors   |
| 9. Mess hall meeting     | 24. Choir              |
| 10. Library              | 25. Buddhist           |
| 11. College students     | 26. Church services    |
| 12. Art school           | 27. Seicho no Iye      |
| 13. Colorado Fuel Co.    | 28. Maryknoll fathers  |
| 14. Regional WRA         |                        |