



ThermoSoft®
INTERNATIONAL CORPORATION

End Seal Kit Instructions

End Seal Kit Installation



DESCRIPTION

ThermoSoft's Power Connection Kit is for use with NeverFreeze® self-regulating cable for roofs and gutters. The kit contains items used to terminate a cable run. Please consult the installation guides for the NeverFreeze® Power Connection Kit, Roof Clip, and Cable for more information.

CONTENTS

A – Black shrink tube (3/4"x5")

B – Woven braid sleeve (1/2"x4")

C – Black shrink cap (1/2"x1 1/4")

WARNING

- **ELECTRIC SHOCK HAZARD**
- Before installing or servicing heating cable or accessories, disconnect all power.
- Heating cable must be grounded in accordance to National Electric or local codes. Failure to comply can result in damage or injury.
- A qualified electrician must perform any service or installation to heating cable and accessories.
- Keep all components and ends dry before and during installation.

TOOLS NEEDED

- Heat Gun
- Measuring Tape
- Needle-Nose Pliers
- Wire Cutter
- Utility Knife

Step 1: Carefully score the outer jacket 2" from the end of the cable. Remove the outer jacket so the braid is exposed. BE CAREFUL NOT TO DAMAGE THE BRAID OR CABLE.

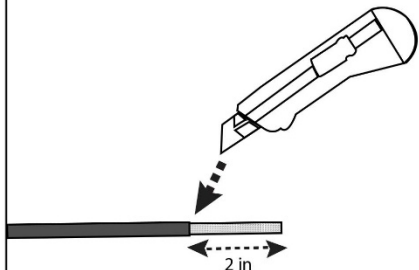

Step 2: Push back the braid to expose the cable. Cut off the end 3/4" of the cable. To prevent short circuits, do not connect bus wires. Keep braid away from shrink cap. **WARNING: ELECTRIC SHOCK HAZARD**



Step 3: Slide the heat shrink cap (C) over the end of the heating cable. Use a heat gun to heat evenly until it shrinks around the cable.

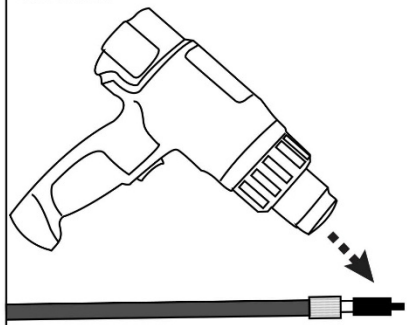

Step 4: Pull up the braid over the end cap and twist end together.



Step 5: Slide the woven sleeve (B) over the end of the cable. Let 1/2" go past the cable.



Step 6: Slide the shrink tube (A) over the woven braid. Let 1/2" go past each end of the woven sleeve.



Step 7: Use heat gun to evenly apply heat to the shrink tube (A) until it shrinks around the cable.

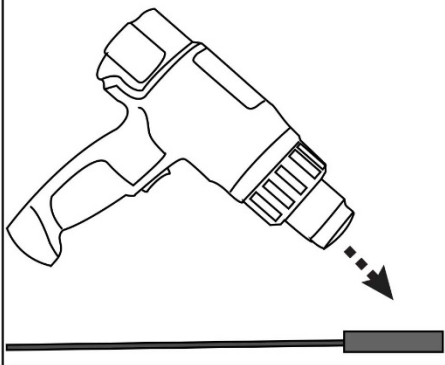

Step 8: Use pliers to clamp down gently on the heated area while still hot. Keep clamped until cool and completely sealed. If end is not sealed, repeat heating and clamp again.

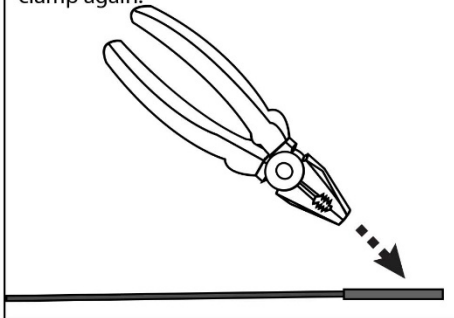

The end product should look like the figure shown.

